

**Argyle House
Richmond
TW9 2JN**

£1,895

ChaseBuchanan



SECOND FLOOR
461 sq.ft. (42.8 sq.m.) approx.

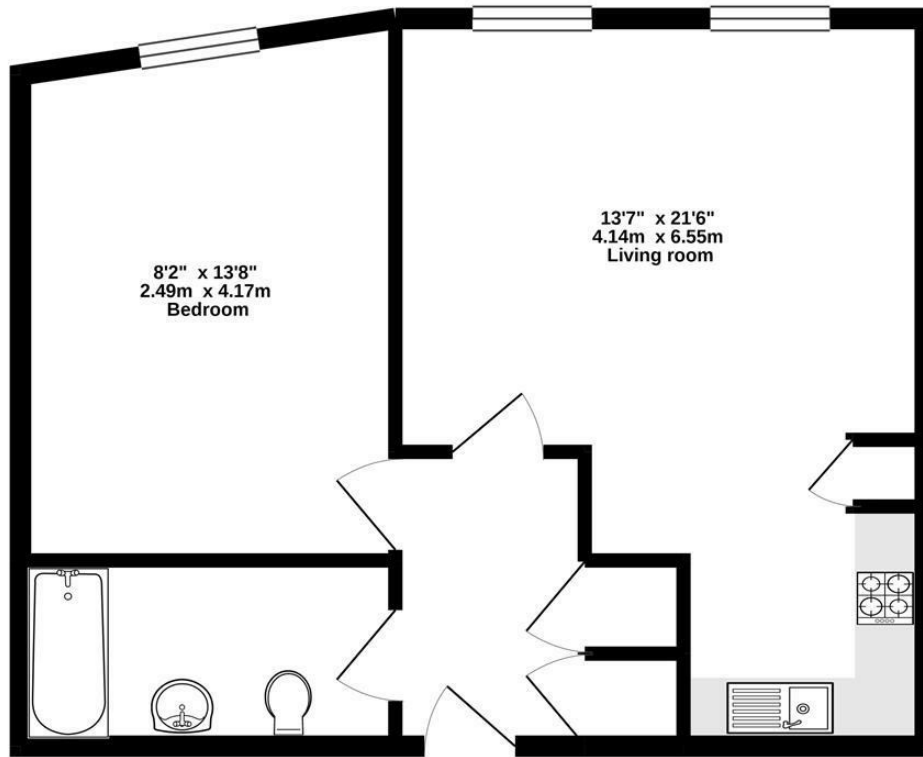

TOTAL FLOOR AREA : 461 sq.ft. (42.8 sq.m.) approx.

Whilst every attempt has been made to ensure the accuracy of the floorplan contained here, measurements of doors, windows, rooms and any other items are approximate and no responsibility is taken for any error, omission or mis-statement. This plan is for illustrative purposes only and should be used as such by any prospective purchaser. The services, systems and appliances shown have not been tested and no guarantee as to their operability or efficiency can be given.
Made with Metropix ©2020

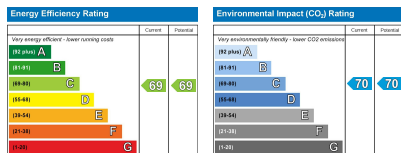

- Viewings accompanied by Chase Buchanan
- Furnished apartment
- EPC C
- One bedroom
- Modern finish
- short walk to both North Sheen and Richmond station

Introducing this spacious and stylish one-bedroom apartment, nestled within a recently converted development on Dee Road, Richmond.

Meticulously finished to an exceptional standard, this property offers a luxurious living experience. Boasting one double bedroom, a generously sized bathroom, and an inviting open-plan living/kitchen area, it exudes both comfort and elegance.

Benefitting from underfloor heating throughout and adorned with large windows, the apartment is flooded with natural light, creating a bright and welcoming atmosphere.

Dee Road is located in a tranquil residential area of Richmond, offering residents a peaceful retreat from the city bustle while maintaining excellent connectivity. A short stroll leads to both North Sheen and Richmond stations, providing convenient access to London via overground and underground links. Moreover, its proximity to the M3 and M25 via the A316 ensures easy commuting for drivers.

With its combination of sophisticated interiors, prime location, and superb transport links, this apartment on Dee Road presents an unparalleled opportunity for modern living. Don't miss out – arrange a viewing today to secure your new home in Richmond's vibrant community.

Chase Buchanan are bonded members of ARLA PropertyMark.

For more information or to book a viewing, please contact:

020 8948 1331

ChaseBuchanan

20 Red Lion Street, Richmond, TW9 1RW