

**Sheen Court
Richmond
TW10 5DF**

£1,895 PCM

ChaseBuchanan



GROUND FLOOR
594 sq.ft. (55.2 sq.m.) approx.

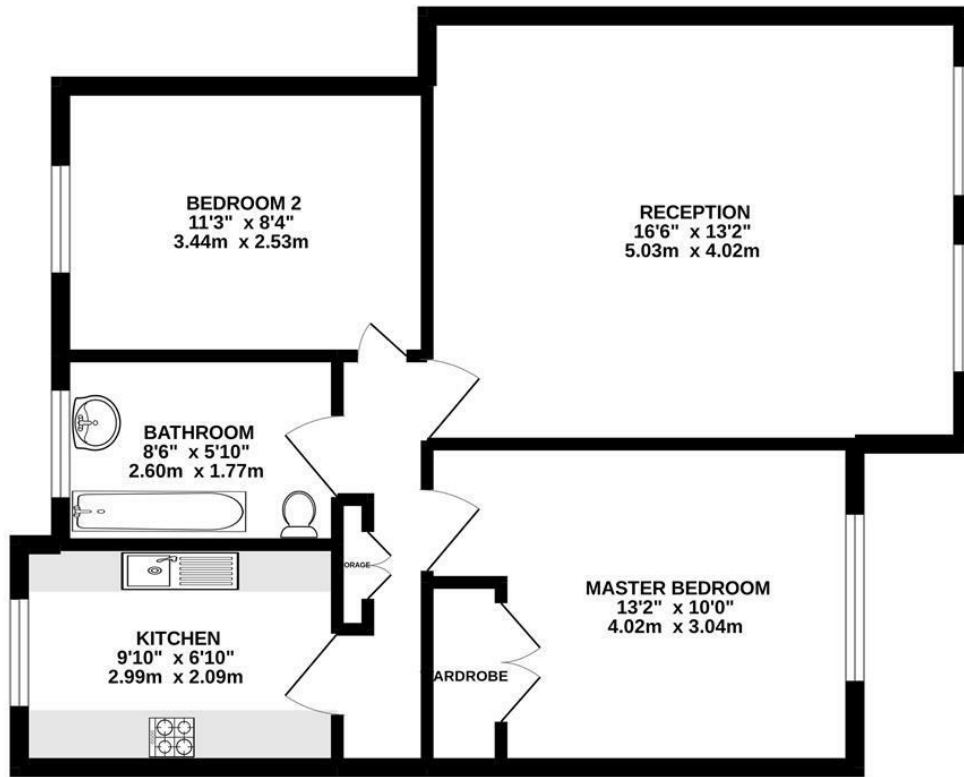

TOTAL FLOOR AREA : 594 sq.ft. (55.2 sq.m.) approx.
Produced solely for Chase Buchanan
Made with MetroPix ©2022

Energy Efficiency Rating		Environmental Impact (CO ₂) Rating	
Current	Desired	Current	Desired
Very energy efficient - lower running costs		Very environmentally friendly - lower CO ₂ emissions	
A		A	
B		B	
C		C	
D		D	
E		E	
F		F	
G		G	
52	56		

- Viewings accompanied by Chase Buchanan
- highly desired development
- Ground floor
- Off street parking
- EPC E
- Council tax band D

Introducing an exceptional ground floor apartment situated within the prestigious "art deco" private estate of Sheen Court, conveniently located near transport connections and Richmond town center. This delightful flat boasts a spacious reception room, a generously-sized master bedroom complete with fitted wardrobes, an additional double bedroom, a fully equipped kitchen, and a nicely proportioned bathroom. Sheen Court is renowned for its excellent management and provides residents with the added convenience of off-street parking facilities.

Chase Buchanan are bonded members of ARLA Property mark.

For more information or to book a viewing, please contact:

020 8948 1331

ChaseBuchanan

20 Red Lion Street, Richmond, TW9 1RW