



20 The Meadows, Red Lumb

Norden | OL12 7TX



20 The Meadows, Red Lumb

Norden | OL12 7TX



Overview

- Fully Refurbished
- First Floor Apartment
- One Double Bedroom
- Contemporary Living

Accommodation

- Fitted Kitchen With Appliances
- Modern Three-Piece Bathroom
- Semi-Rural Location
- Panoramic Countryside Views
- Allocated & Visitor Parking
- No Expense Spared
- Communal Lawns



One Bedroom First Floor Apartment In A Semi-Rural Location

This immaculate first floor apartment is situated in a highly sought-after semi-rural location with delightful countryside views affording unrivalled views of the beautiful open countryside yet with easy access to Norden village, excellent local schools and transport links.



Internally, the apartment has been fully refurbished with no expense spared and living accommodation comprising of an entrance vestibule & hall, open plan lounge and kitchen with integrated appliances, one double bedroom and a modern bathroom. The property benefits from having a modern electric heating system with underfloor heating in both windowsills controlled by the HIVE system and hardwood double glazing.



Externally, there is allocated parking plus ample visitor parking, open aspect views to all sides, communal lawns and automatic entrance gates. The property is only a short walk from Greenbooth Reservoir and other surround countryside walks.

First Floor

Approx. 47.3 sq. metres (509.2 sq. feet)

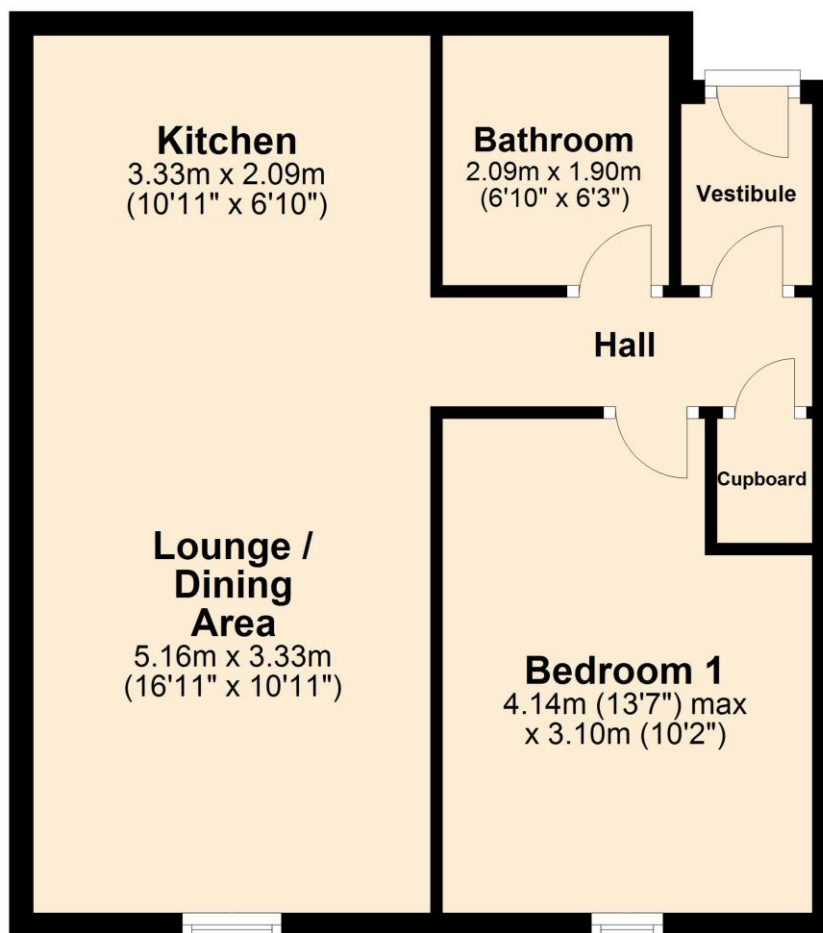

Total area: approx. 47.3 sq. metres (509.2 sq. feet)

4 Smith Street, Rochdale
Lancashire, OL16 1TU

Tel: 01706 356633

Email: enquiries@reside.agency

www.reside.agency

     [rightmove](https://www.rightmove.co.uk) [Zoopla](https://www.zoopla.co.uk) [PrimeLocation.com](https://www.primelocation.com)

"Once you find the property you want to buy, you will need to carry out more investigations into the property than it is practical or reasonable for an estate agent to do when preparing sales particulars. For example, we have not carried out any kind of survey of the property to look for structural defects and would advise any homebuyer to obtain a surveyor's report before exchanging contracts. If you do not have your own surveyor, we would be pleased to recommend one. We have not checked whether any equipment in the property (such as central heating) is in working order and would advise homebuyers to check this. You should also instruct a solicitor to investigate all legal matters relating to the property (e.g. title, planning permission etc) as these are specialist matters in which estate agents are not qualified. Your solicitor will also agree with the seller what items (e.g. carpets, curtains etc) will be included in the sale".