



732 Manchester Road

Castleton | OL11 3AQ

# 732 Manchester Road

Castleton | OL11 3AQ



## Overview

- Extended Mid-Terraced House
- Two / Three Bedrooms
- Additional Attic Room
- Two Reception Rooms
- Extremely Popular Location
- Ideal for First Time Buyers
- Close To Castleton Train Station
- Set Over Four Floors
- Basement Level Storage
- Convenient For Local Amenities
- Yard To Rear



## Extended Two Bedroom Mid-Terraced House In Extremely Popular Location

Located within walking distance of Castleton train station, this Extended mid-terraced house boasting spacious living accommodation comprising of an entrance hall, two reception rooms, kitchen, two bedrooms, storage room which is currently being utilised as a bedroom, shower room and cellar. Property also benefits from gas c/h, upvc d/g and rear yard.





Internally, the extended property offers ideal first time buyer living accommodation whilst briefly comprising of an entrance hall, two reception rooms, kitchen, two bedrooms, shower room, storage room which is currently being utilised as a bedroom, cellar and a private rear yard. The property benefits from having gas central heating and upvc double glazing throughout.

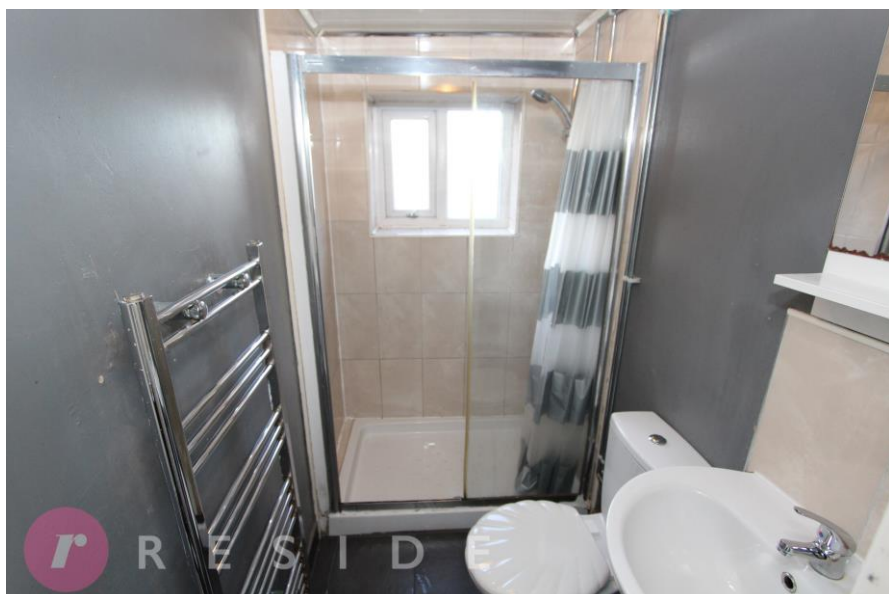

There is a yard to the rear.

## Ground Floor

Approx. 42.9 sq. metres (461.8 sq. feet)

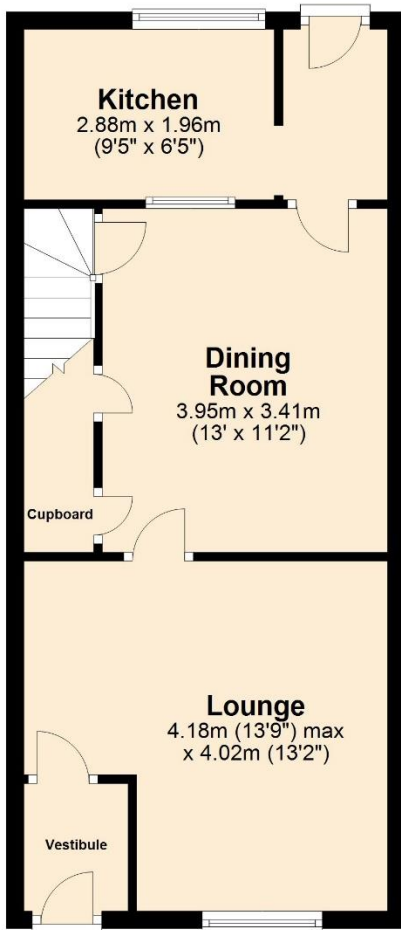

## First Floor

Approx. 36.5 sq. metres (393.3 sq. feet)

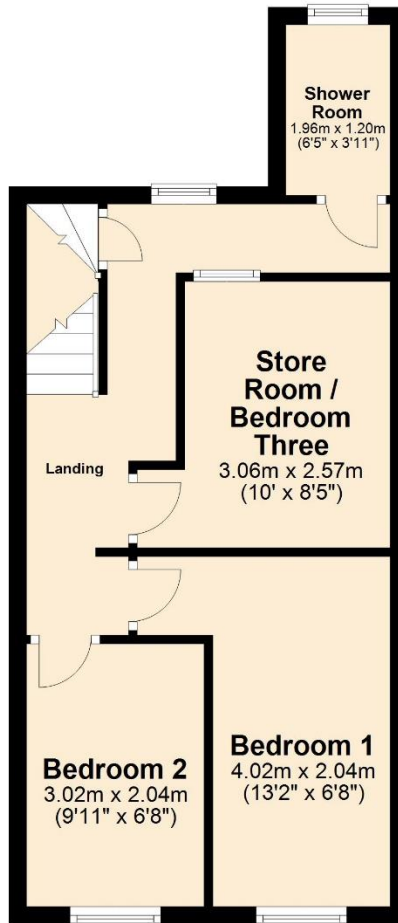

## Second Floor

Approx. 17.6 sq. metres (189.8 sq. feet)

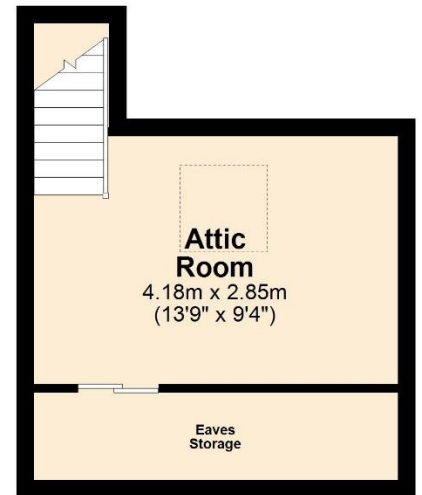

Total area: approx. 97.1 sq. metres (1044.9 sq. feet)

Reside Estate Agency  
Plan produced using PlanUp.

4 Smith Street, Rochdale  
Lancashire, OL16 1TU

Tel: 01706 356633

Email: [enquiries@reside.agency](mailto:enquiries@reside.agency)

[www.reside.agency](http://www.reside.agency)



rightmove

Zoopla

PrimeLocation.com

"Once you find the property you want to buy, you will need to carry out more investigations into the property than it is practical or reasonable for an estate agent to do when preparing sales particulars. For example, we have not carried out any kind of survey of the property to look for structural defects and would advise any homebuyer to obtain a surveyor's report before exchanging contracts. If you do not have your own surveyor, we would be pleased to recommend one. We have not checked whether any equipment in the property (such as central heating) is in working order and would advise homebuyers to check this. You should also instruct a solicitor to investigate all legal matters relating to the property (e.g. title, planning permission etc) as these are specialist matters in which estate agents are not qualified. Your solicitor will also agree with the seller what items (e.g. carpets, curtains etc) will be included in the sale".