



19 Mayville Avenue, Scarborough, YO12 7NW
£750 PCM

This two bedroom terraced house is situated close to Peasholm Park and the South Bay, as well as being within walking distance of the Town Centre and supermarkets. The property benefits from gas central heating, uPVC double glazing and a yard. It comprises a lounge, dining room, kitchen, two bedrooms, bathroom and an occasional loft room.

Children considered, sorry no pets or smoking.

EPC rating E

FRONT DOOR

leading to

HALLWAY

leading to

LOUNGE

with wooden floor, gas fire and surround, bay window overlooking the front and radiator

DINING ROOM

with wooden floor, window over looking the rear and radiator

KITCHEN

with a range of base and wall units, stainless steel sink unit, tiled splashbacks, plumbing for washing machine, space for fridge, gas cooker, radiator, window and door leading to rear yard

UPSTAIRS TO

BEDROOM ONE

with radiator, 2 wardrobes and 2 windows overlooking the front

BEDROOM TWO

with radiator and window overlooking the rear

BATHROOM

with a three piece suite, shower over the bath, radiator and window

ATTIC

with 2 velux windows

OUTSIDE

courtyard front, enclosed yard to the rear with access onto the back lane

UTILITIES

COUNCIL TAX - B (North Yorkshire Council)

GAS AND ELECTRIC CHARGES - TBC

WATER CHARGES - TBC

REFERENCING

TO APPLY WE REQUIRE PHOTO ID, PROOF OF INCOME, PROOF OF ADDRESS AND A HOLDING DEPOSIT OF £170.00 (PLEASE NOTE: THIS WILL BE WITHHELD IF ANY RELEVANT PERSON (INCLUDING ANY GUARANTORS) WITHDRAW FROM THE TENANCY, FAIL A RIGHT TO RENT CHECK, PROVIDE MATERIALLY SIGNIFICANT FALSE OR MISLEADING INFORMATION, OR FAIL TO SIGN THEIR TENANCY AGREEMENT (AND/OR GUARANTOR AGREEMENT) WITHIN 15 CALENDAR DAYS (OR OTHER DEADLINE FOR AGREEMENT AS MUTUALLY AGREED IN WRITING).

AFTER PASSING THE RENT AND DEPOSIT THAT ARE DUE ON THE DAY OF SIGNING THE AGREEMENTS ARE:

RENT £750.00

HOLDING DEPOSIT -£170.00

BOND £865.00

TOTAL £1445.00

Floor Plan

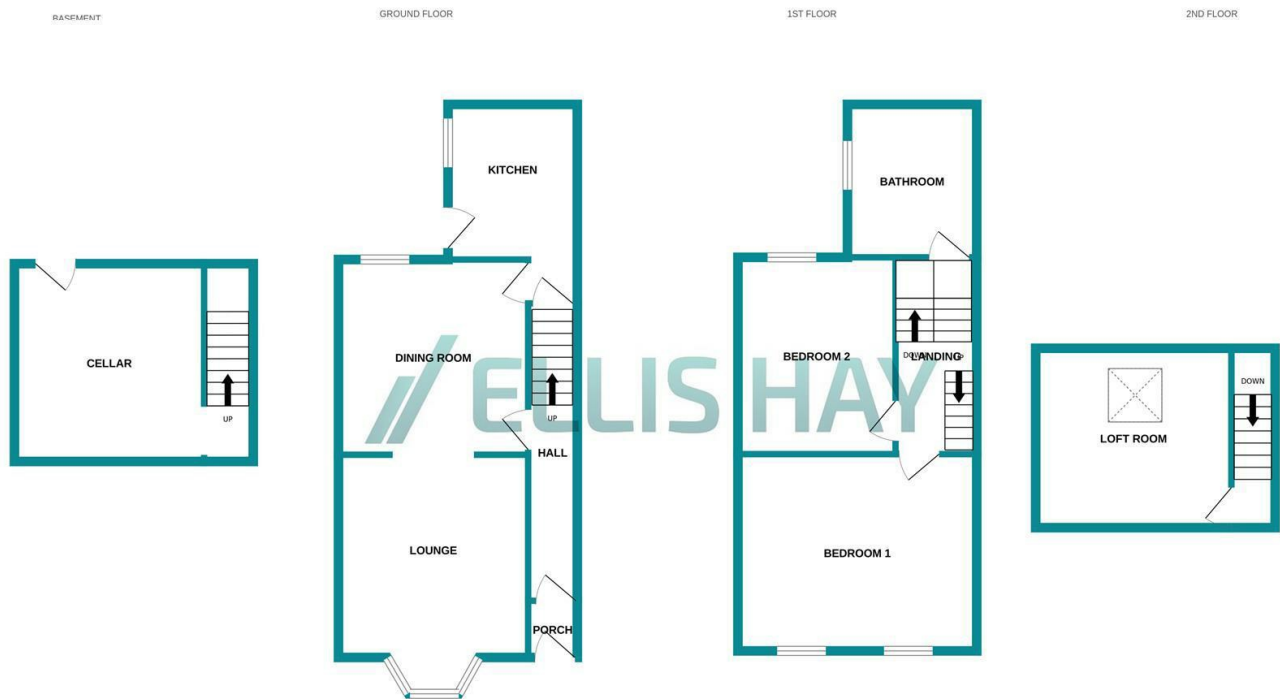

Whilst every attempt has been made to ensure the accuracy of the floorplan contained here, measurements of doors, windows, rooms and any other items are approximate and no responsibility is taken for any error, omission or mis-statement. This plan is for illustrative purposes only and should be used as such by any prospective purchaser. The services, systems and appliances shown have not been tested and no guarantee as to their operability or efficiency can be given.
Made with Metropix ©2024

Area Map

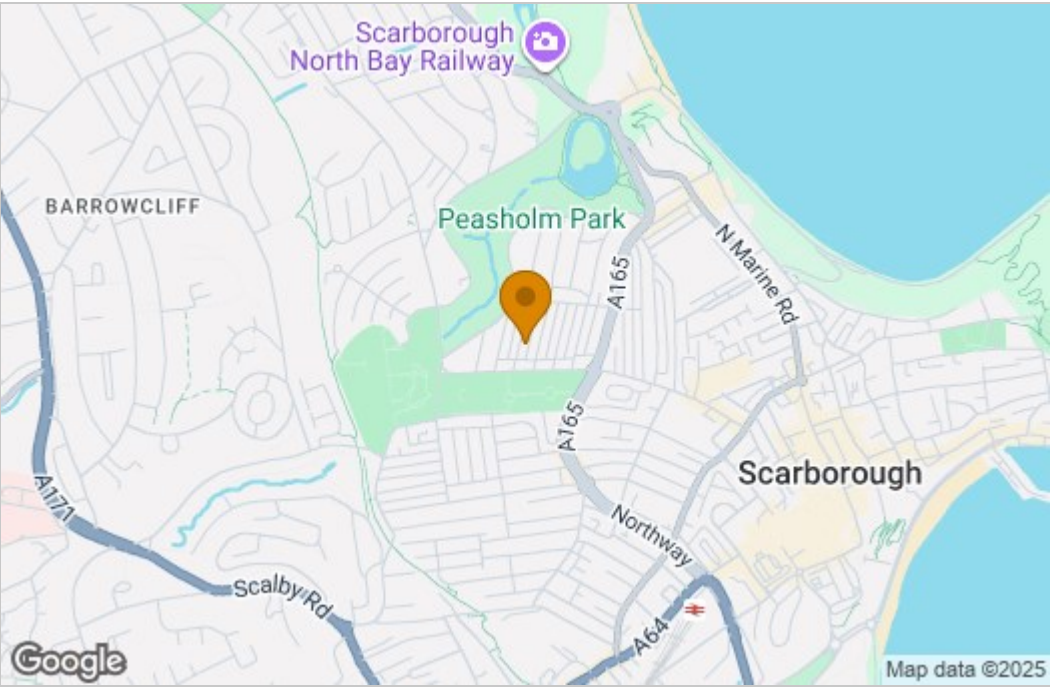

Energy Efficiency

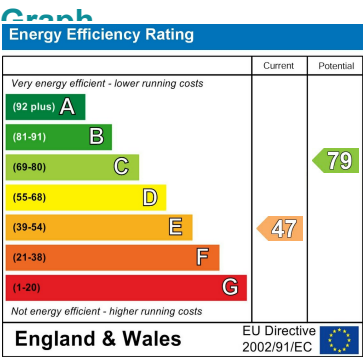

These particulars, whilst believed to be accurate are set out as a general outline only for guidance and do not constitute any part of an offer or contract. Intending purchasers should not rely on them as statements of representation of fact, but must satisfy themselves by inspection or otherwise as to their accuracy. No person in this firms employment has the authority to make or give any representation or warranty in respect of the property.