

ELLIS HAY

COMMERCIAL



93 Victoria Road

Town Centre, Scarborough, YO11 1SP

£119,000

***** INVESTMENT OPPORTUNITY *****

A commercial property with separate upstairs maisonette. Currently let as a café on the ground floor which includes a basement and rear yard. The upstairs maisonette is let to a long-term tenant with selective licence in place. Well maintained and presented throughout. EPC (Café) B; EPC (Flat) D.



DESCRIPTION

This property is located on one of Scarborough's busiest retail streets. Briefly comprising a shop unit at ground level with a 2 bedroomed maisonette above. It is a well maintained property with tenants for both units already in place with a gross income of £10560

GROUND FLOOR

Currently let as a café with basement and yard with customer toilets and small storage buildings. Current lease £385pcm. EPC B. Rateable Value £4200

MAISONETTE

A two bedroom maisonette with gas central heating, UPVC double glazing and briefly comprising a lounge, kitchen, W/C, 2 bedrooms and a bathroom. All licences and certificates in place. Currently let at £495pcm. EPC D. Council Tax Band A.

Tenure

This is a Freehold property.

**Please note this property is owned by 2 of the partners of Ellis Hay. **

Area Map

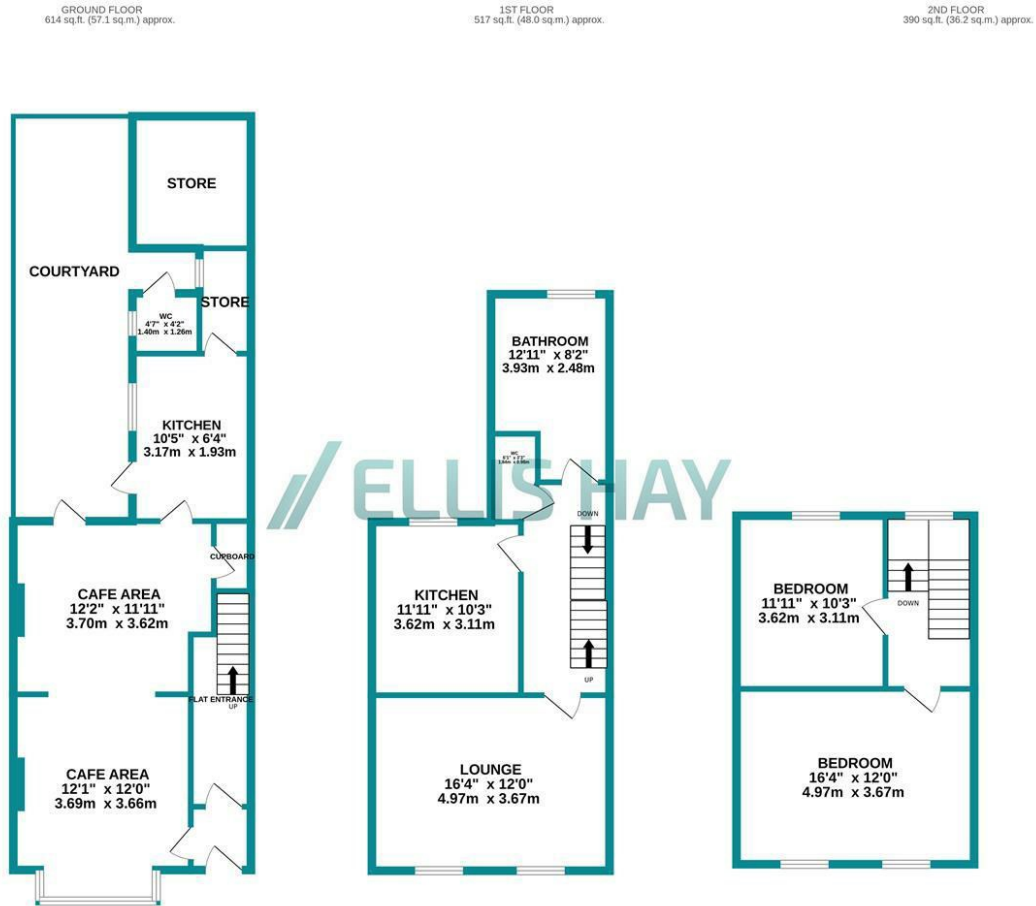

GROUND FLOOR
614 sq.ft. (57.1 sq.m.) approx.

1ST FLOOR
517 sq.ft. (48.0 sq.m.) approx.

2ND FLOOR
390 sq.ft. (36.2 sq.m.) approx.

TOTAL FLOOR AREA : 1521 sq.ft. (141.3 sq.m.) approx.

Whilst every attempt has been made to ensure the accuracy of the floorplan contained here, measurements of doors, windows, rooms and any other items are approximate and no responsibility is taken for any error, omission or mis-statement. This plan is for illustrative purposes only and should be used as such by any prospective purchaser. The services, systems and appliances shown have not been tested and no guarantee as to their operability or efficiency can be given.
Made with Metrolix ©2024

Ellis Hay for themselves, for any joint agents and for the vendors or lessors of this property whose agents they are, give notice that (all the particulars are set out as a general outline only for the guidance of intending purchasers or lessees, and do not constitute, nor constitute part of, an offer or contract; (ii) all descriptions, dimensions, references to condition and necessary permissions for use and occupation, and other details are given in good faith and are believed to be correct but any intending purchasers or tenants should not rely on them as statements or representations of fact but must satisfy themselves by inspection or otherwise as to the correctness of each of them; (iii) no person in the employment of Ellis Hay, has any authority to make or give any representation or warranty whatever in relation to this property