



106 Hovingham Drive

Woodlands, Scarborough, YO12 5DT

Guide Price £185,000



Ellis Hay is delighted to offer to the market this 2 Bedroom Semi Detached Property on the popular Hovingham Drive on the North Side of Scarborough. When briefly described, the property comprises of lounge/diner, kitchen, 2 bedrooms and bathroom. **SOLD WITH NO ONWARD CHAIN**, we highly recommend a viewing of this property. In our opinion, this would be a great property for a first time buyer or as an investment property. Call our office today to book your viewing.



UPVC FRONTDOOR

Leading to entrance lobby

LOUNGE 13'1" x 12'5" (4 x 3.8)

With a UPVC double glazed window overlooking the front, T.V point, gas fire and corniced ceiling

KITCHEN 13'1" x 8'5" (4 x 2.58)

With a range of wall and base units, stainless steel sink, built in oven and hob, plumbing for automatic washing machine, double glazed window overlooking the rear and a back door

STAIRS TO

BEDROOM ONE 13'1" x 9'0" (4 x 2.76)

With a radiator and UPVC double glazed window overlooking the front,

BEDROOM TWO 9'10" x 8'5" (3 x 2.58)

With a radiator and a double glazed window overlooking the rear

BATHROOM

With a white three piece suite having a shower over the bath, radiator and a double glazed window

OUTSIDE

To the front there is a lawn area, to the side there is off street parking and to the rear there is an enclosed garden laid mainly to lawn

DIRECTIONS

From the Station proceed down to Falsgrave through the traffic lights, right at the mini roundabout, left at the lights into Woodlands, first left into Hovingham Drive and the property is on the right

Area Map



Energy Efficiency Rating

	Current	Potential
Very energy efficient - lower running costs		
(92 plus) A		
(81-91) B		86
(69-80) C		
(55-68) D	62	
(39-54) E		
(21-38) F		
(1-20) G		
Not energy efficient - higher running costs		
England & Wales	EU Directive 2002/91/EC	

Council Tax Band: B

Tenure: Freehold

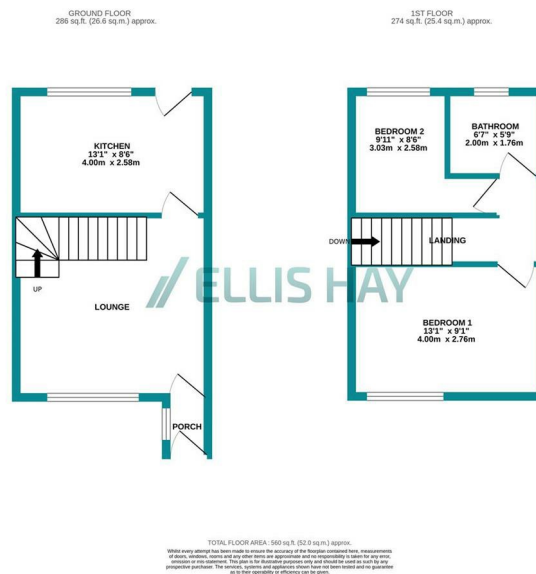

Ellis Hay for themselves, for any joint agents and for the vendors or lessors of this property whose agents they are, give notice that {all the particulars are set out as a general outline only for the guidance of intending purchasers or lessees, and do not constitute, nor constitute part of, an offer or contract; (ii) all descriptions, dimensions, references to condition and necessary permissions for use and occupation, and other details are given in good faith and are believed to be correct but any intending purchasers or tenants should not rely on them as statements or representations of fact but must satisfy themselves by inspection or otherwise as to the correctness of each of them; (iii) no person in the employment of Ellis Hay, has any authority to make or give any representation or warranty whatever in relation to this property