



Websters  
estate agents



# Twickenham Road, Hanworth, TW13 6HG

Mid Terrace Victorian 2 double bedroom family home with a 40ft rear garden situated opposite David Lloyd Hampton and just 0.5 miles from local shops and the A316 with direct access to the M3/M25 and central London.

With no onward chain, in need of some updating and offering 825 sq ft of well balanced living space over 2 floors with double glazed windows and potential to extend, reconfigure the layout and loft convert (subject to Planning Permission and Building Regulations)

Entrance porch opens into the spacious dual aspect living/dining room with a door onto the garden and access into the utility room and the fitted kitchen at the rear. On the first floor are 2 bedrooms, the large family bathroom and hatch access to loft storage.

Located by bus stops toward s Richmond, Kingston and Heathrow and within 0.6 miles of Hampton Common and Crane Park with a walking/cycle track along the River Crane into Twickenham  
EPC Rating D

- Mid Terrace Victorian Home
- 2 Double Bedrooms and Upstairs Bathroom
- No Onward Chain
- In Need of Updating
- Potential to Extend and Loft Convert (stpp)
- 825 Sq Ft of Living Space over 2 Floors
- Within 0.5 Miles of Local Shops and A316



## Glebe Cottages, Twickenham Road

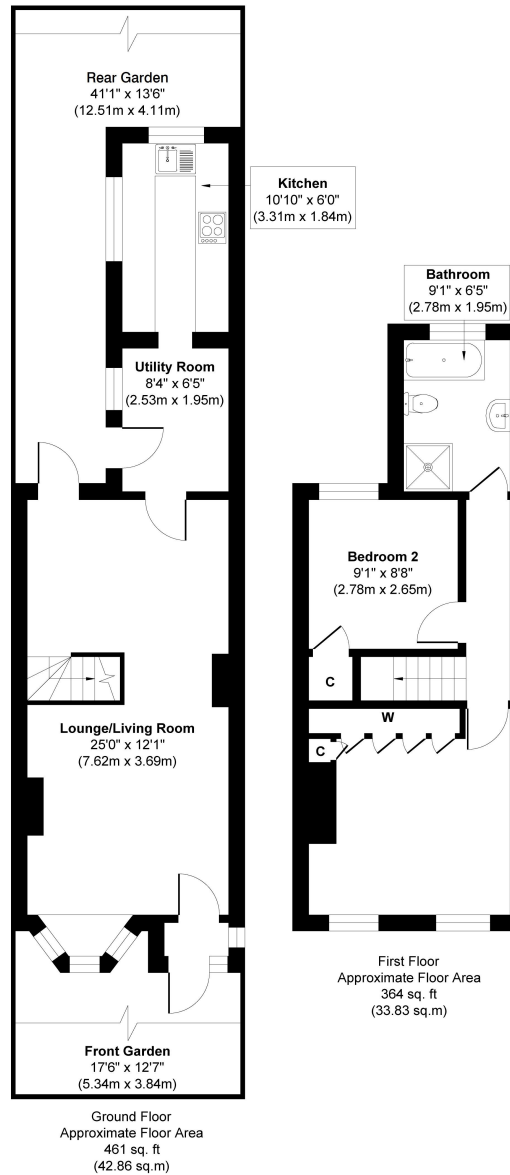

**a** Websters Estate Agents 36 Broad Street, Teddington, Middlesex TW11 8QY

**t** 020 8614 6000

**e** sales@mywebsters.co.uk **w** mywebsters.co.uk

### Disclaimer

These particulars, whilst believed to be accurate are set out as a general outline only for guidance and do not constitute any part of an offer or contract. Intending purchasers should not rely on them as statements of representation of fact, but must satisfy themselves by inspection or otherwise as to their accuracy. We have not carried out a detailed survey nor tested the services, appliances and specific fittings. Room sizes should not be relied upon for carpets and furnishings. The measurements given are approximate. No person in this firm's employment has the authority to make or give any representation or warranty in respect of the property.



