



MORGAN  
APS  
SALES & LETTINGS

# BARROW MILL

Nr. Suckley | £850,000



# The nitty gritty...

Lovely big rambling period rural home - Grade II\* old mill dating back to 16th century. Set in beautiful gardens and grounds along with 3 period barns plus frontage down to the pretty Cradley Brook in this wonderfully peaceful setting at the head of a quiet no through lane nr Suckley. In all excess 1.25 acres. Some TLC required but great bones with some fantastic period features. 3 detached stone build period outbuildings include the garage with room over, the old cider barn and the old mill complete with evidence of the old workings. Stroll down the footpath into Suckley with the Hop Shed brewery certainly within walking distance. Malvern and Worcester in easy reach. No onward chain to make matters simpler.

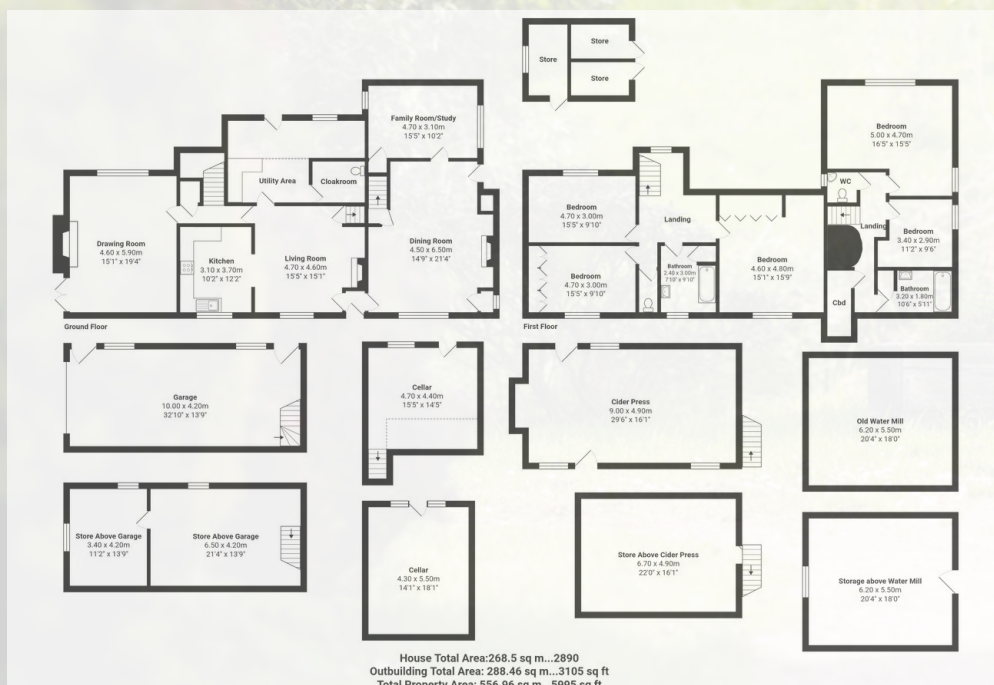



01905 384848



info@morganaps.co.uk



morganaps.co.uk

