



The Manse

Grimley, Worcestershire

MORGAN
APS

The Manse

Grimley, Worcestershire

An elegant Georgian house at the heart of the village with stunning interiors and a great outdoor swimming pool. 2,798 sq ft of classically proportioned accommodation set over three floors and full of period character. Enjoy everyday life in style in the spacious dining kitchen, which is complemented by a highly practical utility / boot room. There are two comfortable reception rooms facing the rear garden, including an impressive drawing room and a large study - ideal for home working or as a second sitting room. Five double bedrooms to the first and second floors plus a family bathroom. Enjoy a dip in the swimming pool or breakfast on the terrace, while the enclosed mature rear garden area offers space to potter. There is plenty of parking to a walled, gravelled area with an additional space to a further area beyond. Garden store adjoining the house which offers potential for conversion (subject to planning). Head out for a leisurely walk by the river or Grimley's picturesque lakes. Worcester City, excellent state and independent schooling and the motorway network are a short drive away.



In a Nutshell

- Attractive Georgian house with classically proportioned rooms and stunning interiors
- Positioned centrally within the village and conveniently for access to Worcester City yet with scenic countryside on the doorstep
- Reception hall. Drawing room. Second reception room - ideal as a study or sitting room
- Large dual aspect kitchen / dining room - the heart of the home
- Great utility / boot room with door to rear garden. Downstairs shower room. Cellar
- Impressive first floor landing. Five superb bedrooms. Family bathroom
- Mature rear garden with seating terrace and outdoor swimming pool. Brick built garden store adjoining the house (with potential for conversion, subject to planning)
- Walled gravelled parking area plus further parking space



Where to go when you need



Broomfields Farm Shop at Holt Heath, Top Barn Farm Shop at Hallow



Sainsbury's and Waitrose in Worcester



Broomfields Farm Kitchen at Holt Heath, Bonnies Tea Room at Hallow, No. 1 Brownes Way at Hallow, extensive choice of first class restaurants and gastro pubs in Ombersley and Worcester



David Lloyd and Nuffield health clubs in Worcester



Ombersley Golf Club and Worcester Golf & Country Club



Good selection of state and private schools nearby



Shrub Hill and Foregate Street Stations in Worcester, Worcestershire Parkway at Norton



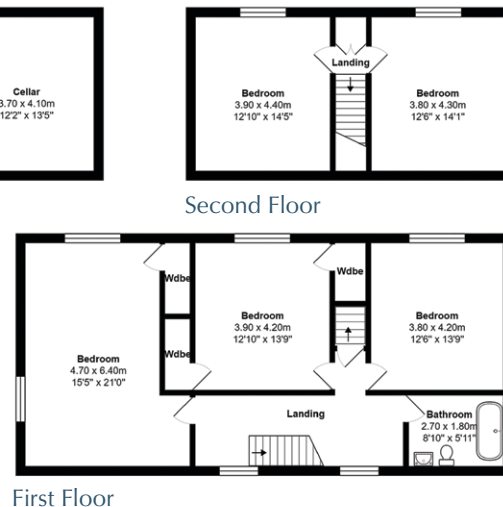

Approx. Gross Internal Area:
260 sq m / 2798 sq ft

Please note that all measurements and the floor plan are quoted for general guidance and whilst every attempt has been made to ensure accuracy, they must not be relied upon and do not form part of a contract.

The Finer Details

Services

Mains water, mains electricity, oil fired central heating, private drainage to shared septic tank

Malvern Hills District Council –
Council Tax Band F

How Far?

Worcester City Centre: 4.9 miles
Omberlsey Village Centre: 4.5 miles
M5 Junction 7: 7.3 miles
Worcestershire Parkway Station: 9.6 miles

(All mileages are approximate)

Directions

Postcode: WR2 6LU
what3words: ///apples.fence.view

Important Notice

Morgan Aps LLP and any joint agents give notice that:

The particulars, produced in good faith, are set out as a general guide only and do not constitute or form any part of an offer or any contract. No person within Morgan Aps has any authority to make or give representation or warranty on any property.

Morgan Aps Sales & Lettings LLP is a Limited Liability Partnership. Registered in England and Wales. Registered No: OC396668



01905 384848

info@morganaps.co.uk | www.morganaps.co.uk

Estate Office, Upper Court, Lulsley, Worcester WR6 5QW