



 2  
Bedrooms

 1  
Bathroom





TRADING PLACES ESTATE AGENTS are proud to offer for sale this superbly presented and spacious TWO DOUBLE BEDROOM bungalow situated on a good sized corner plot close to Trafford General Hospital. Tastefully decorated and well maintained, this highly desirable, deceptively spacious property briefly comprises; storm porch, a warm and welcoming entrance hallway, a bay fronted living room overlooking Davyhulme Golf Course, a modern fitted 20ft dining kitchen, two large double bedrooms, a two piece bathroom with separate wc. Externally, to the front of the property, there is an extensive paved gated driveway providing ample off road parking leading to a single garage and lawned garden. To the side of this property a shaped patio leading onto lawned garden with mature flower beds. This property is warmed by gas central heating system and is fully uPVC double glazed. This property is conveniently situated within easy reach of a range of shops and general services on Moorside Road. An internal viewing is highly recommended to fully appreciate all this property has to offer.

GROUND FLOOR  
1053 sq.ft. (97.8 sq.m.) approx.

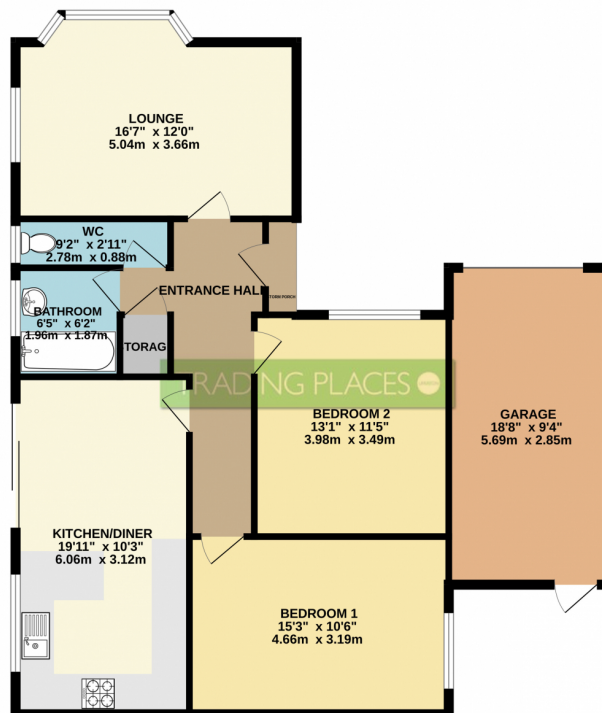

TOTAL FLOOR AREA: 1053 sq.ft. (97.8 sq.m.) approx.

Whilst every attempt has been made to ensure the accuracy of the floorplan contained here, measurements of doors, windows, stairs and any other items are approximate and no responsibility is taken for any error, omission or mis-statement. This plan is for illustrative purposes only and should be used as such by any prospective purchaser. The services, systems and appliances shown have not been tested and no guarantee as to their operability or efficiency can be given.  
Made with Metropix ©2024

