



Flat 2, Mudehaven Court, 64 Mudeford
Christchurch

Guide Price **£475,000**



Flat 2

Mudehaven Court, Christchurch

Nestled in a sought-after location, this charming two-bedroom ground floor garden apartment presents an exceptional opportunity for those seeking a tranquil retreat by the coast. With a share of freehold, this property offers a sense of ownership and stability. The apartment boasts a private patio area, perfect for enjoying morning coffees or alfresco dining. A garage in a block provides convenient storage options for cars or outdoor gear. This property is offered with vacant possession, making it move-in ready for its new owners. A stone's throw from the picturesque Mudeford quay, residents can enjoy leisurely strolls along the waterfront, soaking up the peaceful atmosphere. With its secluded position in the block, this apartment offers an ideal retreat for those looking for privacy and relaxation.

The outdoor space of this property further enhances its appeal, providing a serene oasis for residents to unwind and enjoy the fresh sea air. The meticulously maintained grounds offer a peaceful setting, creating a welcoming ambience for residents and visitors alike. With the private patio and garden area, there is ample space for outdoor entertaining or simply relaxing in the sunshine. The garage in a block ensures that parking is hassle-free, leaving residents free to explore the nearby amenities and attractions. Whether indulging in a leisurely walk along the quay or sitting back and taking in the views, the outside space of this property offers a sanctuary from the hustle and bustle of every-day life. Don't miss out on the opportunity to make this tranquil garden apartment your own and experience coastal living at its finest.

Ground Floor

Approx. 83.5 sq. metres (898.5 sq. feet)

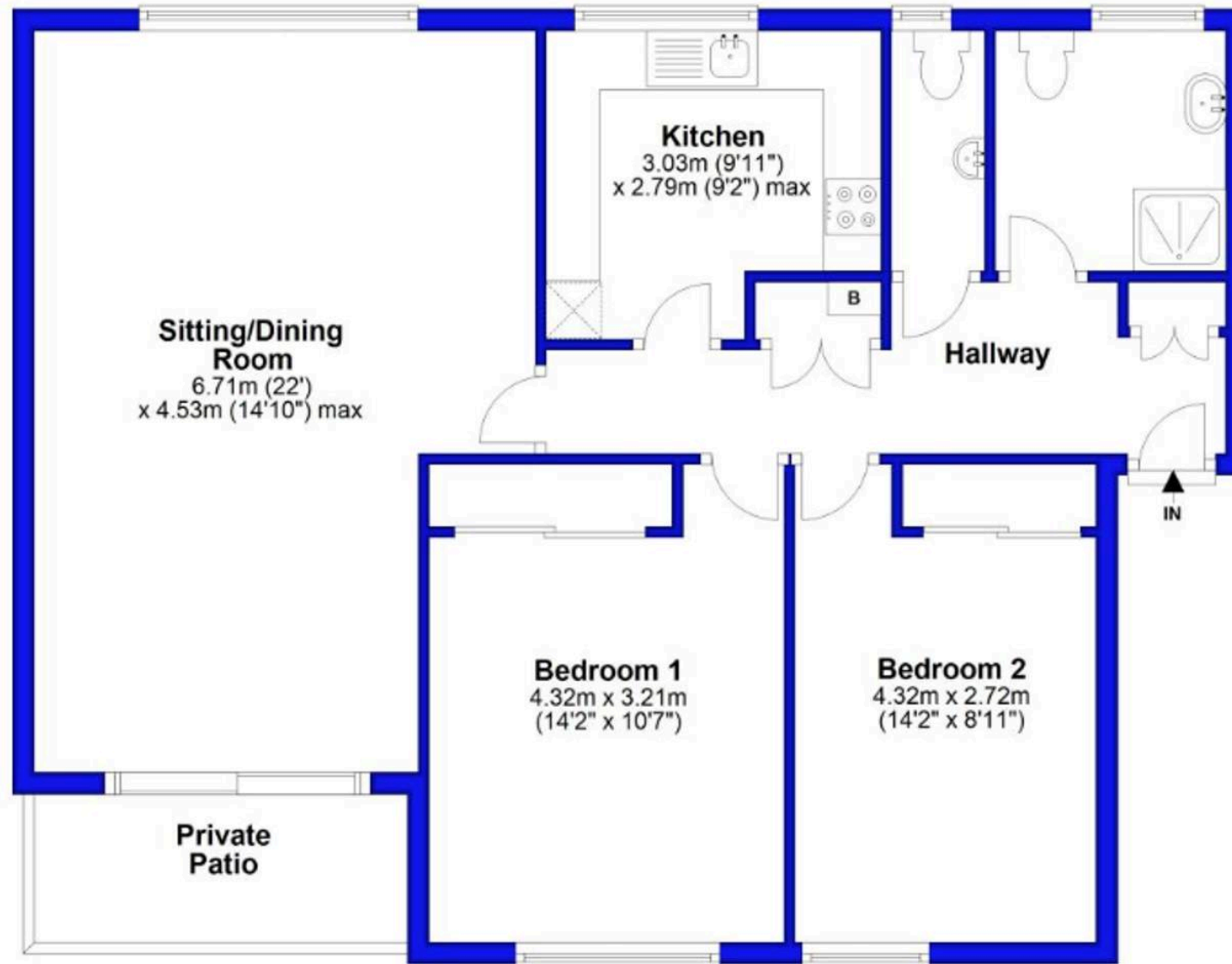

Illustration for identification purposes only; measurements are approximate, not to scale. EPC New Forest
Plan produced using PlanUp.



Flat 2

Mudehaven Court, Christchurch

Mudehaven Court is an opportunity to purchase a well presented two bedroom ground floor flat in a sought after part of Mudeford. The property is situated within a short distance of the picturesque Mudeford Quay, Stanpit Nature Reserve and the sandy Avon Beach. Christchurch Town Centre with its 11th Century Priory, Town Quay and various shops, cafes, bars and restaurants is just over 1.5 miles away. Mudeford Infant & Junior Schools are also close by.

Council Tax band: D

Tenure: Share of Freehold

EPC Energy Efficiency Rating: C

EPC Environmental Impact Rating: C

- Share of freehold
- Two bedroom ground floor garden apartment
- Private patio area
- Garage in a block
- Vacant possession
- Move in ready
- Stones throw from Mudeford quay
- Ideal secluded apartment in the block





Jordan Marks estates

Jordan Marks Estates, 16 High Street - BH23 1AY

01202 484444 • george@jordanmarksestates.co.uk • <http://jordanmarksestates.co.uk>

JM
Jordan Marks Estates