

# MOVING HOMES



SALES & LETTINGS



Offers Over £160,000



# Cheadle Avenue, Wallsend

## Offers Over £160,000

Moving Homes welcome to the market this must view three bedroom mid-terrace home nicely situated within the popular Hadrian Park estate. This beautifully presented home comprises of; a well-proportioned living room illuminated by natural light, an updated kitchen-diner with ample storage and a peninsula.

Upstairs you are greeted with two spacious double bedrooms and one single bedroom and a modern bathroom with an in-bath shower.

Externally this property offers; a separate single garage and an attractive front garden and a private rear garden.

Tenure - The agent understands the property to be leasehold with 999 years from 1964, with a ground rent of £15 per annum however this should be confirmed by a legal representative.

Council Tax Band – B £1727.03 pa

EPC Rating - Awaiting

We endeavour to make our sales particulars accurate and reliable, however, they do not constitute or form part of an offer or any contract and none is to be relied upon as statements of representation or fact. Any services, systems and appliances listed in this specification have not been tested by us and no guarantee as to their operating ability or efficiency is given. All measurements have been taken as a guide to prospective buyers only and are not precise. If you require clarification or further information on any points, please contact us, especially if you are travelling some distance to view. Fixtures and fittings other than those mentioned are to be agreed with the seller by separate negotiation. To secure a viewing please contact Moving Homes on 0191-2964600 or visit our website [movinghomesuk.com](http://movinghomesuk.com)



GROUND FLOOR  
403 sq.ft. (37.4 sq.m.) approx.

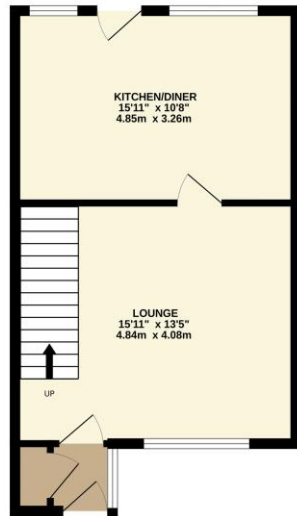

1ST FLOOR  
396 sq.ft. (36.5 sq.m.) approx.

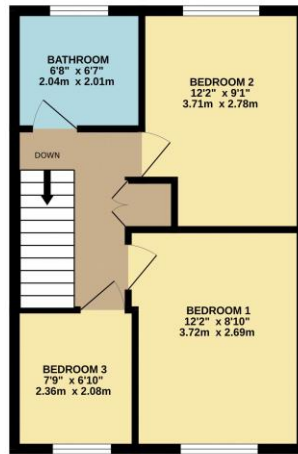

TOTAL FLOOR AREA - 799 sq.ft. (74.2 sq.m.) approx.  
Whilst every attempt has been made to ensure the accuracy of the floorplans contained here, measurements of doors, windows, rooms and any other items are approximate and no responsibility is taken for any errors, omission or mis-statement. This plan is for illustrative purposes only and should be used as such by any prospective purchaser. The services, systems and appliances shown have not been tested and no guarantee as to their operability or efficiency can be given.  
Made with Metropo 10/2024







Tel: 0191 2964600 E: [info@movinghomesuk.com](mailto:info@movinghomesuk.com) [www.movinghomesuk.com](http://www.movinghomesuk.com)  
2A Hawkeys Lane North Shields Tyne & Wear NE29 0JF