



34 Quarry Road Ravenshead NG15 9AP

Asking price - £425,000 Freehold

Tel 01623 392676  
Email [mail@jfea.co.uk](mailto:mail@jfea.co.uk)  
Visit [jfea.co.uk](http://jfea.co.uk)





An immaculately presented and attractively modernised 4 bedroom, 4 reception room detached family home offering deceptively spacious accommodation throughout. This impressive home features an attractive newly fitted kitchen dining room with separate utility (see floor plan) downstairs cloakroom, superb lounge, family room/snug plus large conservatory. The first floor comprises 4 good size bedrooms with newly fitted en suite to the principal room and separate luxury family bathroom. Outside there's a private south facing rear garden and to the front driveway parking for two cars and integral garage (storage only). The location is very convenient for the M1 (approx. 6 miles) Nottingham and Mansfield plus local shops, supermarket, pubs (The Hutt and The Little John) restaurants (Santini's and Larch Farm) plus beautiful countryside walks at Newstead Abbey Country Park. Viewing strongly advised.













Asking price £425,000 Freehold

Council tax band E

Flood Risk : Very low

Gas central heating / double glazing

Viewing by appointment through  
Jonathan Fitzpatrick Village & Country Homes  
64 Main Street Farnsfield NG22 8EF

Telephone 01623 392676  
Email : mail@jfea.co.uk  
Web : jfea.co.uk

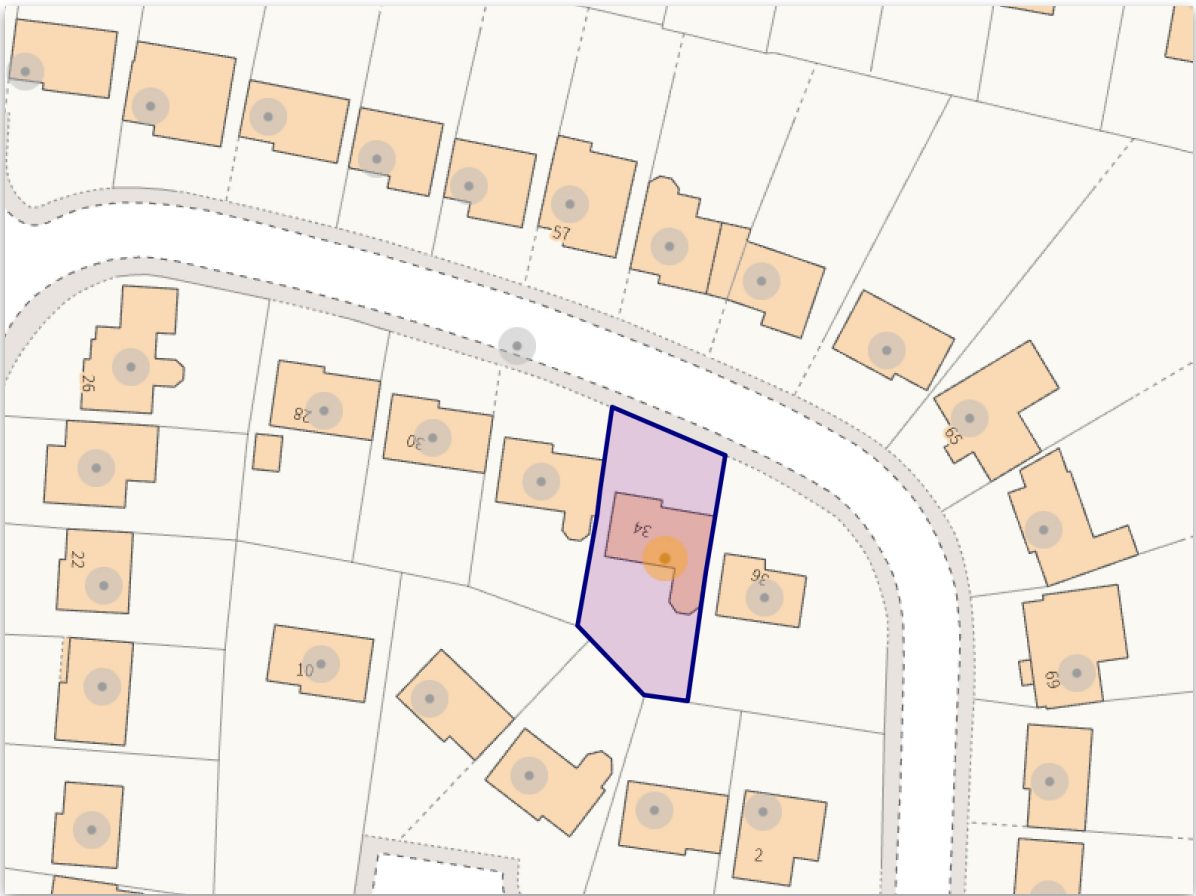

Energy performance certificate (EPC)

34, Quarry Road Ravenshead NOTTINGHAM NG15 9AP	Energy rating	Valid until: 10 November 2029
	<b>D</b>	Certificate number: 9298-9977-7229-6671-6984

# 34 Quarry Road, Ravenshead, Nottingham, NG15 9AP

Approximate Gross Internal Area  
1593 sq ft - 148 sq m

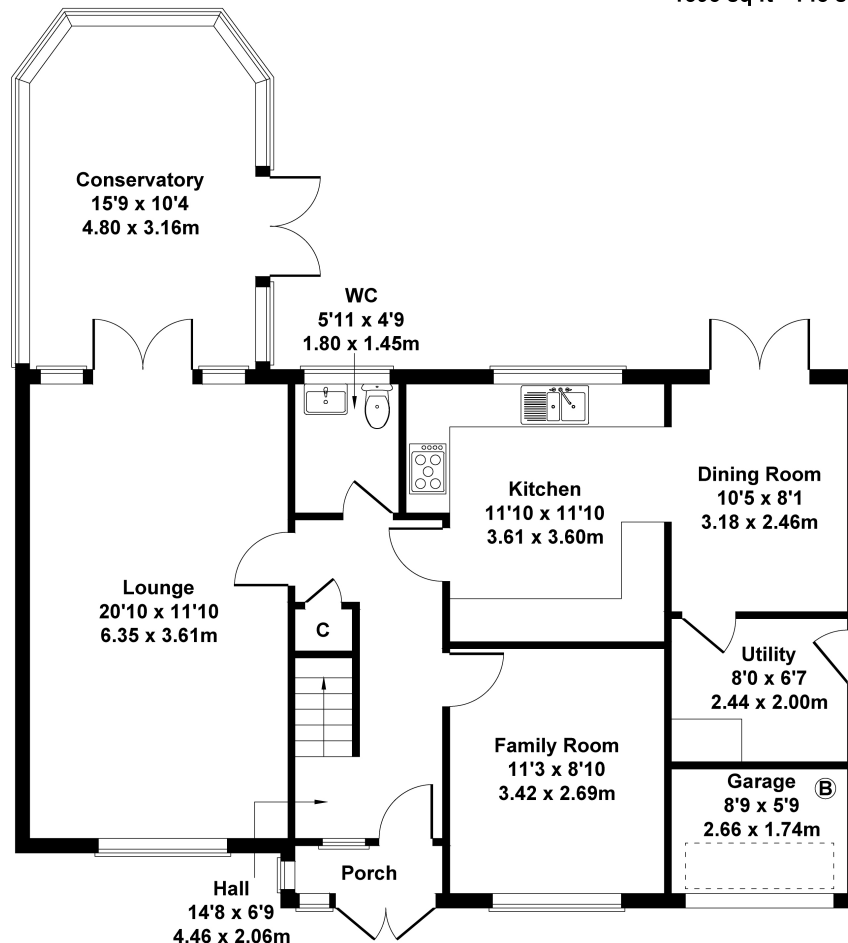

**GROUND FLOOR**

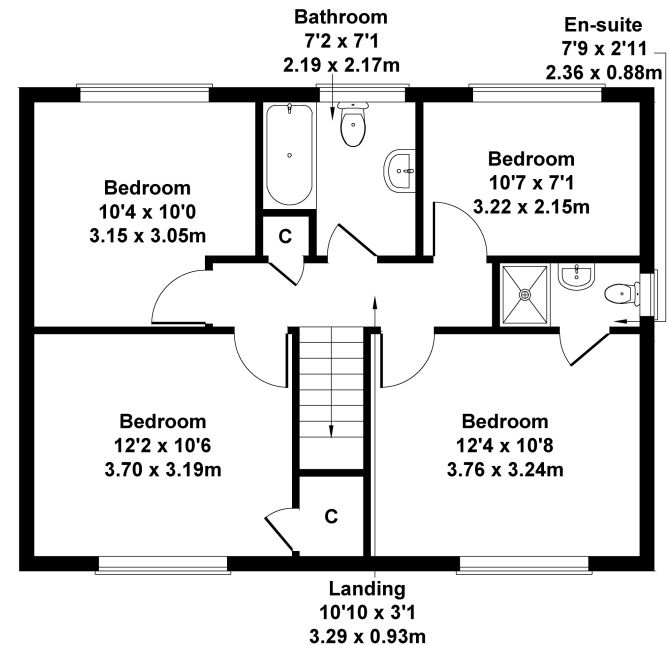

**FIRST FLOOR**

Not to Scale. Produced by The Plan Portal 2025  
**For Illustrative Purposes Only.**