



JF

Jonathan Fitzpatrick

VILLAGE & COUNTRY HOMES



11 Dover Street Southwell NG25 0EZ £350,000 Freehold

A characterful 3 bedroom detached home with large wrap around garden.

Make immediate arrangements to view this most attractive 3 bedroom, 2 reception room detached character home with single garage and driveway parking, situated on a larger than average plot with gardens to the side and rear.

The property is offered for sale in good decorative order throughout and offers great potential to extend (subject to planning consents) and add value. The location is extremely convenient for the town centre being just a short walk from the Burgage, King Street, the Southwell Trail and the The Final Whistle pub on Station Road. Competitively priced to attract buyers in strong purchasing positions. Viewing highly recommended.





The property is offered for sale in immaculate order throughout and with immediate vacant possession.

To arrange a viewing please call us on 01623 392676 or email mail@jfea.co.uk





11 DOVER STREET
SOUTHWELL
NG25 0EZ

Energy rating

E

Valid until
27 June 2031

Certificate number
2839-2526-8000-0054-7222

Southwell is a small, historic market town in Nottinghamshire, England, known for its rich heritage and picturesque setting. It is most famous for Southwell Minster, a stunning Norman cathedral that dates back to the 12th century. The town is also linked to the origins of the Bramley apple, first cultivated here in the early 19th century. Southwell has a charming mix of Georgian and Victorian architecture, quaint shops, and traditional pubs. Its history includes associations with Charles I, who was briefly imprisoned here during the English Civil War. The town offers a peaceful, rural atmosphere with vibrant cultural events and a strong community spirit.

Council tax band C
Gas central heating
All mains services
Flood Risk - No Risk

Catchment for Minster School
Newark Northgate Train Station to London
King Cross - approximately 8.5 miles

Main Office 01623 392676
Email mail@jfea.co.uk

64 Main Street Farnsfield Newark Ng22 8EF

Viewing strictly by appointment through
Jonathan Fitzpatrick Village & Country Homes

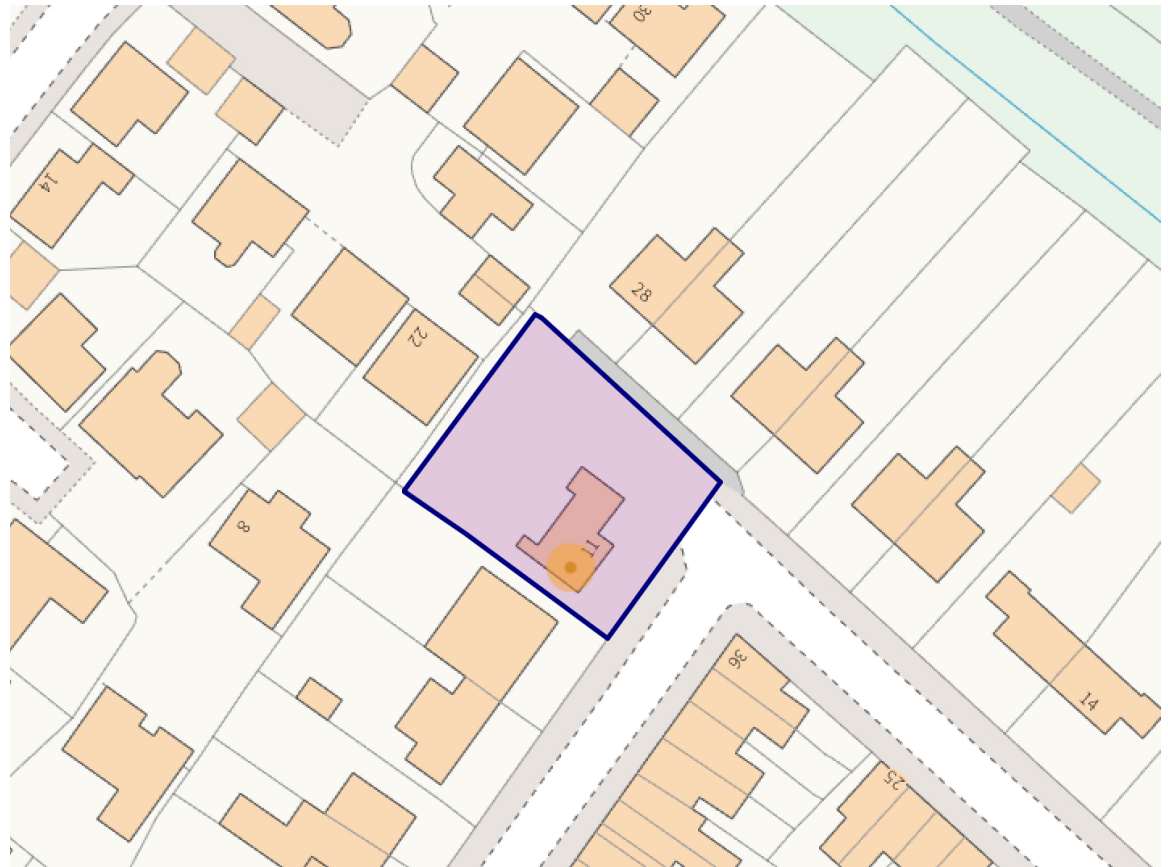

11 Dover Street, Southwell, NG25 0EZ

Approximate Gross Internal Area
1173 sq ft - 109 sq m

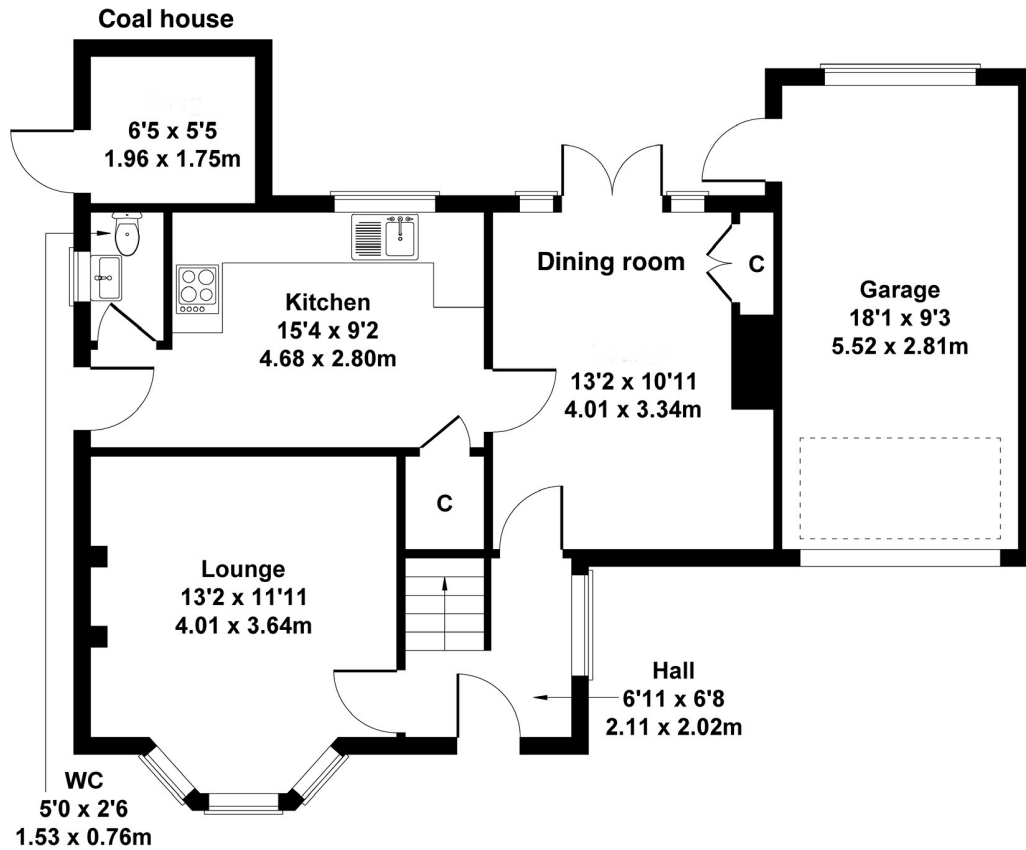

GROUND FLOOR

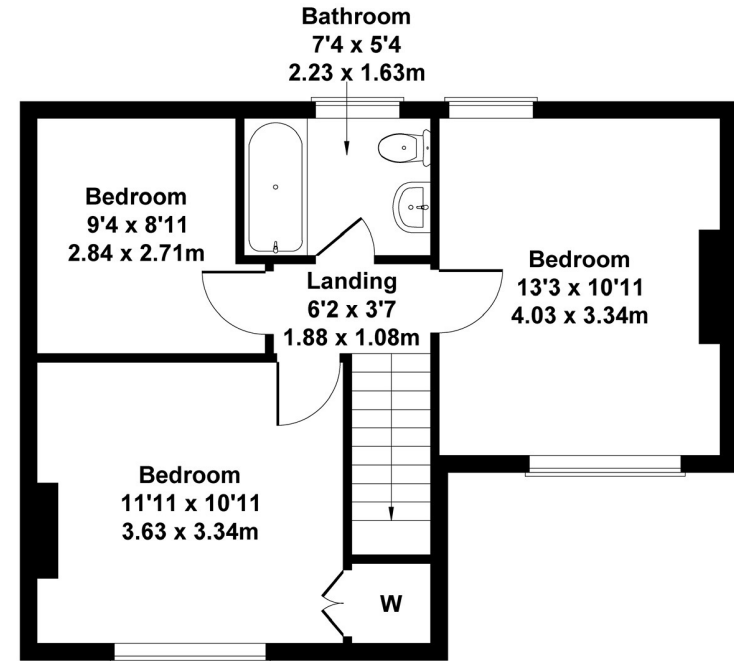

FIRST FLOOR

Not to Scale. Produced by The Plan Portal 2024
For Illustrative Purposes Only.

Agents Note: Whilst every care has been taken to prepare these sales particulars, they are for guidance purposes only. All measurements are approximate and for general guidance purposes only and whilst every care has been taken to ensure their accuracy, they should not be relied upon and potential buyers are advised to recheck the measurements