



JF

Jonathan|Fitzpatrick
VILLAGE & COUNTRY HOMES

15 Ridgeway Close Farnsfield NG22 8DT

Offers over £289,950 Freehold

A beautifully presented and updated 3 bedroom detached chalet style house situated in a quiet cul de sac close to all village amenities and a short walking distance to St. Michaels primary school. The property offers deceptively spacious accommodation throughout including a large L shaped lounge dining room with feature fireplace and bow window looking onto a superbly manicured private rear garden. Other features include study, quality re-fitted kitchen with built in appliances, utility room and downstairs cloakroom. The first floor comprises two attractive double bedrooms, and re-fitted modern family shower room, plus single bedroom with wardrobes (presently used as a dressing room). Outside there is a single garage, driveway parking, car port and attractive front garden with patio and additional lawn area.

Farnsfield is a busy and thriving country village with numerous independent shops, eateries and two great pubs. It boasts a charming period high street, an excellent primary school, tennis club, village hall and beautiful park. There are also numerous countryside side walks close by.

Attractively priced to appeal to buyers in strong purchasing positions.

All main services / Solar Panels / Council tax band D

Offers over £289,950 Freehold

Viewing by appointment through JF Village & Country Homes

Call us on 01623 392676 or email mail@jfea.co.uk







15 Ridgeway Close, Farnsfield, NG22 8DT

Approximate Gross Internal Area
1335 sq ft - 124 sq m

Energy performance certificate (EPC)

15, Ridgeway Close
Farnsfield
NEWARK
NG22 8DT

Energy rating
B

Valid until: 13 October 2024

Certificate number: 0954-2851-6917-9424-4725

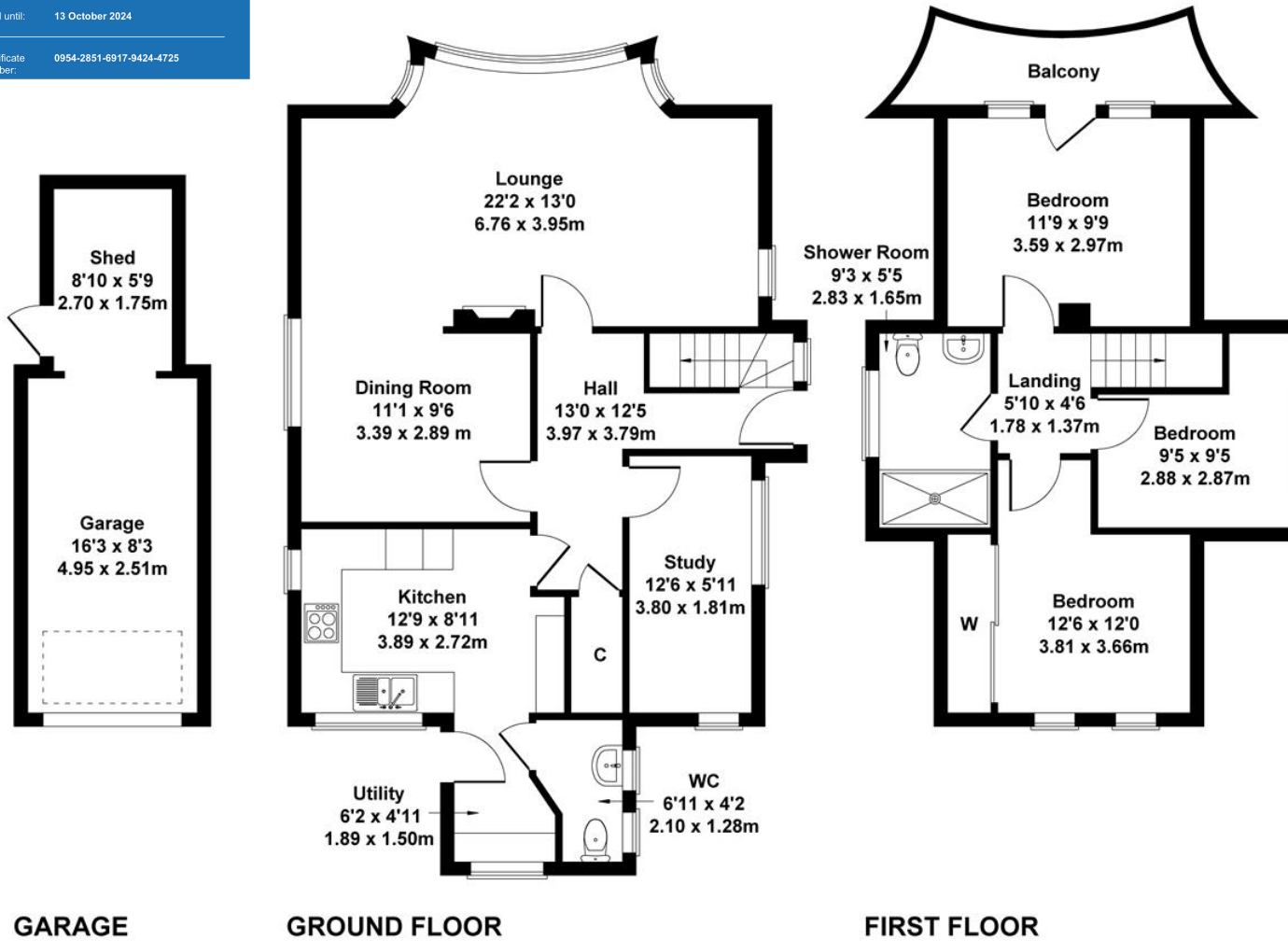

Not to Scale. Produced by The Plan Portal 2023
For Illustrative Purposes Only.

Agents Note: Whilst every care has been taken to prepare these sales particulars, they are for guidance purposes only. All measurements are approximate are for general guidance purposes only and whilst every care has been taken to ensure their accuracy, they should not be relied upon and potential buyers are advised to recheck the measurements