

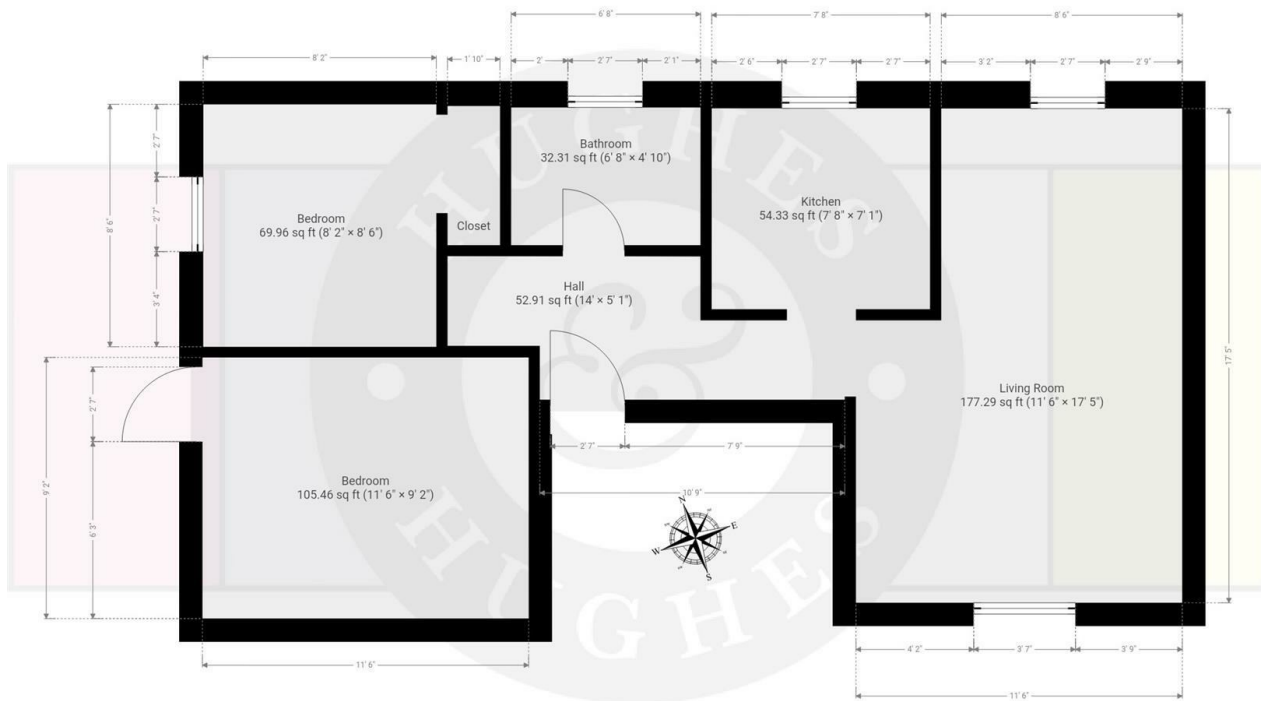

## 21 Post Office Lane, Corsham, SN13 0HJ

£210,000

- Two Bedroom Ground Floor Apartment
- Modern Kitchen and Bathroom
- Central Corsham location, moments from the High Street
- Excellent transport links to Bath and Chippenham
- Spacious Living Space with Dual Aspect Windows



THIS FLOORPLAN IS PROVIDED WITHOUT WARRANTY OF ANY KIND. SENSOPIA DISCLAIMS ANY WARRANTY INCLUDING, WITHOUT LIMITATION, SATISFACTORY QUALITY OR ACCURACY OF DIMENSIONS.

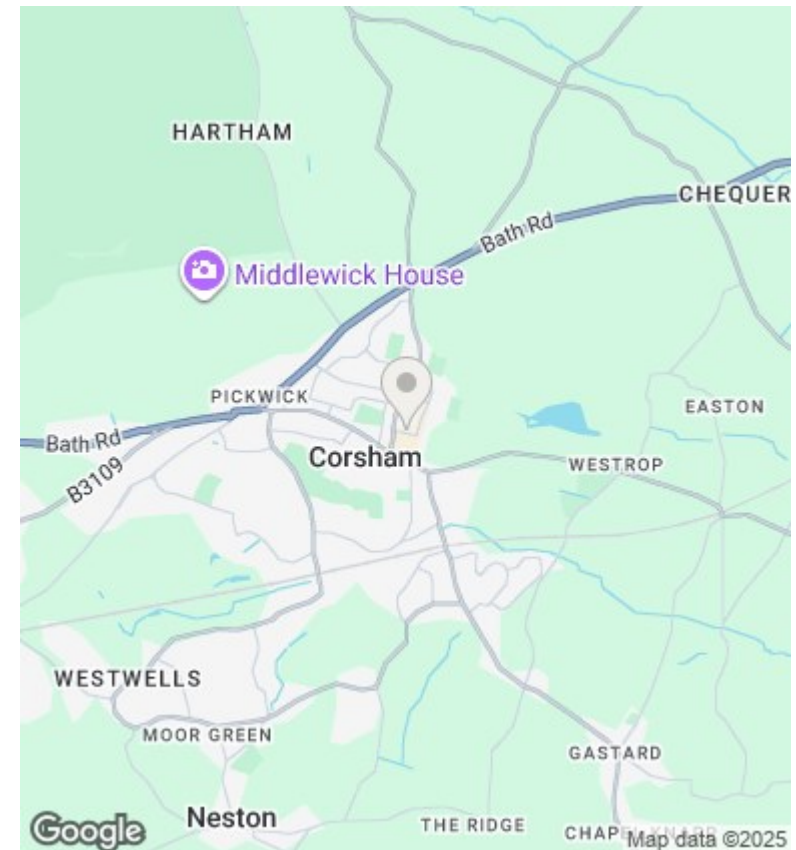

## Directions

## Viewings

Viewings by arrangement only. Call 01249 466999 to make an appointment.

## Council Tax Band

B

## EPC Rating:

Energy Efficiency Rating		
	Current	Potential
Very energy efficient - lower running costs		
(92 plus) <b>A</b>		
(81-91) <b>B</b>		
(69-80) <b>C</b>		
(55-68) <b>D</b>		
(39-54) <b>E</b>		
(21-38) <b>F</b>		
(1-20) <b>G</b>		
Not energy efficient - higher running costs		
<b>England &amp; Wales</b>	EU Directive 2002/91/EC	