

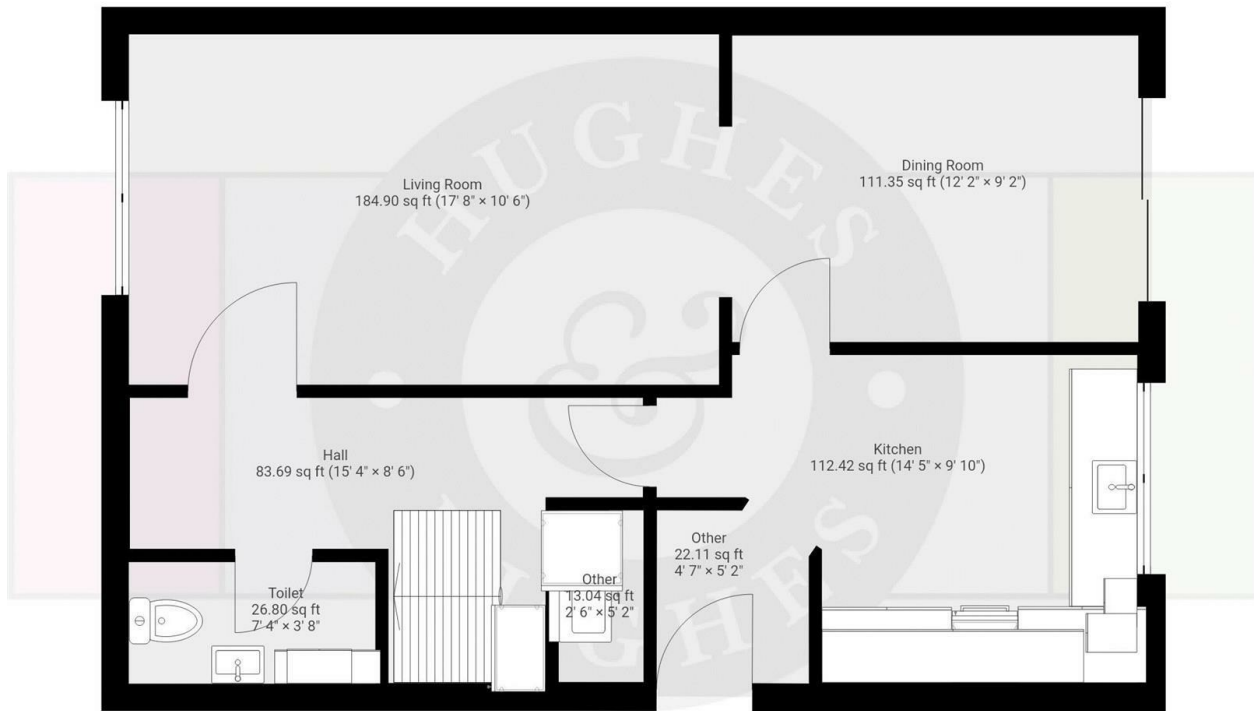

|., 624 Semington Road, Melksham, Wiltshire, SN12 6DN

Asking Price £367,500

- *NO ONWARD CHAIN*
- Blank Canvas with Potential
- Ample off street parking and garage
- Four Generously Sized Bedrooms, Including a Main bedroom with an Ensuite Shower Room
- Utility Room, ideal for household storage and functionality
- Really Good Sized Flat Rear Garden
- Bright and Airy Throughout



THIS FLOORPLAN IS PROVIDED WITHOUT WARRANTY OF ANY KIND. SENSOPIA DISCLAIMS ANY WARRANTY INCLUDING, WITHOUT LIMITATION, SATISFACTORY QUALITY OR ACCURACY OF DIMENSIONS.

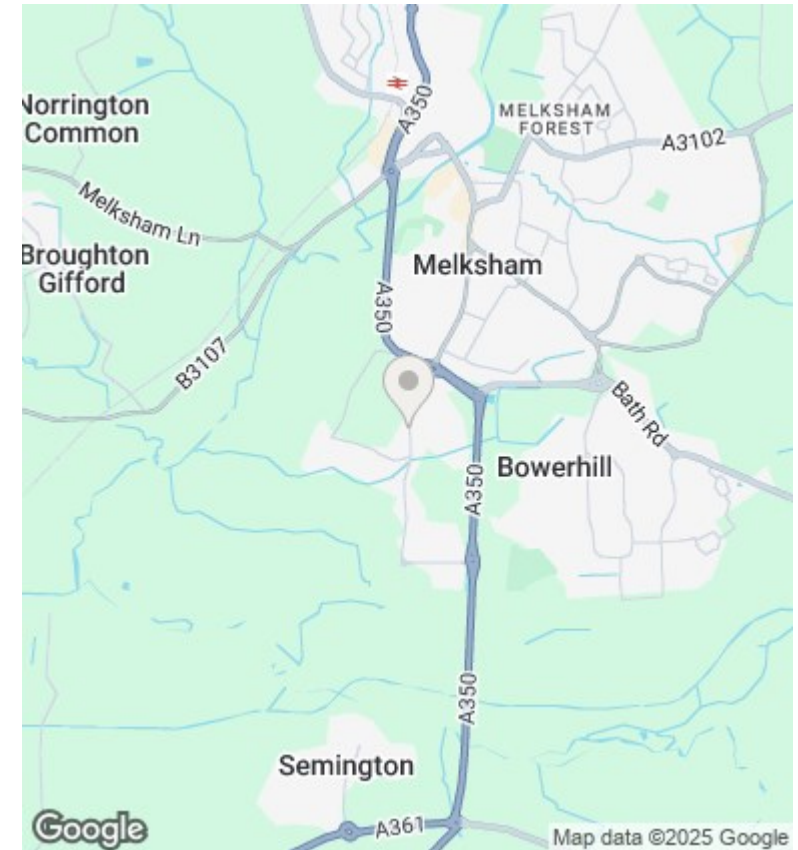

Directions

Viewings

Viewings by arrangement only. Call 01249 466999 to make an appointment.

Council Tax Band

EPC Rating:

Energy Efficiency Rating		
	Current	Potential
Very energy efficient - lower running costs		
(92 plus) A		
(81-91) B		
(69-80) C		
(55-68) D		
(39-54) E		
(21-38) F		
(1-20) G		
Not energy efficient - higher running costs		
England & Wales	EU Directive 2002/91/EC	