





£325,000

To View:

Holland & Odam

3 Farm Road, Street

Somerset, BA16 0BJ

01458 841411

street@hollandandodam.co.uk



3



2



2

Energy
Rating

D

Council Tax Band C



Services

Mains electricity, gas, water and drainage are connected. Gas central heating system.

Local Authority

Somerset Council

03001232224

somerset.gov.uk

Tenure

Freehold

Directions

From the High Street turn right into Leigh Road passing the Library on the left. On reaching the 'T' junction, turn right into Middle Leigh and then first left into Ivythorn Road. Continue into Overleigh and as the road bears sharp left, turn right into Middle Brooks. Follow the road passing Goss Drive on the right and the property can be found on the right hand side and easily identified by our for sale board.

Description

A well-presented and extended three-bedroom home in a popular and established area of Street. Featuring a superb modern kitchen, rear dining room extension, and spacious sitting room. The layout also includes a utility, ground floor shower room. Outside, is a lovely large side and rear garden with veranda, garage, and off-road parking.

A side entrance door opens into the hallway, where stairs rise to the first floor and glazed double doors lead into a bright and welcoming sitting room. This room features a front-facing window and a central fireplace, with a glazed oak door opening into the spacious kitchen. This light-filled open-plan room has been beautifully updated to combine two rooms into one, fitted with a modern range of wall, base, and drawer units, and includes an integrated dishwasher with space for a gas or electric range cooker. Beyond the kitchen lies a rear extension forming a generous dining room, complete with sliding patio doors that open out to the garden. Off the kitchen, a useful utility area provides additional space for an upright fridge freezer, washing machine, and tumble dryer, with a side door leading to the garden. There are further doors into a deep storage cupboard and a ground floor shower room with WC.

Upstairs, the landing has a side window providing natural light, with panelled doors leading to three bedrooms and the family bathroom. Bedroom one includes a large built-in wardrobe and overlooks the rear garden, while bedrooms two and three enjoy a front-facing aspect, the latter including an over-stairs cupboard. The bathroom is fitted with a modern white suite including a panelled bath with shower over, pedestal wash basin, and WC.

Location

The property is situated on the southern outskirts of Street approximately 1.75 miles from the High Street. Street is a busy mid Somerset town famous as the home of prestigious Millfield School, Clarks Shoes and now a popular shopping destination with Clarks Village retail centre. Street provides a theatre/cinema, Strode College, indoor and open air swimming pools, bowls club, health centre, library and a choice of pubs and eating places. M5 Junction 23 12 miles, A303 (Podimore roundabout) 12 miles, Castle Cary Train station (London Paddington) 12.5 miles, Historic town of Glastonbury 2.5 miles, City of Wells 9 miles, Bristol 33 miles, Bath 27 miles. (all mileages are approximate)





The property is set back behind a lawned front garden, with a central pathway leading to the entrance door and a gate providing side access to the garden. The side garden and patio enjoy a good degree of privacy and seclusion, making it an ideal spot for morning coffee or evening relaxation. This in turn opens into a generous rear garden, where a practical covered veranda provides shelter above a raised decked area, perfect for outdoor dining or entertaining. Beyond, the lawn offers plenty of space for children to play or for keen gardeners to enjoy, with planting borders and mature hedging adding to the sense of privacy. A single garage, accessed via Ash Road, includes parking for one vehicle and a pedestrian door directly into the garden.

- Extended three-bedroom semi-detached home offering a versatile layout, including a bright open-plan kitchen and dining area, perfect for modern family living or entertaining guests.
- Spacious sitting room with a large front-facing window that draws in natural light, a central feature fireplace, and glazed oak door leading to the kitchen.
- Stylish, updated kitchen fitted with a modern range of wall, base, and drawer units, integrated dishwasher, and space for a gas or electric range cooker.
- Generous rear dining room extension with sliding patio doors opening directly onto the garden, creating a seamless indoor-outdoor connection ideal for summer dining.
- Practical ground floor utility area with space for washing machine, tumble dryer, and fridge freezer, plus deep store cupboard and a modern downstairs shower room with WC.
- Enclosed rear garden with covered veranda over a raised deck, leading to a lawned area with mature borders, offering a sunny, space for relaxing, gardening, or entertaining.
- Detached single garage with off-road parking accessed via Ash Road, featuring a pedestrian door to the garden, and a side patio with gated access from the front of the property.



GROUND FLOOR
768 sq.ft. (71.4 sq.m.) approx.

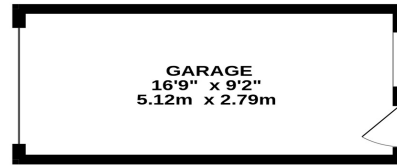

1ST FLOOR
402 sq.ft. (37.3 sq.m.) approx.

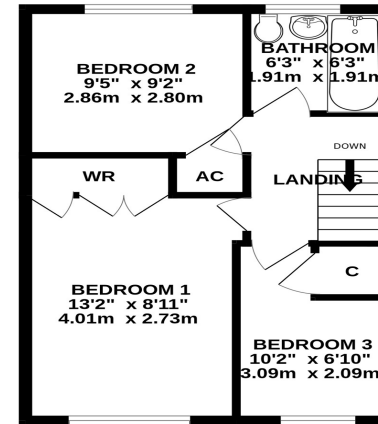
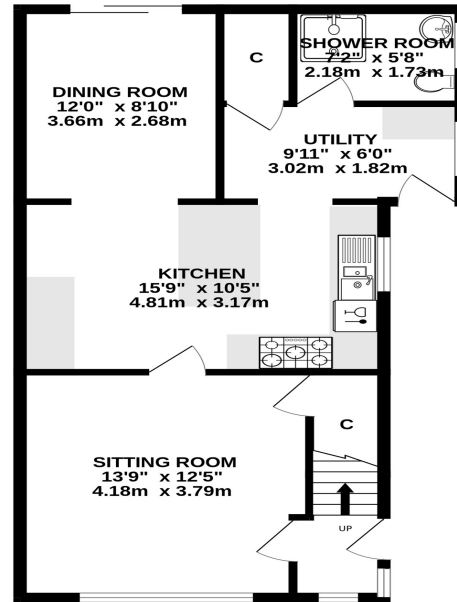

TOTAL FLOOR AREA: 1170 sq.ft. (108.7 sq.m.) approx.

Whilst every attempt has been made to ensure the accuracy of the floorplan contained here, measurements of doors, windows, rooms and any other items are approximate and no responsibility is taken for any error, omission or mis-statement. This plan is for illustrative purposes only and should be used as such by any prospective purchaser. The services, systems and appliances shown have not been tested and no guarantee as to their operability or efficiency can be given.
Made with Metropix ©2025

RESIDENTIAL LETTINGS : Holland & Odam offer a comprehensive residential lettings service. Whether you are a landlord or a tenant, please contact any of our offices to discuss your requirements.

FINANCIAL SERVICES : Would you like to have the opinion of a fully Independent Financial Adviser who has access to the entire mortgage market place and could help you consider all aspects of financing your proposed purchase? If so, please ring us on 01458 841411 and we can arrange a free consultation for you at a time and a place to suit you with The Levels Financial. *

CONSUMER PROTECTION FROM UNFAIR TRADING REGULATIONS 2008 : The Agent has not tested any apparatus, equipment, fixtures and fittings or services and so cannot verify that they are in working order or fit for the purpose. A Buyer is advised to obtain verification from their Solicitor or Surveyor. References to the Tenure of a Property are based on information supplied by the Seller. The Agent has not had sight of the title documents. A Buyer is advised to obtain verification from their Solicitor. Items shown in photographs are not included unless specifically mentioned within the sales particulars. They may however be available by separate negotiation. Buyers must check the availability of any property and make an appointment to view before embarking on any journey to see a property.

DATA PROTECTION : Personal information provided by customers wishing to receive information and/or services from the estate agent and the Property Sharing Experts (of which it is a member) for the purpose of providing services associated with the business of an estate agent but specifically excluding mailing or promotions by a third party. If you do not wish your personal information to be used for any of these purposes, please notify us.

*YOUR HOME MAY BE REPOSSESSED IF YOU DO NOT KEEP UP REPAYMENTS ON YOUR MORTGAGE OR ANY OTHER DEBT SECURED ON IT. WRITTEN QUOTATIONS ARE AVAILABLE ON REQUEST.