

**Willow Lodge, Barnet Lane
Elstree
WD6 3QZ**



Willow Lodge is a simply stunning 6114 Sft/ 567.9 Sq m detached chalet style residence arranged over two floors boasting Six Bedrooms, Four bathrooms (3 en-suite), Four Reception Rooms plus a superb galleried mezzanine library.

This deceptively spacious and beautifully presented home is set within secluded and well maintained landscaped gardens, accessed via a private gated entrance, double Integral Garage and is situated in the desirable area of Elstree, surrounded by open countryside and mature woodland.

The property has been interior designed to the highest specification and finish including a unique bespoke 'Pininfarina' Italian designer kitchen. The property offers bright and open accommodation ideal for formal entertaining whilst also providing generous family living space surrounded by beautifully manicured gardens & grounds.































52a The Broadway, Mill Hill, London NW7 3LH
t. 020 8959 9191 f. 020 8959 9292
e. enquiries@richardjames.biz w. www.richardjames.biz



Barnet Lane, Elstree , WD6

Approximate Area = 6114 sq ft / 567.9 sq m (includes garage & excludes void)

For identification only - Not to scale

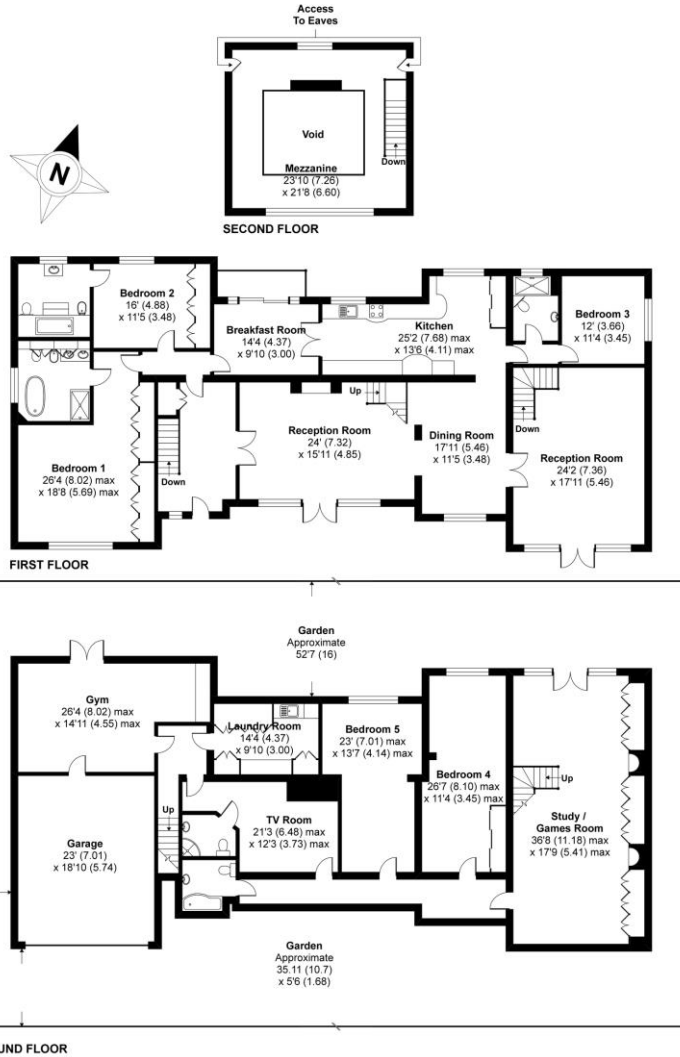

Floor plan produced in accordance with RICS Property Measurement Standards incorporating International Property Measurement Standards (IPMS2 Residential). © richcom 2020. Produced for Fresco Residential. REF: 650220

TERMS

TENURE : Freehold

BOROUGH : Barnet

PRICE : £2,595,000 Subject to Contract

As agents we have not tested any apparatus, equipment, fixtures, fittings or services, and so cannot verify that they are in working order or fit for the purpose. As a buyer you are advised to obtain verification from your Solicitor/Conveyancer or Surveyor, if there are any points of particular importance to you. Reference to the tenure of the property is based on information given to us by the seller, as we well not have had sight of the title documents. You are advised to obtain verification from your Solicitor/Conveyancer. Before viewing a property, do please check with us as to its availability, and also request clarification or information on any points of particular interest to you, to save you any possible wasted journeys. Also, photographs are for illustration only and may depict items which are not for sale or included in the sale of the property. All sizes are approximate; all dimensions include wardrobe space where applicable. While we believe that the area of the property has been accurately calculated, any prospective buyer who considers this feature to be particular important is strongly recommended to have the site measurements checked by their own surveyor before submitting an offer to purchase.