



Wentworth Close, Hull, HU10 6NN  
£185,000

  
**Philip  
Bannister**  
Estate & Letting Agents



# Wentworth Close, Hull, HU10 6NN

Situated in a quiet yet popular Willerby cul-de-sac, this well-maintained two-bedroom semi-detached bungalow is offered with no onward chain. The property features off-street parking, a garage, and a low-maintenance rear garden, with scope to update and personalise to taste.

## Key Features

- No Onward Chain
- 2 Bedrooms
- Scope To Improve
- Highly Sought-After Location
- Drive & Garage
- Early Viewing A Must
- EPC =

| Energy Efficiency Rating                    |         |           |
|---|---------|-----------|
|   | Current | Potential |
| Very energy efficient - lower running costs |         |           |
| (92 plus) A                                 |         |           |
| (81-91) B                                   |         |           |
| (69-80) C                                   |         |           |
| (55-68) D                                   | 66      | 77        |
| (39-54) E                                   |         |           |
| (21-38) F                                   |         |           |
| (1-20) G                                    |         |           |
| Not energy efficient - higher running costs |         |           |
| England & Wales                             |         |           |
| EU Directive 2002/91/EC                     |         |           |

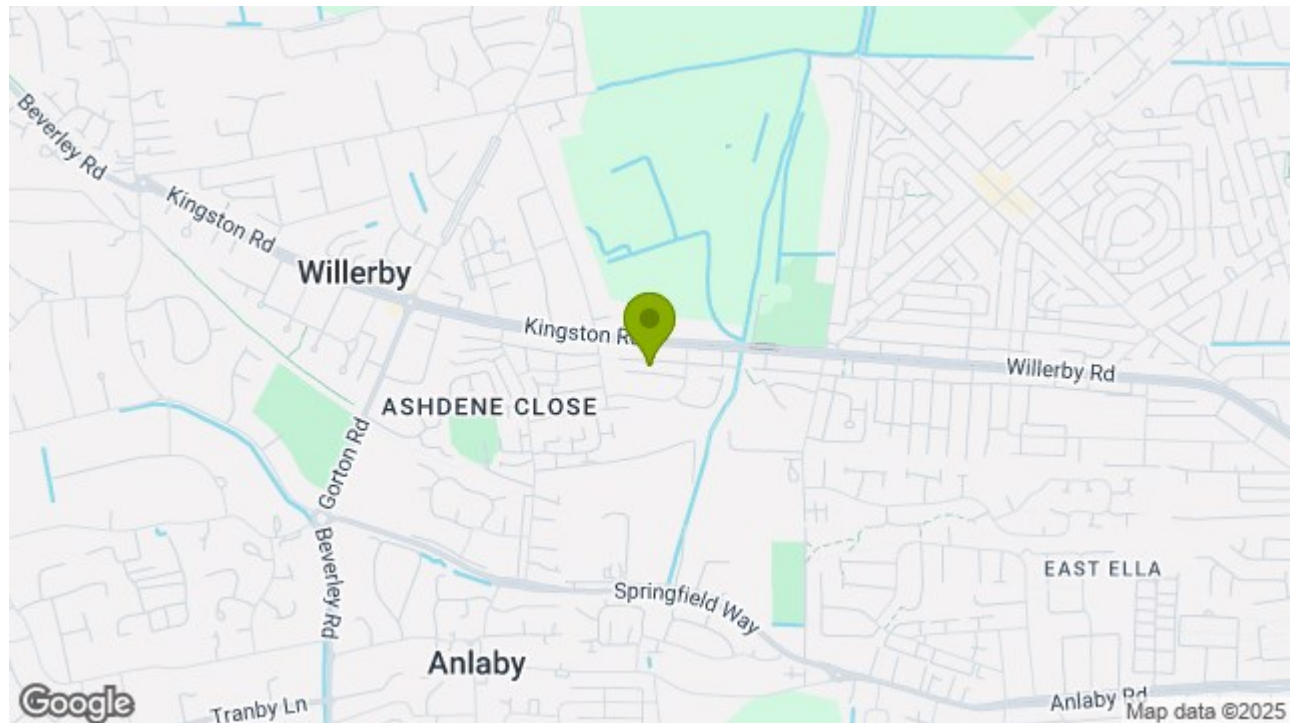







## **WILLERBY**

Willerby is an East Riding of Yorkshire village located on the Western outskirts of the City of Kingston upon Hull. Located approximately 5 miles West of Kingston upon Hull and approximately 8 miles from the historic market town of Beverley. Motorway access can be located via the A63/M62 with further trunk routes located over the Humber Bridge. Willerby/Kirk Ella have two primary schools; St Andrews in Kirk Ella and Carr Lane in Willerby, with the secondary school located in Willerby. Hymers College and Hull Collegiate are within driving distance. There are a range of shopping facilities in Willerby; Waitrose, Aldi, Lidl, Iceland with other retail outlets. Anlaby retail park is within close proximity with a further range of amenities.

## **ACCOMMODATION;**

### **BREAKFAST KITCHEN**

A fitted kitchen with ample wall and base units, laminate work surfaces and a tiled splashback. With space for a Cooker, plumbing for an Automatic Washing Machine, windows to the side and front elevation and ample dining space.

### **LIVING ROOM**

A generous living space with feature fireplace housing a gas fire and a window to the front elevation.

### **BEDROOM 1**

A bedroom of double proportions with fitted wardrobes, overhead cupboards and chest of drawers.

### **BEDROOM 2**

A generous single bedroom with sliding doors leading to the rear garden.

### **BATHROOM**

With a three piece suite comprising of a panelled bath with shower attachment, low flush WC and a wash hand basin. Further benefitting from tiled walls, a radiator and a window to the side elevation.

## **EXTERNAL;**

### **FRONT**

With block paved frontage and a side drive providing ample off-street parking.

### **REAR**

Low maintenance rear garden, with block paving and timber fencing.

### **GARAGE**

Detached single garage with up and over door, light and power supply.

## **GENERAL INFORMATION**

SERVICES - Mains water, electricity, gas and drainage are connected to the property.

CENTRAL HEATING - The property has the benefit of a gas fired central heating system to panelled radiators.

DOUBLE GLAZING - The property has the benefit of replacement PVC double glazed frames OR The property has the benefit of sealed unit

double glazing.

SECURITY - The property has the benefit of an installed burglar alarm system.

COUNCIL TAX - From a verbal enquiry/online check we are led to believe that the Council Tax band for this property is Band . (East Riding Of Yorkshire/ Hull City Council). We would recommend a purchaser make their own enquiries to verify this.

VIEWING - Strictly by appointment with the sole agents.

FIXTURES & FITTINGS - Carpets, curtains & light fittings may be purchased with the property and these will be specified upon inspection but would be subject to separate negotiation.

## **AML**

Please be advised that when you agree to purchase a property, we are legally required under the Money Laundering, Terrorist Financing and Transfer of Funds (Information on the Payer) Regulations 2017 to obtain copies of your identification. Your ID and relevant personal data will be shared with our verification platform, Movebutler T/A IAMPROPERTY, to fulfil these legal obligations. If you do not wish for your data to be processed in this way, please inform the sales consultant handling your offer in writing as soon as possible.

## **TENURE**

We understand that the property is Freehold.

## **MORTGAGES**

The mortgage market changes rapidly and it is vitally important you obtain the right advice regarding the best mortgage to suit your circumstances.

We are able to offer professional independent Mortgage Advice without any obligation. A few minutes of your valuable time could save a lot of money over the period of the Mortgage. Professional Advice will be given by Licensed Credit Brokers. Written quotations on request. Your home is at risk if you do not keep up repayments on a mortgage or other loan secured on it.

## **THINKING OF SELLING?**

We would be delighted to offer a FREE - NO OBLIGATION appraisal of your property and provide realistic advice in all aspects of the property market. Whether your property is not yet on the market or you are experiencing difficulty selling, all appraisals will be carried out with complete confidentiality.

## **AGENTS NOTES**

Philip Bannister & Co.Ltd for themselves and for the vendors or lessors of this property whose agents they are give notice that (i) the particulars are set out as a general outline only for the guidance of intending purchasers or lessees, and do not constitute any part of an offer or contract (ii) all descriptions, dimensions, references to condition and necessary permissions for use and occupation, and other details are given in good faith and are believed to be correct and any intending purchaser or tenant should not rely on them as statements or representations of fact but must satisfy themselves by inspection or otherwise as to the correctness of each of them (iii) no person in the employment of Philip Bannister & Co.Ltd has any authority to make or give any representation or warranty whatever in relation to

this property. If there is any point which is of particular importance to you, please contact the office and we will be pleased to check the information, particularly if you contemplate travelling some distance to view the property.

Philip Bannister & Co.Ltd advise they do not test fitted appliances, electrical and plumbing installation or central heating systems, nor have they undertaken any type of survey on this property. These particulars are issued on the strict understanding that all negotiations are conducted through Philip Bannister & Co.Ltd. And prospective purchasers should check on the availability of the property prior to viewing, Photograph Disclaimer - In order to capture the features of a particular room we will mostly use wide angle lens photography. This will sometimes distort the image slightly and also has the potential to make a room look larger. Please therefore refer also to the room measurements detailed within this brochure.

In compliance with NTSTERT Guidance on Referral Fees, the agent confirms that vendors and prospective purchasers will be offered estate agency and other allied services for which certain referral fees/commissions may be made available to the agent. Services the agent and/or a connected person may earn referral fees/commissions from Financial Services, Conveyancing and Surveys. Typical Financial Services referral fee KC Mortgages £200, Typical Conveyancing Referral Fee: Graham & Rosen £150 (£125+VAT). Hamers £120 (£100+VAT), Lockings Solicitors £120 (£100+VAT), Eden & Co £180 (£150.00+VAT)







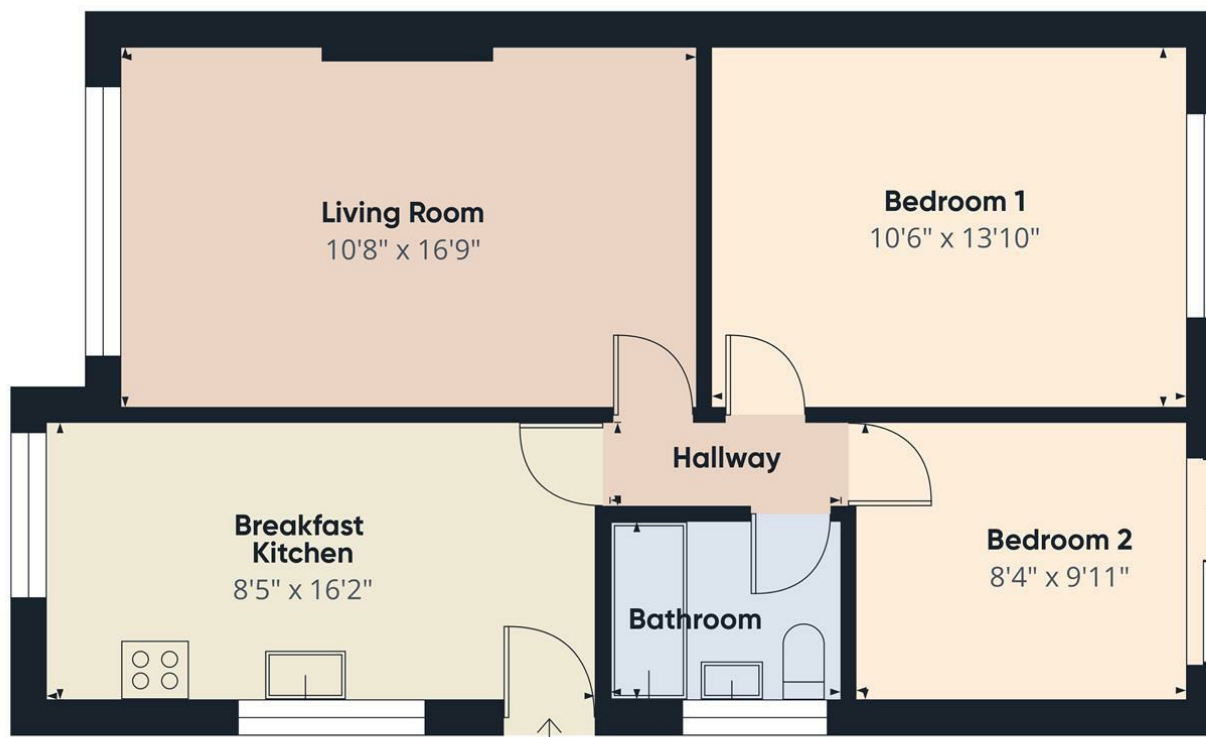

Approximate total area<sup>m</sup>  
608 ft<sup>2</sup>

(1) Excluding balconies and terraces

Calculations reference the RICS IPMS 3C standard. Measurements are approximate and not to scale. This floor plan is intended for illustration only.

GIRAFFE360



58 Hull Road, Hessle, Hull, East Yorkshire, HU13 0AN  
Tel: 01482 649777 | Email: [info@philipbannister.co.uk](mailto:info@philipbannister.co.uk)  
[www.philipbannister.co.uk](http://www.philipbannister.co.uk)

  
Estate & Letting Agents