



Bannister Close, Hesse, HU13 0BP
£150,000

Philip
Bannister
Estate & Letting Agents

Bannister Close, Hessle, HU13 0BP

A wonderful family home in the heart of Hessle. This property has been fully refurbished from top to bottom leaving no stone unturned featuring a brand new bathroom, new carpets and freshly decorated throughout. Benefitting from generous living space, 3 well proportioned bedroom plus a converted loft (not to regulations). This property is certainly one not to miss.

Key Features

- Perfect Family Home
- Recently Renovated Throughout
- 3 Bedrooms + Loft Room
- Corner Plot
- Fabulous Rear Garden
- Generous Living Accommodation
- Popular Location
- EPC =
- No Onward Chain
- Ideal Starter Home

Energy Efficiency Rating		
	Current	Potential
Very energy efficient - lower running costs		
(92 plus) A		
(81-91) B		
(69-80) C		71
(55-68) D	60	
(39-54) E		
(21-38) F		
(1-20) G		
Not energy efficient - higher running costs		
England & Wales	EU Directive 2002/91/EC	

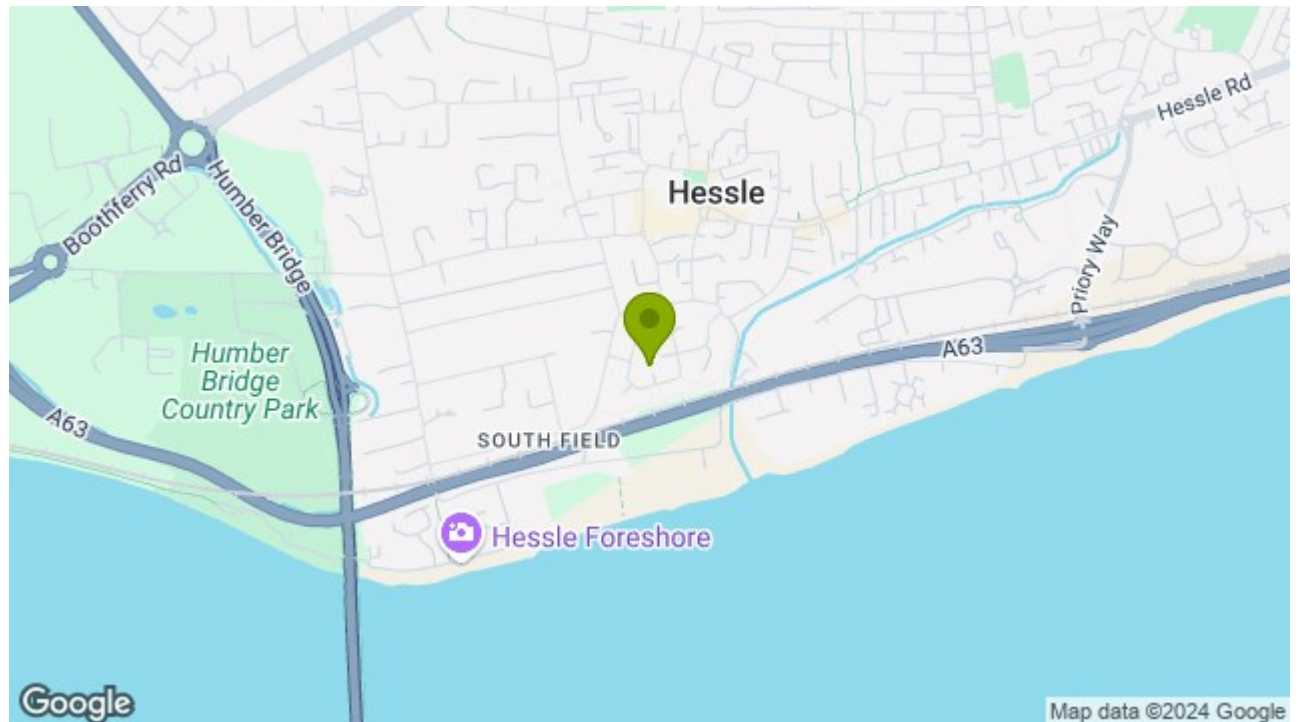



HESSLE

The Town of Hessle is well served for local amenities with first class shopping facilities available within the Town Centre, public transportation & local primary and secondary schools. Good road and rail connections are available with a local train station off Southfield, and the A63 dual carriageway running nearby to the South of the town, allowing convenient access to Hull City Centre and the national motorway network.

GROUND FLOOR;

ENTRANCE HALL

A pleasant entrance hall providing access to the accommodation.

UTILITY AREA

With plumbing for an automatic washing machine, under-stairs cupboard, window and door to the front elevation.

WC

With low flush WC, wash hand basin and a window to the front elevation.

KITCHEN

14'7 x 8'5 (4.45m x 2.57m)

A well equipped kitchen with white shaker wall and base units, granite effect work surfaces and tiled splashback. Integrated appliances include an Electric Double Oven, Electric Hob, Extractor Hood, under counter Fridge and a ceramic sink unit. Further benefitting from dining space, French doors and a window to the rear elevation.

LIVING ROOM

17'9 x 9 (5.41m x 2.74m)

A generous bay fronted living space with exposed brick fireplace and window to the rear elevation.

FIRST FLOOR;

BEDROOM 1

12'2 x 8'4 (3.71m x 2.54m)

A bedroom of double proportions with open storage cupboard and window to the front elevation.

BEDROOM 2

15 x 7'1 + wardrobes (4.57m x 2.16m + wardrobes)

A further double bedroom with sliding fitted wardrobes and a window to the rear elevation.

BEDROOM 3

11'7 x 5'4 (3.53m x 1.63m)

A generous single bedroom with window to the front elevation.

BATHROOM

Newly fitted bathroom with a three piece suite comprising of a panelled bath with overhead shower, low flush WC and a wash hand basin. Further benefitting from a heated towel rail, cupboard housing the boiler and a window to the rear elevation.

LOFT AREA

LOFT ROOM

24'6 x 10'11 (7.47m x 3.33m)

With fixed staircase, recessed spotlights, Velux window and eaves storage. (Not to building regulations).

EXTERNAL;

FRONT

To the front of the property is a brick-set forecourt with timber gate and fencing.

REAR

To the rear is a good sized garden laid mainly to turf with block paved patio area, timber fencing, a garden shed and a summerhouse.

GENERAL INFORMATION

SERVICES - Mains water, electricity, gas and drainage are connected to the property.

CENTRAL HEATING - The property has the benefit of a gas fired central heating system to panelled radiators.

DOUBLE GLAZING - The property has the benefit of replacement PVC double glazed frames OR The property has the benefit of sealed unit double glazing.

COUNCIL TAX - From a verbal enquiry/online check we are led to believe that the Council Tax band for this property is Band . (East Riding Of Yorkshire/ Hull City Council). We would recommend a purchaser make their own enquiries to verify this.

VIEWING - Strictly by appointment with the sole agents.

FIXTURES & FITTINGS - Carpets, curtains & light fittings may be purchased with the property and these will be specified upon inspection but would be subject to separate negotiation.

TENURE

We understand that the property is Freehold.

MORTGAGES

The mortgage market changes rapidly and it is vitally important you obtain the right advice regarding the best mortgage to suit your circumstances.

We are able to offer professional independent Mortgage Advice without any obligation. A few minutes of your valuable time could save a lot of



money over the period of the Mortgage. Professional Advice will be given by Licensed Credit Brokers. Written quotations on request. Your home is at risk if you do not keep up repayments on a mortgage or other loan secured on it.

THINKING OF SELLING?

We would be delighted to offer a FREE - NO OBLIGATION appraisal of your property and provide realistic advice in all aspects of the property market. Whether your property is not yet on the market or you are experiencing difficulty selling, all appraisals will be carried out with complete confidentiality.

AGENTS NOTES

Philip Bannister & Co.Ltd for themselves and for the vendors or lessors of this property whose agents they are give notice that (i) the particulars are set out as a general outline only for the guidance of intending purchasers or lessees, and do not constitute any part of an offer or contract (ii) all descriptions, dimensions, references to condition and necessary permissions for use and occupation, and other details are given in good faith and are believed to be correct and any intending purchaser or tenant should not rely on them as statements or representations of fact but must satisfy themselves by inspection or otherwise as to the correctness of each of them (iii) no person in the employment of Philip Bannister & Co.Ltd has any authority to make or give any representation or warranty whatever in relation to this property. If there is any point which is of particular importance to you, please contact the office and we will be pleased to check the information, particularly if you contemplate travelling some distance to view the property. Philip Bannister & Co.Ltd advise they do not test fitted appliances, electrical and plumbing installation

or central heating systems, nor have they undertaken any type of survey on this property. These particulars are issued on the strict understanding that all negotiations are conducted through Philip Bannister & Co.Ltd. And prospective purchasers should check on the availability of the property prior to viewing, Photograph Disclaimer - In order to capture the features of a particular room we will mostly use wide angle lens photography. This will sometimes distort the image slightly and also has the potential to make a room look larger. Please therefore refer also to the room measurements detailed within this brochure.

In compliance with NTSEAT Guidance on Referral Fees, the agent confirms that vendors and prospective purchasers will be offered estate agency and other allied services for which certain referral fees/commissions may be made available to the agent. Services the agent and/or a connected person may earn referral fees/commissions from Financial Services, Conveyancing and Surveys. Typical Financial Services referral fee KC Mortgages £200, Typical Conveyancing Referral Fee: Graham & Rosen £150 (£125+VAT). Hamers £120 (£100+VAT), Lockings Solicitors £120 (£100+VAT), Eden & Co £180 (£150.00+VAT)



GROUND FLOOR
420 sq.ft. (39.0 sq.m.) approx.



1ST FLOOR
409 sq.ft. (38.0 sq.m.) approx.



2ND FLOOR
243 sq.ft. (22.6 sq.m.) approx.

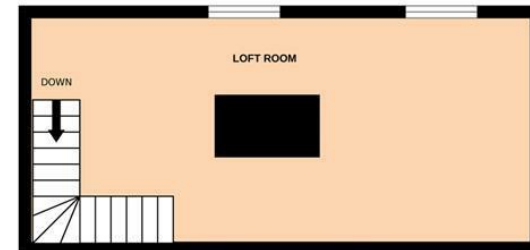

TOTAL FLOOR AREA : 1072 sq.ft. (99.6 sq.m.) approx.

Whilst every attempt has been made to ensure the accuracy of the floorplan contained here, measurements of doors, windows, rooms and any other items are approximate and no responsibility is taken for any error, omission or mis-statement. This plan is for illustrative purposes only and should be used as such by any prospective purchaser. The services, systems and appliances shown have not been tested and no guarantee as to their operability or efficiency can be given.
Made with Metropix ©2024

