



Roseberry Cottage, Church Street, Malpas, SY14 7FG

Helping *you* move



Roseberry Cottage, Church Street, Malpas, SY14 7FG

Asking Price Of £415,000



- Exceptional Mid Terrace House
- Three Double Bedrooms
- Popular Village Location with excellent amenities
- Immaculately Presented Throughout

- Master En Suite and Family Bathroom
- Superb Open Plan Kitchen/Diner
- Rear Courtyard and Off Road Parking
- EPC B, Council Tax Band D



This beautifully presented three bedroom mid terrace house is finished to an exceptionally high standard, offering contemporary living in the bustling village of Malpas known for its excellent range of amenities and highly regarded primary and secondary schools. The property boasts modern features throughout, including underfloor heating on the ground floor with radiators upstairs, alarm system and motion sensor lighting in the hall, cloakroom and bathrooms.

Upon entering, you are greeted by a stylish Entrance Hall with tiled floor and under-stairs storage cupboard with power points and shelving. The hallway leads to a spacious Lounge and an open plan Kitchen/Diner. The kitchen comes fully equipped with wooden shaker style units, marble worktops and integrated appliances including a Samsung self-cleaning oven and a Samsung combination oven. The dining area features elegant French doors that open onto the rear garden. A handy Cloakroom completes the ground floor layout.





Upstairs, the first floor comprises three generously sized double bedrooms, including a master bedroom with fitted wardrobes and an ensuite shower room. The family bathroom is tastefully finished and includes an over-bath shower with bi-fold screen. Both the ensuite and family bathroom have fitted mirrors with LED lighting, and the ensuite also has fitted wall units. All rooms, both upstairs and downstairs, have ample stylish downlighters and the property benefits from useful storage space in a boarded loft, accessed by drop down loft ladder.



Outside, the rear garden includes a paved patio area, ideal for relaxing and there is also a timber shed and private, gated off road parking to the rear for up to three vehicles with space for two vehicles inside the gates and an additional space outside. There is also a separate, private and fully secure bin store just 20 meters from the property. This stunning home offers the perfect mix of style, comfort and practicality in a popular village setting, situated on Church Street, the historic and much sought after Malpas thoroughfare.



Helping *you* move

LOCATION

Situated in Malpas which is a busy village in South West Cheshire, it enjoys the benefits of several schools with excellent Ofsted reports, restaurants and pubs, and a selection of shops. Whitchurch is 5 miles away and is a busy historical market town which sits on the Shropshire/Cheshire/Clwyd borders and benefits from a variety of local independent shops, schools, four large supermarkets and other major retailers. The renowned Hill Valley Hotel, Golf & Spa is located on the outskirts of the town which offers great recreational facilities. Whitchurch train station is on a direct line between Crewe and Shrewsbury with onward connections to Manchester, Birmingham and London plus other major cities. The larger centres of Chester, Shrewsbury, Telford, Wrexham and Crewe are all within 16 to 22 miles approximately.

TENURE

We are advised that the property is Freehold and this will be confirmed by the Vendors Solicitor during pre-contract enquiries. Vacant possession upon completion.

MANAGEMENT COMPANY

We are advised that there is a management company set up for the maintenance of the communal areas and the cost for this will be approximately £200-£250 per annum once the works at the development are complete. This will be confirmed by the vendor's solicitor during the pre-contract enquiries.

AGENTS NOTE

We are advised that caravans cannot be parked at the property. This will be confirmed by solicitors during the pre-contract enquiries.

SERVICES

We are advised that mains water, drainage, gas and electricity are available. Barbers have not tested any apparatus, equipment, fittings etc. or services to this property, so cannot confirm that they are in working order or fit for purpose. A buyer is recommended to obtain confirmation from their Surveyor or Solicitor.

DIRECTIONS

From Whitchurch take the A41 in Chester direction into Grindley Brook. Turn left at the Horse and Jockey public house and follow the B5395 to Malpas. Turn left into Church Street, continue on and the property can be found after a short distance on the left hand side.

PROPERTY INFORMATION

We believe this information to be accurate, but it cannot be guaranteed. The fixtures, fittings, appliances and mains services have not been tested. If there is any point which is of particular importance please obtain professional confirmation. All measurements quoted are approximate. These particulars do not constitute a contract or part of a contract.

ENERGY PERFORMANCE

EPC B. The full energy performance certificate (EPC) is available for this property upon request.

LOCAL AUTHORITY

Council Tax Band D. Cheshire West & Chester, The Forum, Chester, CH1 2HS. Council Tax enquiries 0300 123 7022.

VIEWING

Please ring us on 01948 667272 or Email: whitchurch@barbers-online.co.uk

METHOD OF SALE

For sale by Private Treaty.

AML REGULATIONS

To ensure compliance with the latest Anti Money Laundering Regulations all intending purchasers must produce identification documents prior to the issue of sale confirmation. To avoid delays in the buying process please provide the required documents as soon as possible.

WH36598300924



- LOUNGE
19' 0" x 12' 4" (5.79m x 3.76m)
- KITCHEN/DINER
21' 4" x 14' 0" (6.5m x 4.27m)
- BEDROOM ONE
14' 1" x 11' 2" (4.29m x 3.4m)
- BEDROOM TWO
13' 9" x 12' 3" (4.19m x 3.73m)
- BEDROOM THREE
13' 0" x 8' 8" (3.96m x 2.64m) max

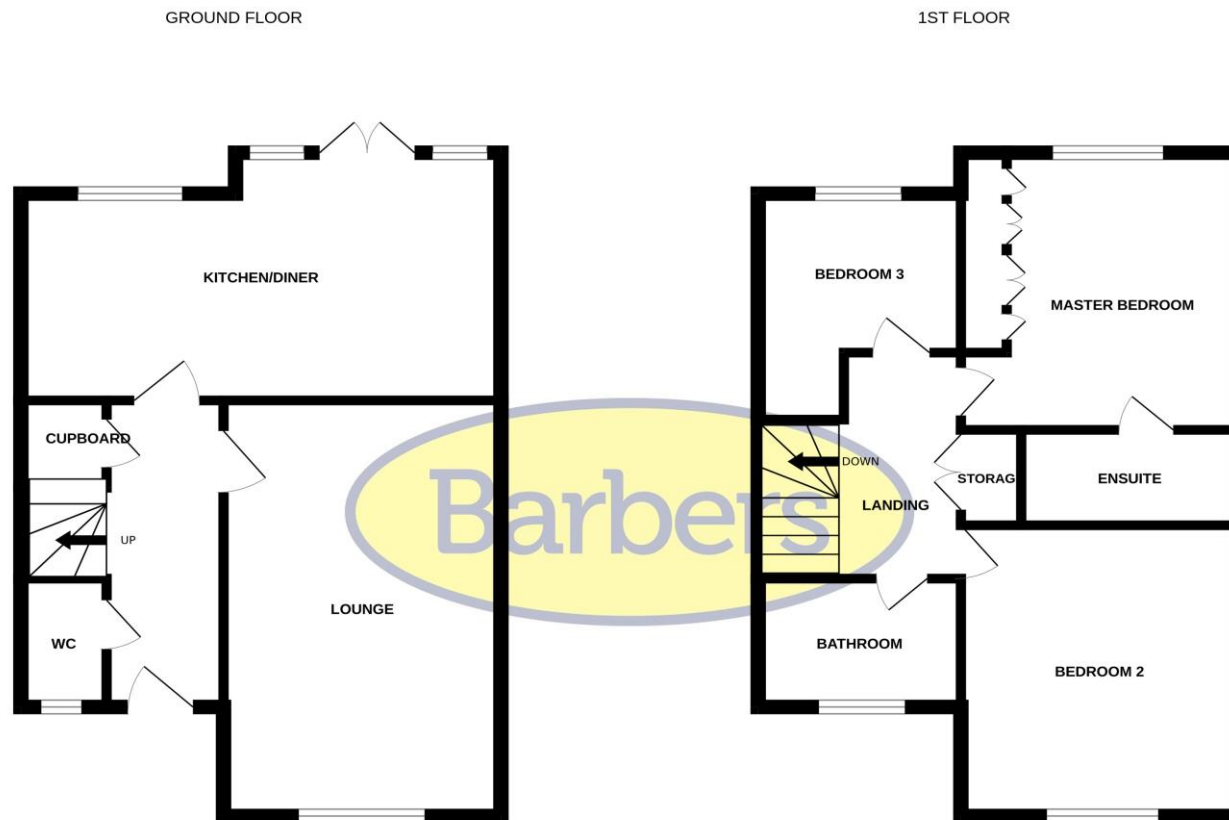

Whilst every attempt has been made to ensure the accuracy of the floorplan contained here, measurements of doors, windows, rooms and any other items are approximate and no responsibility is taken for any error, omission or mis-statement. This plan is for illustrative purposes only and should be used as such by any prospective purchaser. The services, systems and appliances shown have not been tested and no guarantee as to their operability or efficiency can be given.
Made with Metropix ©2024



WHITCHURCH
34 High Street, Whitchurch, SY13 1BB | Tel: 01948 667272
Email: whitchurch@barbers-online.co.uk
www.barbers-online.co.uk

MARKET DRAYTON
NEWPORT
SHREWSBURY
WELLINGTON/TELFORD
WHITCHURCH