



9 Meridian Road, BS6 6EG

Redland





Positioned on a very popular tree lined residential road in Redland, this superb one bedroom top floor flat is an ideal first home or investment.

The flat is in a very good location. Hugely convenient for Whiteladies Road as well as the city centre which is about 15 minutes away on foot. The Downs, Clifton Village and Gloucester Road are also all within walking distance.

Being sold with no onward chain.

- Well presented one double bedroom flat
- Superb location with so many fantastic amenities close by
- Gas central heating
- Tenure - Leasehold
- Energy rating - D
- Circa 419 sqft (taken from EPC)



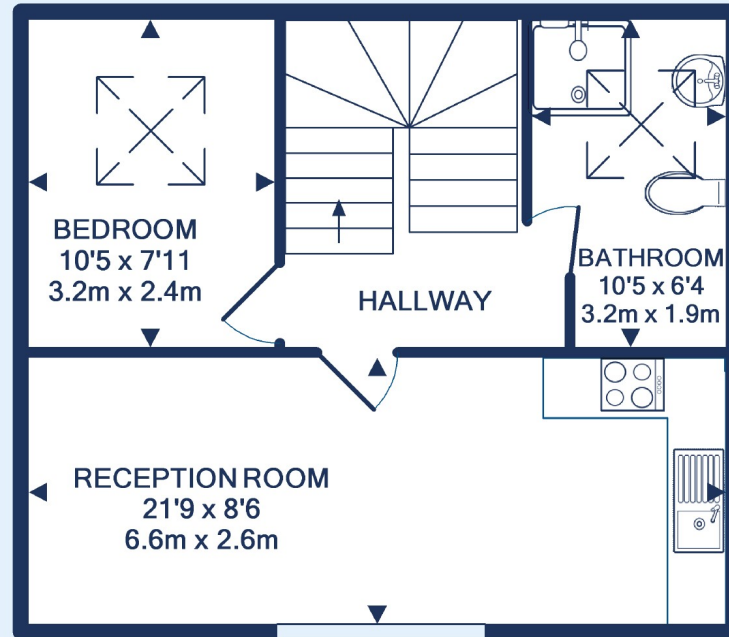
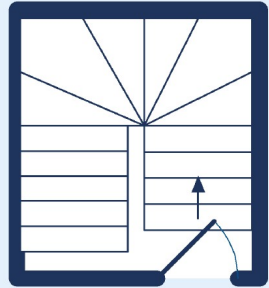

Made with Metropix ©2021

## Accommodation

### Living Area

A long open plan living space with a warm, homely feel and a large dormer window that allows a lot of light in to the room.

### Kitchen

A really stylish and well fitted kitchen with plenty of storage.

### The Bedroom

A comfortable double bedroom with a large Velux window and ample space for storage furniture.

### Bathroom

A very good size and really well fitted bathroom with a lovely walk in shower. There is also plumbing for the washing machine meaning all the noise is taken away from the living area.





## Redland - Guide price £200,000

### 1 Bed Flat

References to the Tenure of a Property are based on information supplied by the Seller. The Agent has not had sight of the title documents. Lease details, service ground rent (where applicable) are given as a guide only and should be checked and confirmed by your solicitor prior to exchange of contracts.



#### Clifton Branch

187 Whiteladies Road, Clifton, Bristol, BS8 2RY

Call: 0117 9466007

Mail: [cliftonsales@oceanhome.co.uk](mailto:cliftonsales@oceanhome.co.uk)

Search: [www.oceanhome.co.uk](http://www.oceanhome.co.uk)