

EDEN MIDCALF  
— SALES & LETTINGS —

ASKING PRICE

£185,000

Rainsford Crescent

Worcestershire, DY10 2GF



## PROPERTY SUMMARY

A well appointed two bedroom 50% shared ownership terraced house within a popular location in Kidderminster. Overlooking a green area and offering a well proportioned layout which is "ready to move into", plus parking for two cars and a low maintenance rear garden. The property can also be purchased outright for £185,000 (Freehold).

2



1



1

















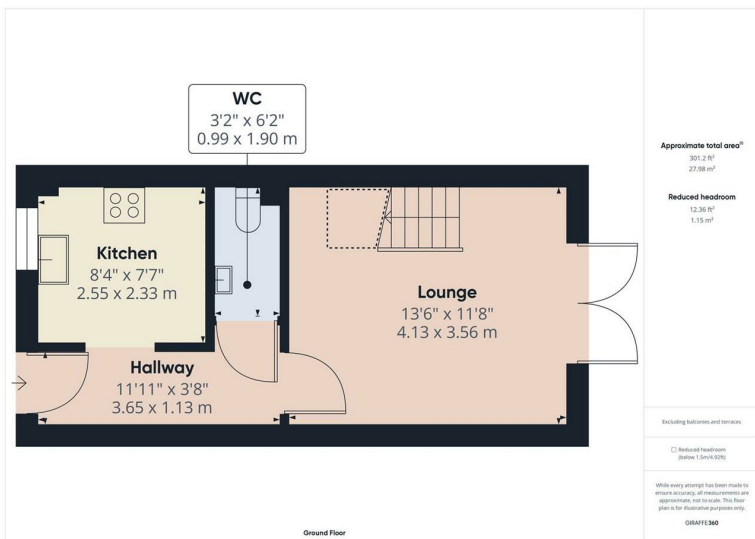

**LOCAL AUTHORITY**  
Wyre Forest District Council

**TENURE**  
Freehold

**COUNCIL TAX BAND**  
B

**VIEWINGS**  
By prior appointment only

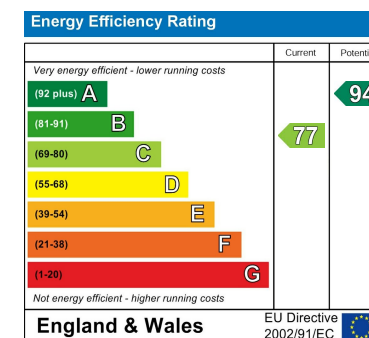

Agents Note: Whilst every care has been taken to prepare these particulars, they are for guidance purposes only. All measurements are approximate and are for general guidance purposes only and whilst every care has been taken to ensure their accuracy, they should not be relied upon and potential buyers/tenants are advised to recheck the measurements

**EDEN MIDCALF**  
— SALES & LETTINGS —

5 Load Street  
Bewdley  
DY12 2AF

01299 402392  
wyreforest@edenmidcalf.co.uk  
<https://www.edenmidcalf.co.uk/contact-us/>