

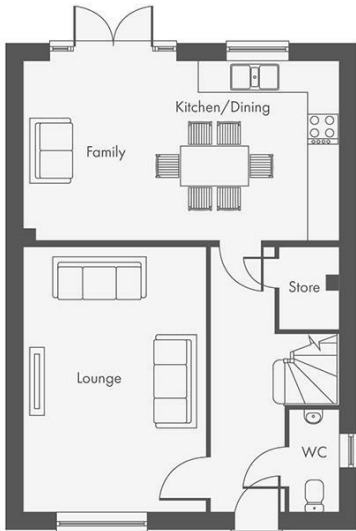

EDEN MIDCALF  
— SALES & LETTINGS —

£460,000  
Mortimer Manor  
Bewdley, DY12 1JQ



**BLACK FRIDAY  
OFFER  
UP TO 5% DEPOSIT  
PAID!**

**SAVE THOUSANDS  
ON ESTATE  
AGENTS FEES WITH  
OUR ASSISTED  
MOVE SCHEME**

Energy Efficiency Rating		Current	Potential
<i>Very energy efficient - lower running costs</i>			
(92 plus) <b>A</b>			
(81-91) <b>B</b>			
(69-80) <b>C</b>			
(55-68) <b>D</b>			
(39-54) <b>E</b>			
(21-38) <b>F</b>			
(1-20) <b>G</b>			
<i>Not energy efficient - higher running costs</i>			
<b>England &amp; Wales</b>		EU Directive 2002/91/EC 	

Agents Note: Whilst every care has been taken to prepare these particulars, they are for guidance purposes only. All measurements are approximate and are for general guidance purposes only and whilst every care has been taken to ensure their accuracy, they should not be relied upon and potential buyers/tenants are advised to recheck

 <p><b>EDEN MIDCALF</b> SALES &amp; LETTINGS</p>	<p>5 Load Street Bewdley DY12 2AF</p>	<p>01299 402392 wyreforest@edenmidcalf.co.uk <a href="https://www.edenmidcalf.co.uk/">https://www.edenmidcalf.co.uk/</a> us/</p>
---	---	--