



EDEN MIDCALF
— SALES & LETTINGS —

£595,000
The Racks, Bark Hill
Bewdley, DY12 2BD

PROPERTY SUMMARY

"Little Orchard" is a charming period three-bedroom detached cottage occupying approximately an acre, with a large gated driveway providing off road parking. Located in a wonderful secluded location in sought-after Bewdley, the property offers a spacious layout with many period-style features, plus two reception rooms, a conservatory extension, and a ground-floor bedroom, with an en-suite shower room. Set within very large and beautifully laid out south.-facing gardens, which include surrounding woodland/greenery.

3



2



2









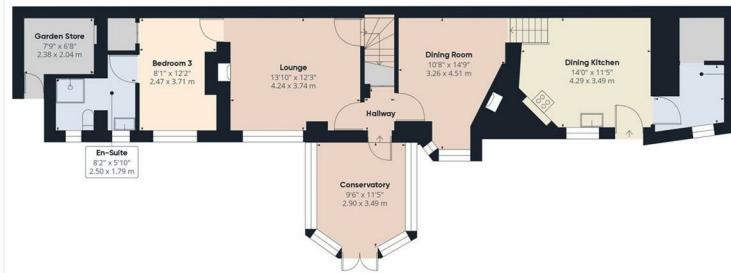

Approximate total area⁽¹⁾
901.8 ft²
83.78 m²

Reduced headroom
0.11 ft²
0.01 m²

(1) Excluding balconies and terraces

Reduced headroom
Below 5 ft/1.5 m

While every attempt has been made to ensure accuracy, all measurements are approximate, not to scale. This floor plan is for illustrative purposes only. Calculations are based on RICS IPMS 3C standard.

GIRAFFE360

Ground Floor

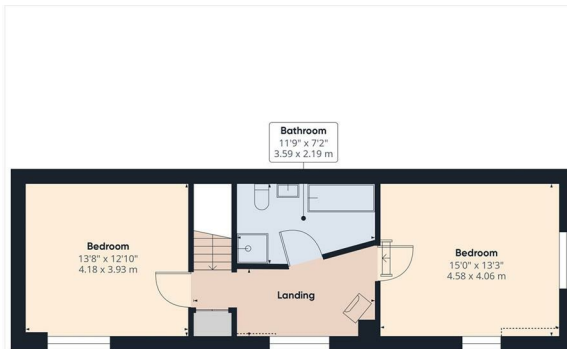

Approximate total area⁽¹⁾
545.51 ft²
50.68 m²

Reduced headroom
0.03 ft²
0.03 m²

(1) Excluding balconies and terraces

Reduced headroom
Below 5 ft/1.5 m

While every attempt has been made to ensure accuracy, all measurements are approximate, not to scale. This floor plan is for illustrative purposes only. Calculations are based on RICS IPMS 3C standard.

GIRAFFE360

Floor 1

LOCAL AUTHORITY
Wyre Forest District Council

TENURE
Freehold

COUNCIL TAX BAND
F

VIEWINGS
By prior appointment only

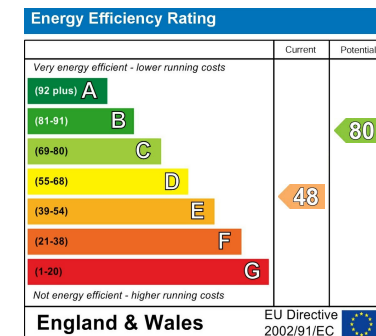

Agents Note: Whilst every care has been taken to prepare these particulars, they are for guidance purposes only. All measurements are approximate and are for general guidance purposes only and whilst every care has been taken to ensure their accuracy, they should not be relied upon and potential buyers/tenants are advised to recheck the measurements

EDEN MIDCALF
— SALES & LETTINGS —

5 Load Street
Bewdley
DY12 2AF

01299 402392
wyreforest@edenmidcalf.co.uk
<https://www.edenmidcalf.co.uk/contact-us/>