

EDEN MIDCALF
— SALES & LETTINGS —

£249,950
Cleobury Road

Bewdley, DY12 2PG

PROPERTY SUMMARY

A modern three bedroom semi-detached house just a short distance from the heart of Bewdley town and its excellent amenities. Offering a generously proportioned and well presented layout, including a spacious lounge / dining room and a ground floor WC. Including allocated resident off-road parking for two cars and a low maintenance rear garden, with excellent further potential. Available with No Upward Chain.

3



1



1









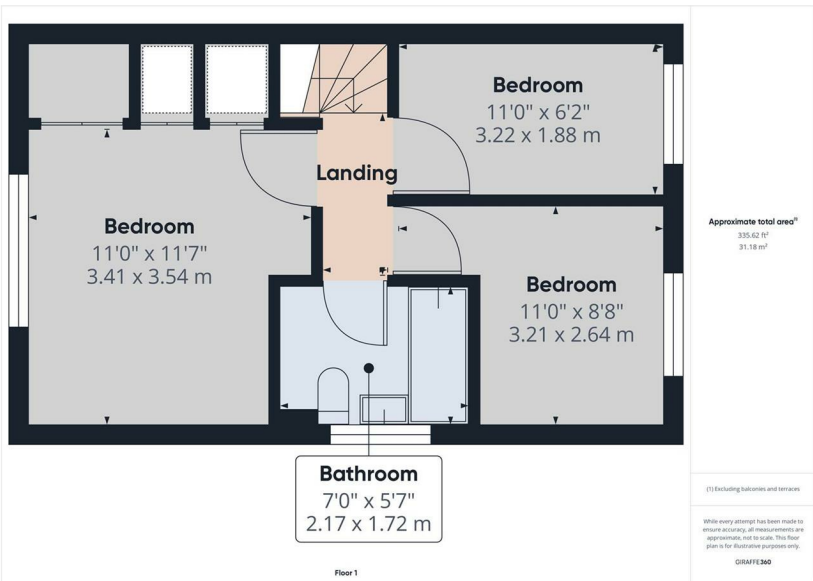

LOCAL AUTHORITY
Wyre Forest District Council

TENURE
Freehold

COUNCIL TAX BAND
C

VIEWINGS
By prior appointment only

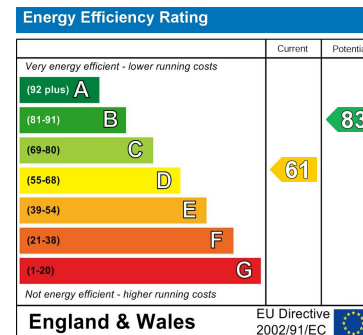

Agents Note: Whilst every care has been taken to prepare these particulars, they are for guidance purposes only. All measurements are approximate and are for general guidance purposes only and whilst every care has been taken to ensure their accuracy, they should not be relied upon and potential buyers/tenants are advised to recheck the measurements

EDEN MIDCALF
SALES & LETTINGS

5 Load Street
Bewdley
DY12 2AF

01299 402392
wyreforest@edenmidcalf.co.uk
<https://www.edenmidcalf.co.uk/contact-us/>