

A two-story red brick building with a dark grey tiled roof. The facade features several arched windows with white frames and dark brick surrounds. A central entrance has a light blue door and a dark green door. A small flower box is mounted under the window to the left of the entrance. The building is set against a clear blue sky.

EDEN MIDCALF  
— SALES & LETTINGS —

£269,950  
Westbourne Street  
Worcestershire, DY12 1BS

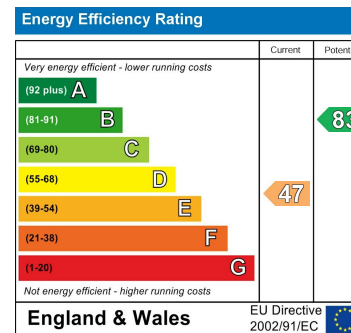

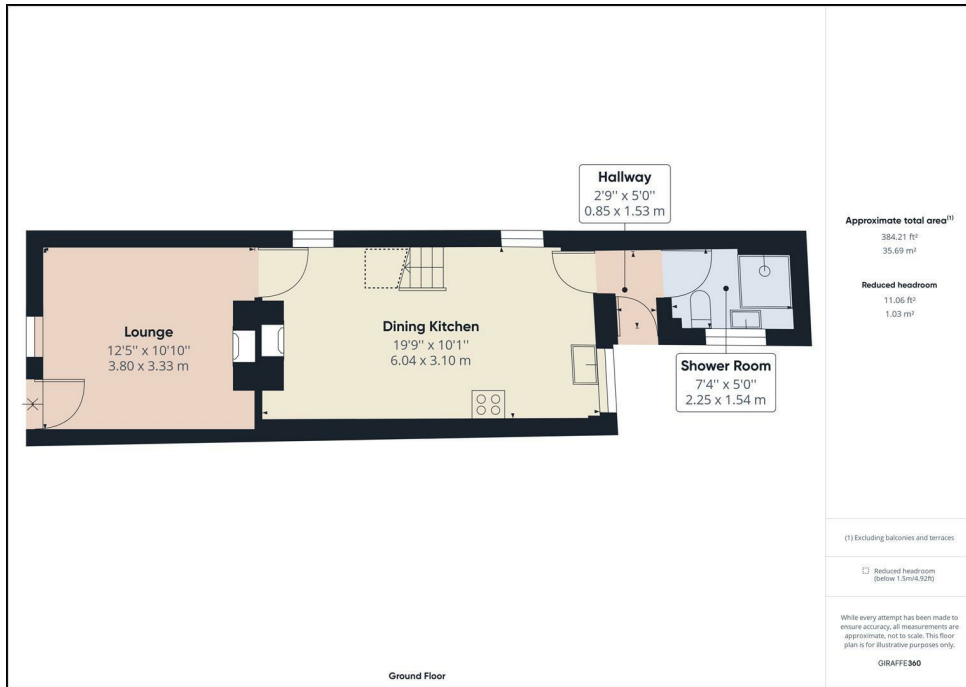

Agents Note: Whilst every care has been taken to prepare these particulars, they are for guidance purposes only. All measurements are approximate and are for general guidance purposes only and whilst every care has been taken to ensure their accuracy, they should not be relied upon and potential buyers/tenants are advised to recheck

**EDEN MIDCALF**  
SALES & LETTINGS

5 Load Street  
Bewdley  
DY12 2AF

01299 402392  
wyreforest@edenmidcalf.co.uk  
<https://www.edenmidcalf.co.uk/>  
us/