

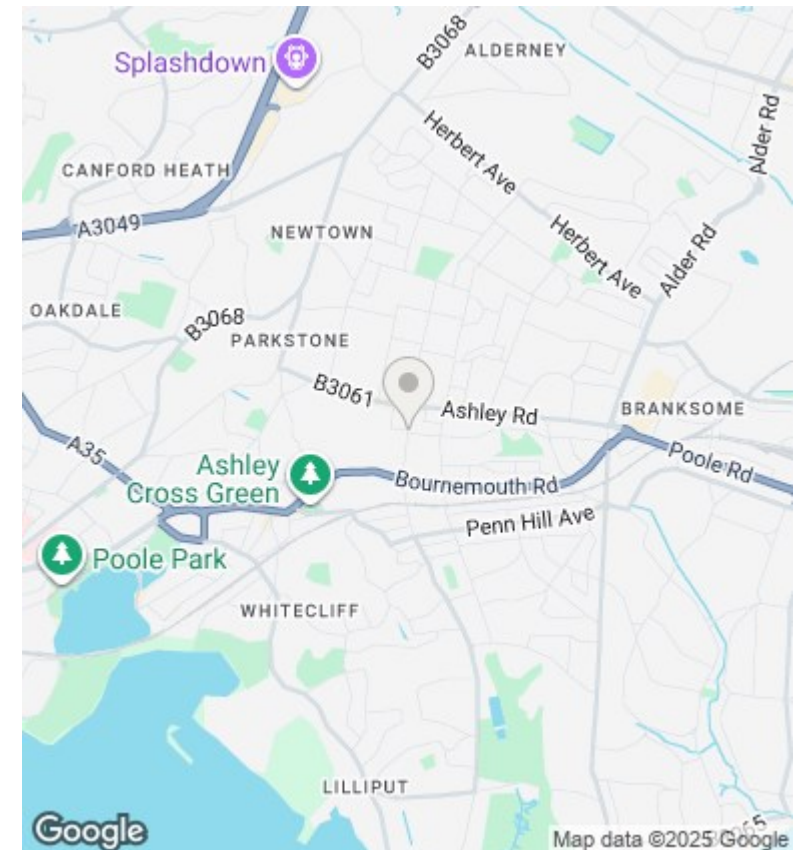

5 Silver Cross, 15 Mansfield Road, Poole, BH14 0DD

£1,400

- Two Double Bedrooms
- Downstairs Cloakroom & Utility Area
- Lovely Open Plan Living Area
- Available End of October
- Spacious Town House
- UPVC Double Glazing
- Close To Amenities & Bus Routes
- High Specification Throughout
- Gas Central Heating
- Unfurnished

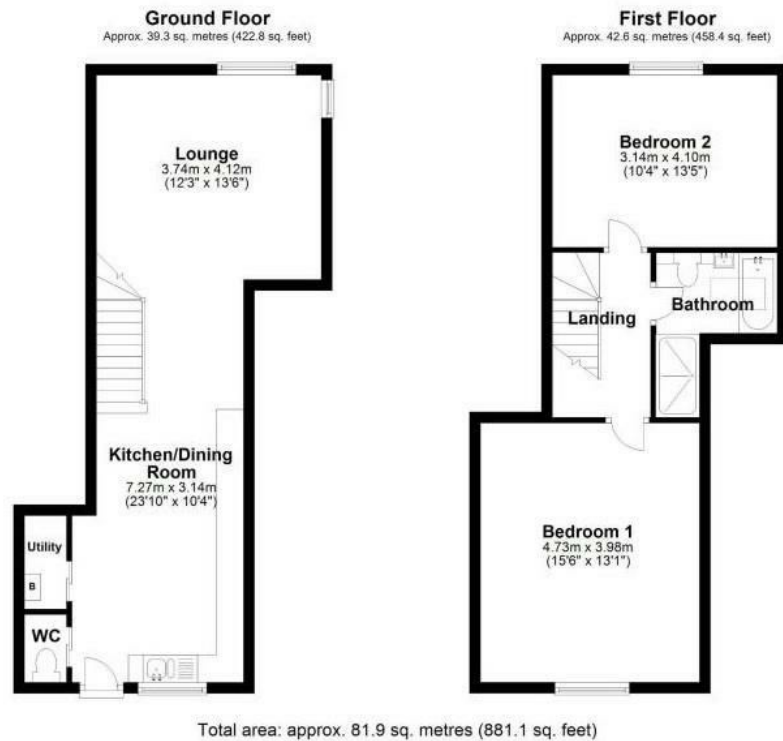

Directions

Viewings

Viewings by arrangement only. Call 01202 749390 to make an appointment.

Council Tax Band

B

EPC Rating:

C

Energy Efficiency Rating		
	Current	Potential
Very energy efficient - lower running costs		
(92-plus) A		93
(81-91) B		
(69-80) C	80	
(55-68) D		
(39-54) E		
(21-38) F		
(1-20) G		
Not energy efficient - higher running costs		
England & Wales	EU Directive 2002/91/EC	