



140 Evering Avenue, Parkstone, Poole, BH12 4JH

£750,000

- Five Bedrooms
- Detached Three Story Chalet
- Large Kitchen / Dining Room
- Backing onto Nature Reserve
- Ample Off Road Parking
- Additional Two Bedroom Annex
- Superb Bourne Valley Views
- En-Suite To Bedroom One
- High Specification Throughout
- Beautifully Presented

BEAUTIFULLY EXTENDED FIVE BEDROOM CHALET STYLE HOUSE WITH AN ADDITIONAL TWO BEDROOM ANNEX / RARE TO THE MARKET / HIGH SPECIFICATION THROUGHOUT >>> Greys Estate Agents are delighted to offer for sale this beautifully extended three storey chalet style house with a feature additional two bedroom annex. The property is situated in the sought after Evering Avenue in Poole and comprises: Five bedrooms, large en-suite to bedroom one, good size open plan kitchen / dining room, lounge with balcony overlooking the lovely Southerly Nature Reserve and a family bathroom. Other benefits include a good size two bedroom annex with an open plan living space and luxury fitted shower room, good size beautifully tiered rear garden and a driveway providing ample off road parking.



Agents Notes

Additional benefits include: UPVC double glazing, gas central heating with additional underfloor heating, a feature networked hifi speaker system, an electric car charging point and a range of sheds.





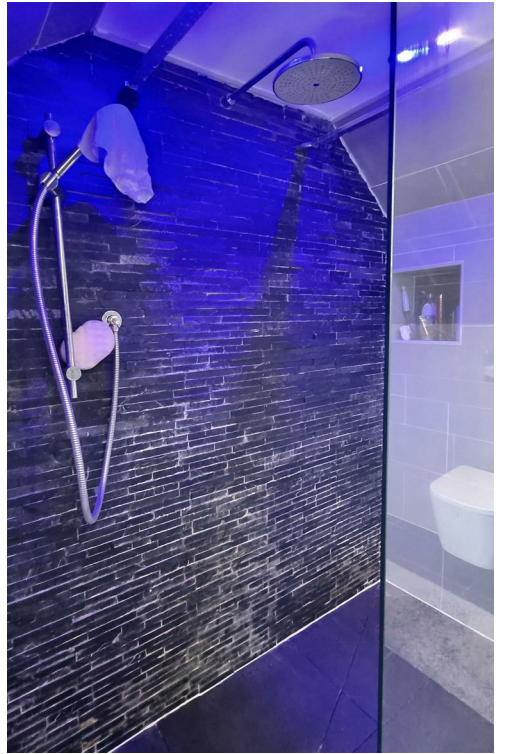

Energy Efficiency Rating		Current	Potential
Very energy efficient - lower running costs			
(92 plus) A			
(81-91) B			
(69-80) C			74
(55-68) D		58	
(39-54) E			
(21-38) F			
(1-20) G			
Not energy efficient - higher running costs			
England & Wales		EU Directive 2002/91/EC	

Viewings

Viewings by arrangement only. Call 01202 749390 to make an appointment.

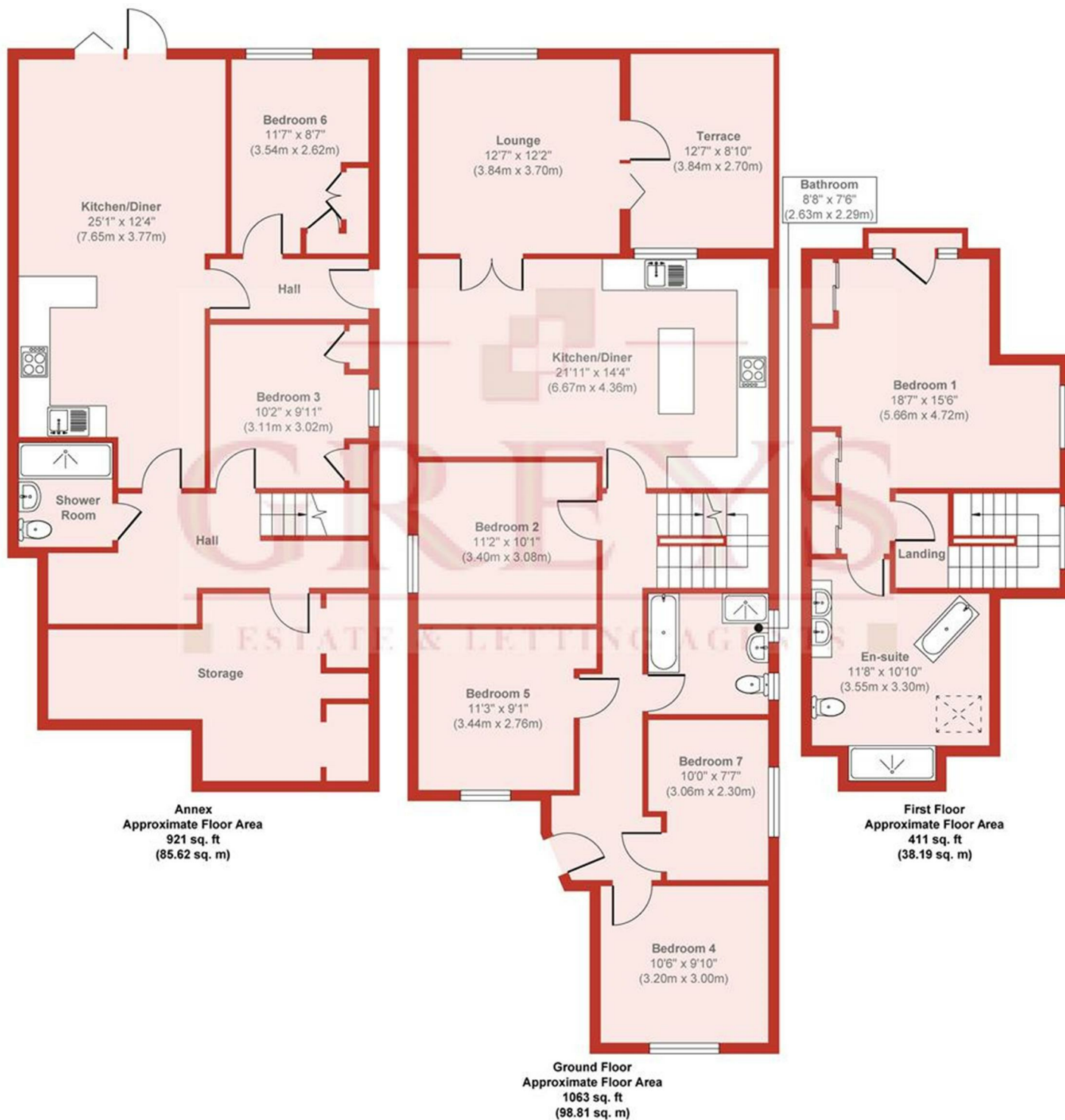

Approx. Gross Internal Floor Area 2395 sq. ft / 222.62 sq. m

Produced by Elements Property