



## Jersey Close, Poole, BH12 4LH

£335,000

- Three Bedrooms
- Beautifully Presented
- Gas Central Heating
- Lovely Front & Rear Gardens
- Driveway Providing ORP
- Semi-Detached House
- UPVC Double Glazing
- Modern Kitchen & Bathroom
- Cul-De-Sac Location
- Ideal Family Home



BEAUTIFULLY PRESENTED / CLOSE TO NATURE RESERVE / CUL-DE-SAC POSITION >>> Greys Estate Agents are delighted to offer for sale this beautifully presented semi detached house situated in the popular Jersey Close in Alderney, Poole. The property comprises: Three bedrooms, lounge / dining room with feature log burner, modern kitchen with a utility area and a modern family bathroom. Other benefits include UPVC double glazing, gas central heating via a modern combination style gas boiler, UPVC double glazing, lovely front and rear gardens and a driveway providing off road parking. Other benefits include a cul-de-sac position and being within easy walking distance of the local Nature Reserve.

3 1 1 C





### Lounge

24'8" x 12'8" max (7.52m x 3.86m max)

### Kitchen

10'1" x 8'11" max (3.07m x 2.72m max)

### Utility

### Bedroom One

13'8" x 10'4" (4.17 x 3.15)

### Bedroom Two

12'11" x 8'10" (3.96 x 2.71)

### Bedroom Three

9'3" x 8'0" (2.84 x 2.45)

### Family Bathroom









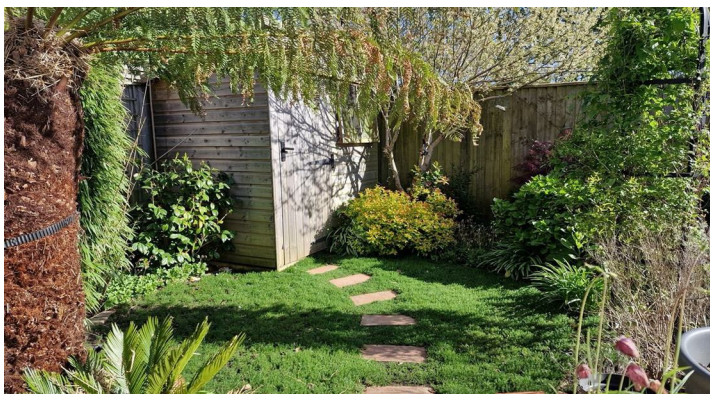



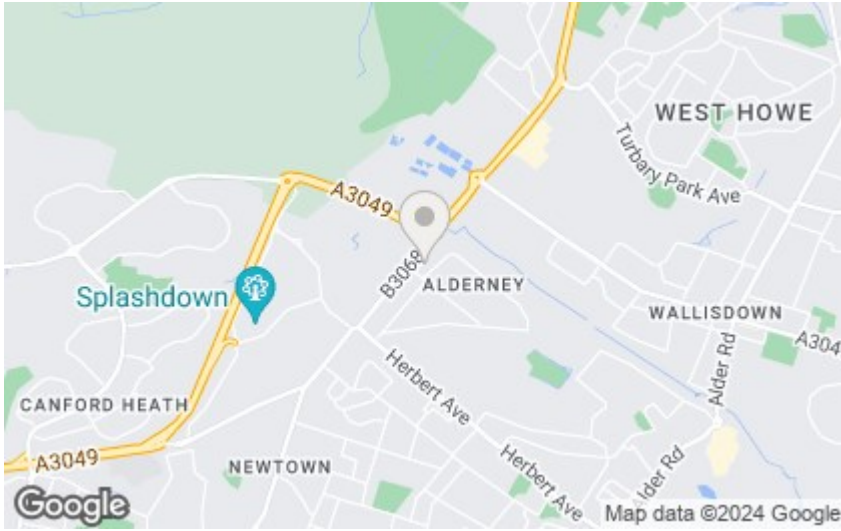

## Viewings

Viewings by arrangement only. Call 01202 749390 to make an appointment.

EPC Rating: TBC

C

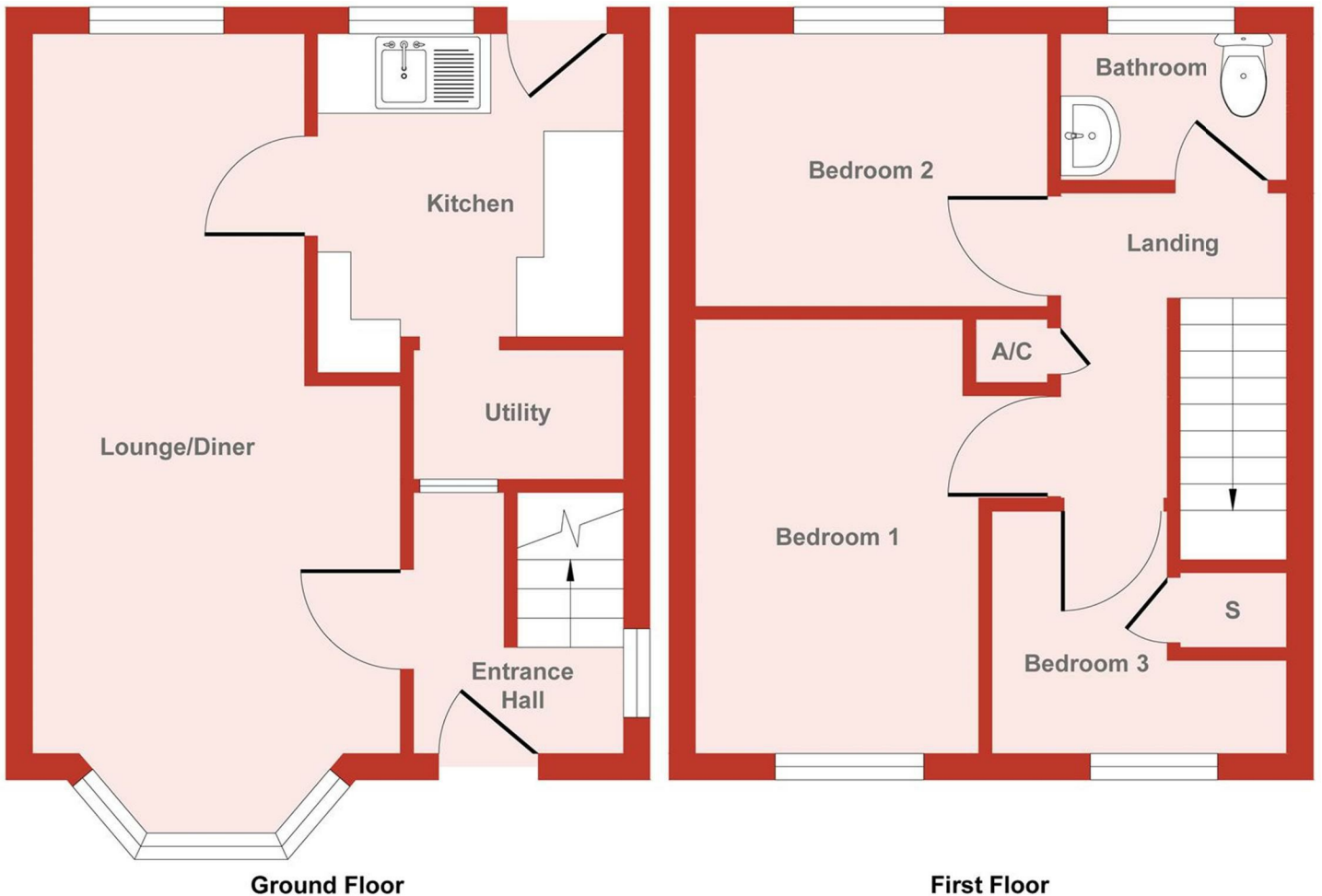

Produced by Elements Property