



1 River Terrace Victoria Road

, Chelmsford, CM2 6FW

£1,400



Nestled on Victoria Road in the charming city of Chelmsford, this purpose-built flat offers a delightful living experience. The property features two well-proportioned bedrooms, making it ideal for couples or individuals seeking extra space. The flat has been recently redecorated throughout as well as flooring.

One of the standout features of this property is the dedicated parking space, providing ease and accessibility for those with a vehicle.

For commuters, the flat's proximity to the train station is a significant advantage, allowing for quick and easy access to London and other nearby areas. The property is fully electric, offering a contemporary living environment that aligns with modern energy standards.



ENTRANCE

Video intercom system, carpet to floor, door to main rooms and wall mounted radiator.

LOUNGE

Spacious lounge with double glazed door and window to rear, radiator and new carpet to floor.

KITCHEN

Selection of wall and base units with integrated electric oven, 4 ring electric hob with extractor fan, fridge/freezer., washing machine and dishwasher.

BEDROOM 1

Good sized double bedroom with double glazed doors to balcony. Carpet to floor & radiator.

ENSUITE

Corner shower cubicle, wash hand basin and WC. Part tiled walls, tiled floor, ladder style heated towel rail, shaver point, extractor fan.

BEDROOM 2

Large single bedroom with double glazed window with blind and radiator.

BATHROOM

3 piece suite with panel enclosed bath and shower attachment, WC and basin. Tiled floor and part tiled walls. Window to front.

EXTERNAL

Allocated parking space.

Back door off the lounge, steps leading down to the street.

INFORMATION

Holding Fee: £323.00

Deposit: £1615.00

Applicants must be able to show an annual income of £42,000 or more.

Available: Immediately following referencing

Area Map



Floor Plans

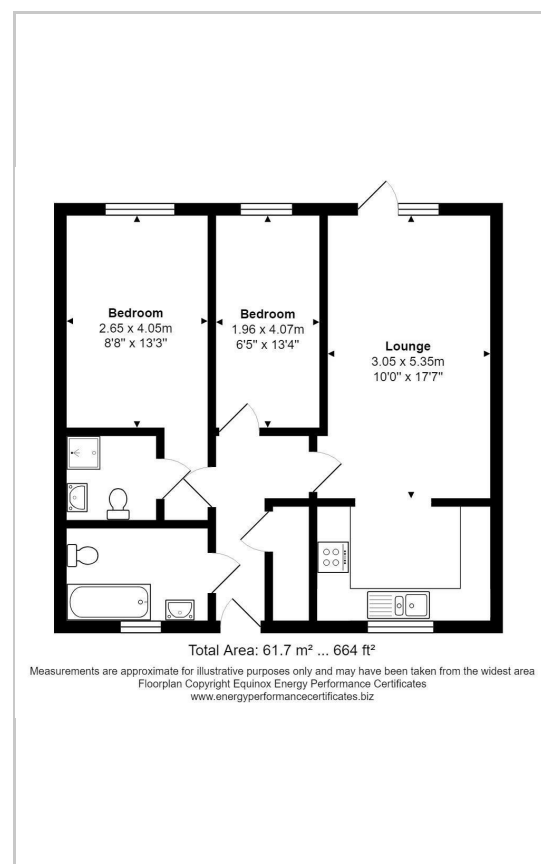

Energy Efficiency Graph

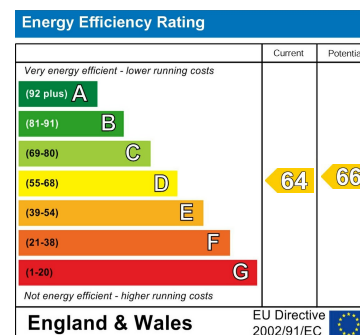

These particulars, whilst believed to be accurate are set out as a general outline only for guidance and do not constitute any part of an offer or contract. Intending purchasers should not rely on them as statements of representation of fact, but must satisfy themselves by inspection or otherwise as to their accuracy. No person in this firm's employment has the authority to make or give any representation or warranty in respect of the property.

65 New London Road, Chelmsford, Essex, CM2 0ND

Tel: 01245 266088 Email: property@elwelltaylor.co.uk <https://www.elwelltaylor.co.uk>