



12 River Terrace

Victoria Road, Chelmsford, CM2 6FW

£1,300



A bright, modern two bedroom two bathroom, in the heart of Chelmsford City Center apartment for rent. Comes with 1 allocated spare in communal car park.



COMMUNAL ENTRANCE

Secure Entry phone system, stairs leading to all floors, door to:

ENTRANCE TO FLAT

Video intercom system. doors to all rooms door to heating and hot water system/storage cupboard

LOUNGE / KITCHEN

Carpet to floor, door to balcony, radiator open plan to kitchen. Wall and base units with integrated electric cooker and 4 ring electric hob with extraction over, fridge/freezer., washing machine and dishwasher.

BEDROOM 1

Double sized room with carpet to floor, window to side aspect. Radiator.

EN SUITE

3 piece suite with walk in shower cubicle, WC and basin. Tiled floor and part tiled walls, window to side aspect. Wall mounted chrome heated towel rail.

BEDROOM 2

Single room with carpet to floor, window to side and radiator.

BATHROOM

3 piece suite with panel enclosed bath and shower attachment, WC and basin. Tiled floor and part tiled walls. Window to front.

EXTERNAL

The property benefits from having a balcony with an outside light as well as 1 allocated parking space.

INFORMATION

Holding Fee: £300.00

Deposit: £1500.00

Available from: early July 2024

Applicants must be able to prove an annual income of £39,000 or more.

No pets or smokers.

Area Map



Floor Plans

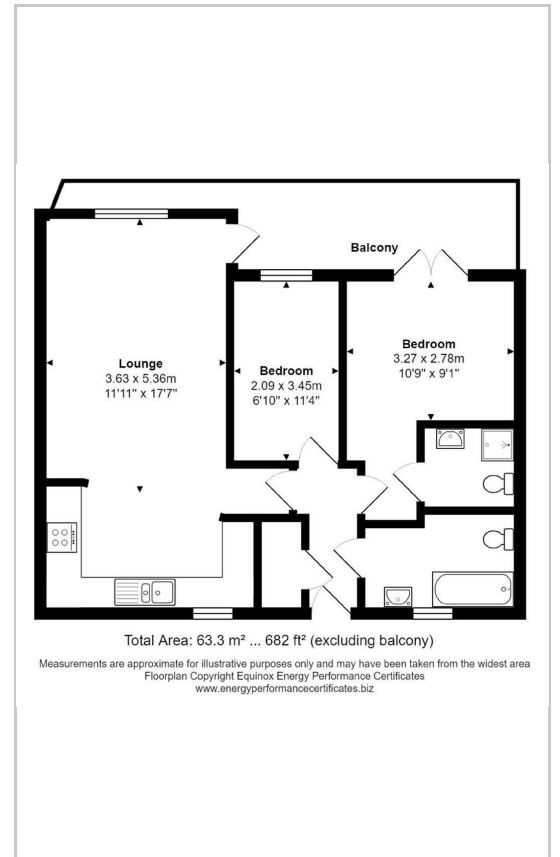

Energy Efficiency Graph

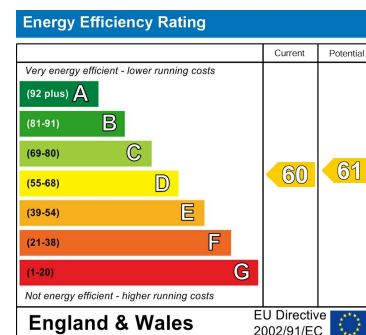

These particulars, whilst believed to be accurate are set out as a general outline only for guidance and do not constitute any part of an offer or contract. Intending purchasers should not rely on them as statements of representation of fact, but must satisfy themselves by inspection or otherwise as to their accuracy. No person in this firm's employment has the authority to make or give any representation or warranty in respect of the property.

38 Rayne Road, Braintree, Essex, CM7 2QP

Tel: 01245 266088 Email: property@elwelltaylor.co.uk <https://www.elwelltaylor.co.uk>