



2 Centris Tower

60 Goldlay Avenue, Chelmsford, CM2 0TN

Offers In The Region Of £165,000



Smart first floor, modern one bedroom apartment close to Chelmsford City Centre. This apartment is being offered with no onward chain. Accommodation comprises: Open plan lounge/fitted kitchen, bedroom and bathroom There is a balcony off the lounge and one allocated parking space.



HALLWAY:

Front door, beech laminate wood flooring, cupboard housing hot water system, wall mounted video entry phone system, wall mounted under floor heating control, doors to all rooms.

LIVING AREA: 21'5" x 11'0" (6.53 x 3.35)

Full length double glazed door to side giving access to balcony, laminate wood flooring, wall mounted under floor heating control, open plan to:

KITCHEN:

Selection of wall and base units in beech complimented by a royal granite laminate work surface. Integrated Appliances: Bosch electric oven, fridge/freezer, washing machine and dishwasher. And four ring hob with extractor fan, stainless steel sink and drainer with mixer taps, under cabinet lighting, down lights to ceiling, splash back tiles, wood laminate flooring.

BEDROOM: 10'7" x 10'1" (3.23 x 3.07)

Wood effect Laminate flooring, window to side, wall mounted under floor heating control.

BATHROOM:

3 piece suite in white comprising panel enclosed bath with shower over, WC, wash hand basin, shaver socket, tiled floor with under floor heating, extraction.

EXTERNAL:

Balcony that is accessed off the lounge.
The flat comes with one allocated parking space in the car park to the rear of the building.
In the entrance lobby there is secure access to the bike store.

INFORMATION:

Lease: 125 years from 2007, 110 years remaining.
Service Charge: £ 2323 / year or £580 / quarter.
Ground Rent: £250 / year

Council Tax Band: B

Pets are not permitted under the head lease of the building.

Area Map



Floor Plans

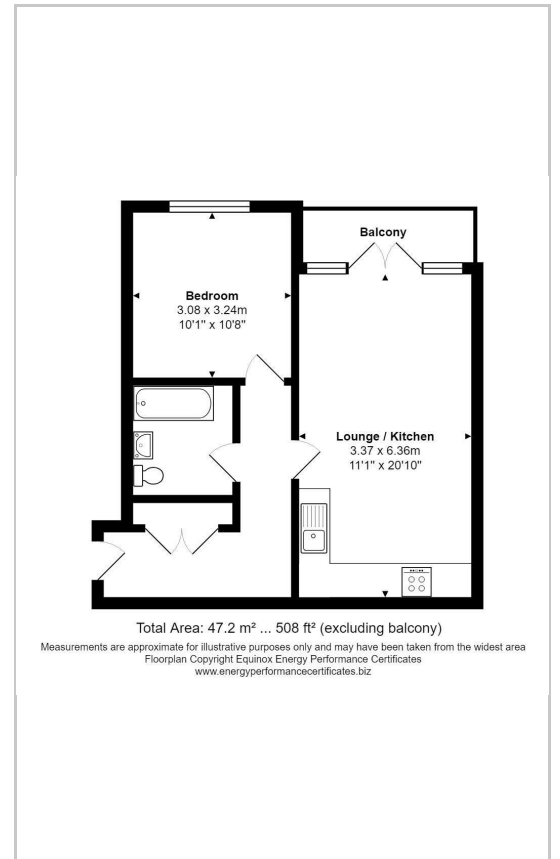

Energy Efficiency Graph

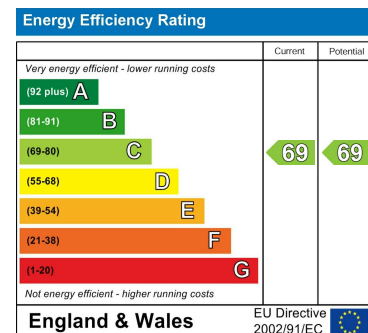

These particulars, whilst believed to be accurate are set out as a general outline only for guidance and do not constitute any part of an offer or contract. Intending purchasers should not rely on them as statements of representation of fact, but must satisfy themselves by inspection or otherwise as to their accuracy. No person in this firm's employment has the authority to make or give any representation or warranty in respect of the property.