

22 PRINCIPAL COURT

TUDOR CRESCENT | PORTSMOUTH | PO6 2BW



£190,000
Leasehold

- Superbly Presented Top Floor Apartment
- Desirable Modern Development
- Close to Shopping Facilities & Railway Station
- Two Bedrooms : Master with En-Suite Shower
- Living/Dining Room with Juliet Balcony
- Beautifully Fitted Kitchen
- Allocated Parking Bay plus Visitor Parking Passes
- Early Viewing Strongly Advised





In Brief

We have pleasure in marketing for sale this **SUPERBLY** presented third floor (top floor) apartment situated in a **DESIRABLE** modern cul-de-sac setting just south of the main shopping centre at Cosham high street, **RAILWAY** station and access to the M27 motorway.

With communal access via stairs serving just two apartments per floor, this 'end' apartment is bright and airy with a spacious layout comprising; entrance hall, living/dining room with Juliet **BALCONY**, lovely fitted kitchen complete with oven, gas hob and extractor fan, master bedroom with **EN-SUITE** shower room, second bedroom and main bathroom. On the ground floor there is a lockable communal bike store.

Externally, there is an allocated **PARKING** bay with parking permits available for visitors.

Benefiting from gas central heating and double glazing, we would strongly recommend your earliest inspection to avoid disappointment.

£190,000

KEY FACTS

Leasehold

111 Years Remaining On Lease

Ground Rent - £210 Per Annum

Maintenance - £1,500 Per Annum

Council Tax Band - B

EPC Rating - TBC



22 PRINCIPAL COURT

TUDOR CRESCENT | PORTSMOUTH | PO6 2BW



Principal Court, Tudor Crescent, Cosham

Approximate Gross Internal Area = 58.3 sq m / 627 sq ft

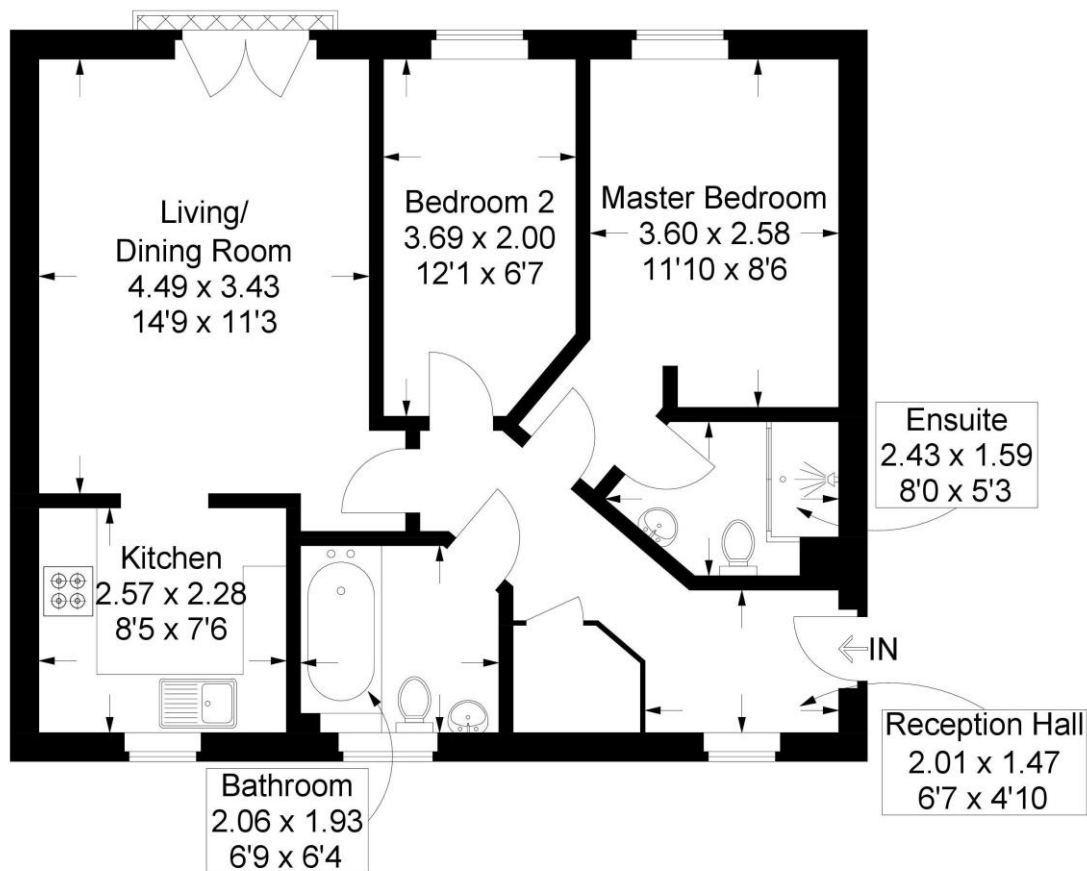

Third Floor

This plan is for layout guidance only. Not drawn to scale unless stated. Windows and door openings are approximate. Whilst every care is taken in the preparation of this plan, please check all dimensions, shapes and compass bearings before making any decisions reliant upon them.

Southsea
Sales & Lettings
7/9 Stanley Street,
Southsea, PO5 2DS
Tel: 023 9281 5221

Old Portsmouth & Gunwharf Quays
Sales & Lettings
The Seagull, 13 Broad Street,
Old Portsmouth, PO1 2JD
Tel: 023 9281 5221

Drayton & Out of Town
Sales & Lettings
139 Havant Road,
Drayton, PO6 2AA
Tel: 023 9221 0101

London
Sales & Lettings
Mayfair Office, Cashel House,
15 Thayer Street, W1U 3JT
Tel: 0870 112 7099

Southsea
Admin Centre
12 Marmion Road,
Southsea, PO5 2BA
Tel: 023 9282 2300

www.fryandkent.com



The services or appliances, plumbing, heating or electric installations have not been tested by the selling agent so we are unable to confirm that they are in working order. Whilst we endeavour to make our sales details accurate and reliable, they should not be relied upon as statements or representations of fact, and do not constitute any part of an offer contract. The seller does not make or give, nor do we or our employees have the authority to make or give, any representation or warranty in relation to the property.

