

# SHAKESPEARE TERRACE

OLD PORTSMOUTH | HAMPSHIRE | PO1 2HP



£550,000  
Freehold

- Spacious Four Bedroom Family Home
- Within Old Portsmouth Conservation Area
- Living/ Dining Room, Kitchen, Conservatory
- Four Bedrooms & Two Bathrooms
- Low Maintenance Garden & Garage
- Walking Distance to Seafront and Train Station
- Offered with No Forward Chain
- Viewing Advised!





## In Brief

We are delighted to offer for sale this spacious family home, situated within the sought after Old Portsmouth Conservation Area, a stone throw from Portsmouth Grammar School and within close proximity to all other local schools. The property is conveniently situated very close to Gunwharf Quays, the seafront, Southsea Common and Central Southsea, plus excellent transport links including Portsmouth train and bus stations, ferries and motorway links, are all close by. The accommodation comprises entrance porch, 23ft living/ dining room with feature fireplace and stain glass window, kitchen/ breakfast room with appliances leading through to the conservatory. To the first floor there is the family bathroom, bedroom four or study and master bedroom with built in wardrobes. To the second is double bedroom with en-suite shower room and a further double bedroom with built in wardrobes. Externally there is a low maintenance westerly facing garden with conservatory and access to garage. Being sold with no forward chain, and discerning purchasers are strongly recommended to make the earliest of enquiries to avoid disappointment.

**£550,000**

## KEY FACTS

**TENURE:** Freehold

**EPC RATING:** 'D'

**COUNCIL TAX BAND:** 'E'





# SHAKESPEARE TERRACE

OLD PORTSMOUTH | HAMPSHIRE | PO1 2HP



## Shakespeare Terrace, High Street, Old Portsmouth

Approximate Gross Internal Area = 136.6 sq m / 1470 sq ft

Outbuilding = 15.4 sq m / 166 sq ft

Total = 152 sq m / 1636 sq ft

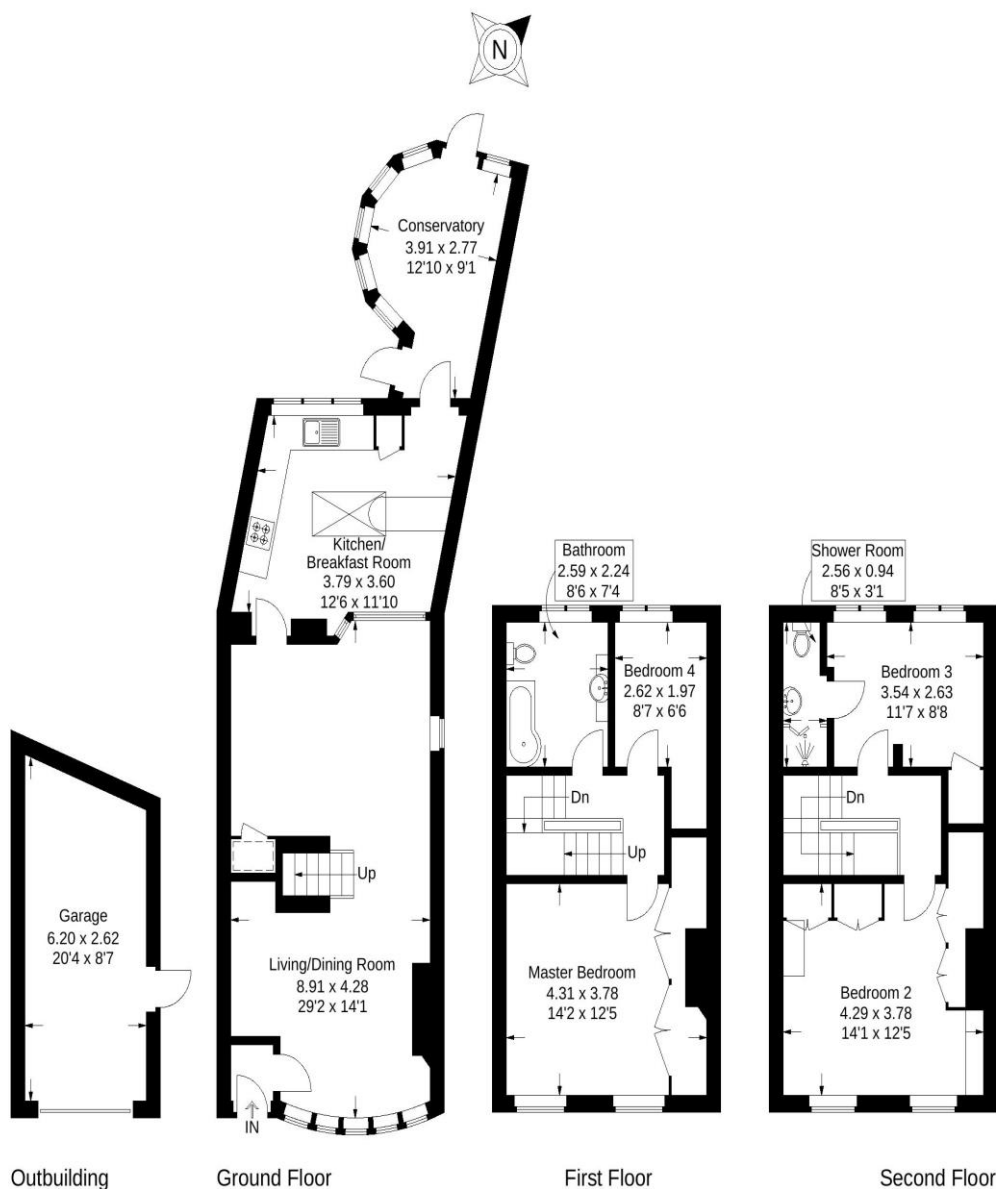

 = Reduced headroom below 1.5m / 5'0

This plan is for layout guidance only. Not drawn to scale unless stated. Windows and door openings are approximate. Whilst every care is taken in the preparation of this plan, please check all dimensions, shapes and compass bearings before making any decisions reliant upon them.

**Southsea**  
Sales & Lettings  
7/9 Stanley Street,  
Southsea, PO5 2DS  
Tel: 023 9281 5221

**Old Portsmouth & Gunwharf Quays**  
Sales & Lettings  
The Seagull, 13 Broad Street,  
Old Portsmouth, PO1 2JD  
Tel: 023 9281 5221

**Drayton & Out of Town**  
Sales & Lettings  
139 Havant Road,  
Drayton, PO6 2AA  
Tel: 023 9221 0101

**London**  
Sales & Lettings  
Mayfair Office, Cashel House,  
15 Thayer Street, W1U 3JT  
Tel: 0870 112 7099

**Southsea**  
Admin Centre  
12 Marmion Road,  
Southsea, PO5 2BA  
Tel: 023 9282 2300

[www.fryandkent.com](http://www.fryandkent.com)