

BEAULIEU ROAD

PORTSMOUTH | HAMPSHIRE | PO2 0DN



£259,950

Freehold

- Traditional Victorian Family Home
- Located within a Popular Road of Copnor
- Close to Shops and Amenities
- Three Double Bedrooms : Upstairs Bathroom
- Spacious Kitchen with Integrated Appliances
- Double Glazing : Gas Central Heating
- Being Sold with No Forward Chain
- Viewing Advised!





In Brief

We are delighted to offer for sale this traditional Victorian three bedroom terraced house, which is being sold with no forward chain.

The property is conveniently positioned within walking distance of local shops amenities, which can be found on London Road.

The internal accommodation comprises; Sitting Room, Dining Room, a Spacious Kitchen with Integrated Appliances with doors to the rear garden. The first floor consists of three bedrooms and the family Bathroom.

The property further benefits from a low maintenance rear garden, double glazing and gas central heating throughout.

Discerning purchasers are strongly encouraged to put forward the earliest of enquiries to avoid disappointment.

£259,950

KEY FACTS

TENURE: Freehold

EPC RATING: 'D'

COUNCIL TAX BAND: 'B'



BEAULIEU ROAD

PORTSMOUTH | HAMPSHIRE | PO2 0DN



Beaulieu Road, Copnor

Approximate Gross Internal Area = 90.9 sq m / 978 sq ft

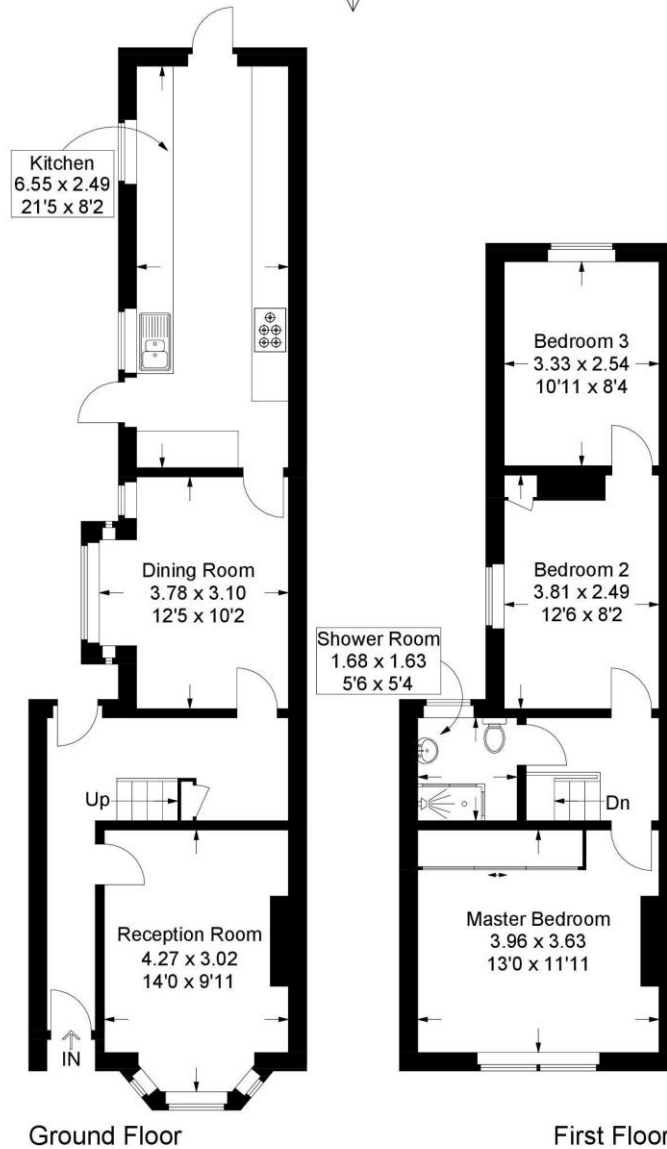

This plan is for layout guidance only. Not drawn to scale unless stated. Windows and door openings are approximate. Whilst every care is taken in the preparation of this plan, please check all dimensions, shapes and compass bearings before making any decisions reliant upon them.

Southsea
Sales & Lettings
7/9 Stanley Street,
Southsea, PO5 2DS
Tel: 023 9281 5221

Old Portsmouth & Gunwharf Quays
Sales & Lettings
The Seagull, 13 Broad Street,
Old Portsmouth, PO1 2JD
Tel: 023 9281 5221

Drayton & Out of Town
Sales & Lettings
139 Havant Road,
Drayton, PO6 2AA
Tel: 023 9221 0101

London
Sales & Lettings
Mayfair Office, Cashel House,
15 Thayer Street, W1U 3JT
Tel: 0870 112 7099

Southsea
Admin Centre
12 Marmion Road,
Southsea, PO5 2BA
Tel: 023 9282 2300

www.fryandkent.com