

CRINOLINE GARDENS

SOUTHSEA | HAMPSHIRE | PO4 9YB



OFFERS IN EXCESS OF £800,000 Freehold

- Highly Requested Residential Location
- Solent & IOW Views from Upper Floors
- Three/Four Bedrooms Over Three Floors
- Master Bedroom With En-suite Bathroom
- Integral Garage Plus Driveway to Front
- Communal Use Of Eastney Fort West
- Private Estate With Security Gates
- Internal Viewing Recommended





In Brief

Generational opportunity to acquire this Superb Four Bedroom Townhouse in this privileged position of a Private security gated estate. Boasting Sea Views from the Upper floors this outstanding home has been well maintained and improved by the current owners. Internally the accommodation comprises an Entrance Hall with integral door to garage and door to Garden Room/Bedroom 4 also there is access to the ground floor Cloakroom/Utility Room. On the first Floor there is a door to Study and door to the Kitchen which is fitted with a luxury range of Eye and Base Level units with integrated appliances. To the front on this Floor the Lounge /Dining Room offer views across the Seafront towards the Solent and Isle of Wight beyond. On the Top floor there is a Shower room and Three Bedrooms the Master Bedroom having the benefit of a superbly fitted en-suite Bathroom and views across the Seafront to Solent and Isle of Wight. To the rear of the property there is a Lawned Rear garden whilst to the front there is a driveway. With its spacious layout, modern amenities, and thoughtful design, this townhouse offers a comfortable and versatile living space suitable for a variety of lifestyle needs.

Offers in Excess of £800,000

KEY FACTS

TENURE: Freehold

EPC RATING: 'TBC'

COUNCIL TAX BAND: 'F'

ESTATE CHARGE: '£946.36 per annum'



CRINOLINE GARDENS

SOUTHSEA | HAMPSHIRE | PO4 9YB



Crinoline Gardens, Southsea

Approximate Gross Internal Area = 127.1 sq m / 1368 sq ft

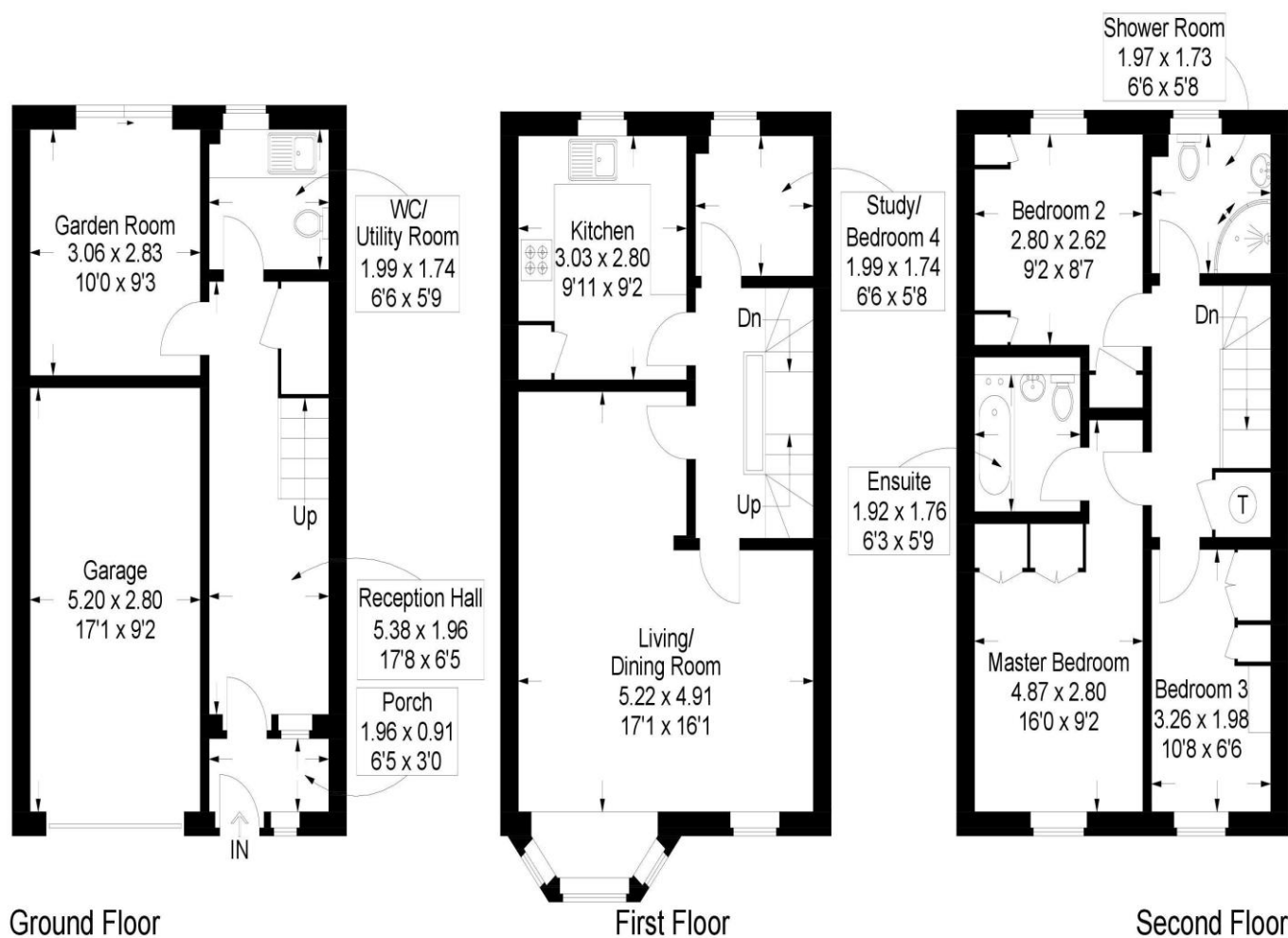

This plan is for layout guidance only. Not drawn to scale unless stated. Windows and door openings are approximate. Whilst every care is taken in the preparation of this plan, please check all dimensions, shapes and compass bearings before making any decisions reliant upon them.

Southsea
Sales & Lettings
7/9 Stanley Street,
Southsea, PO5 2DS
Tel: 023 9281 5221

Old Portsmouth & Gunwharf Quays
Sales & Lettings
The Seagull, 13 Broad Street,
Old Portsmouth, PO1 2JD
Tel: 023 9281 5221

Drayton & Out of Town
Sales & Lettings
139 Havant Road,
Drayton, PO6 2AA
Tel: 023 9221 0101

London
Sales & Lettings
Mayfair Office, Cashel House,
15 Thayer Street, W1U 3JT
Tel: 0870 112 7099

Southsea
Admin Centre
12 Marmion Road,
Southsea, PO5 2BA
Tel: 023 9282 2300

www.fryandkent.com