

ALBERT GROVE

SOUTHSEA | HAMPSHIRE | PO5 1NG



£899,950

Freehold

- Four Bedroom Detached Period Home
- Lounge, Drawing Room, Dining Room
- Garage With Workshop & Separate Store
- Wealth Of Period Style and Original Features
- Solar Panels & Car Charging Point
- Driveway With Off Road Parking
- Utility/Scullery, Two Cloakrooms
- Westerly Facing Rear Garden





In Brief

Outstanding Period home located in this popular and central residential location boasting not only a wealth of period style features but the holy grail of a Detached house, well proportioned garden for town, garage and driveway providing off road parking for further vehicles. On the ground floor there are Three Reception rooms consisting of Lounge, Drawing Room/Study, Dining Room which is Open plan to the Kitchen which has a range of contemporary units and an Esse Aga style oven. There is a also a Cloakroom and separate utility/scullery. On the first floor there are Four Bedrooms and a family bathroom with ample scope to consider a loft conversion should the space be required. To the front of the property there is a forecourt with mature hedging whilst to the rear there is well proportioned garden facing in a westerly direction with side pedestrian gate from the drive and doors to the garage and separate store room. In previous years the owners have created successful fruit borders on the garage roof. The property also benefits from photovoltaic panels and a Car charging point.

£899,950

KEY FACTS

TENURE: Freehold

EPC RATING: TBA

COUNTIL TAX BAND: 'F'



ALBERT GROVE

SOUTHSEA | HAMPSHIRE | PO5 1NG



Albert Grove, Southsea

Approximate Gross Internal Area = 176.1 sq m / 1895 sq ft

Outbuilding = 35.6 sq m / 383 sq ft

Total = 211.7 sq m / 2278 sq ft

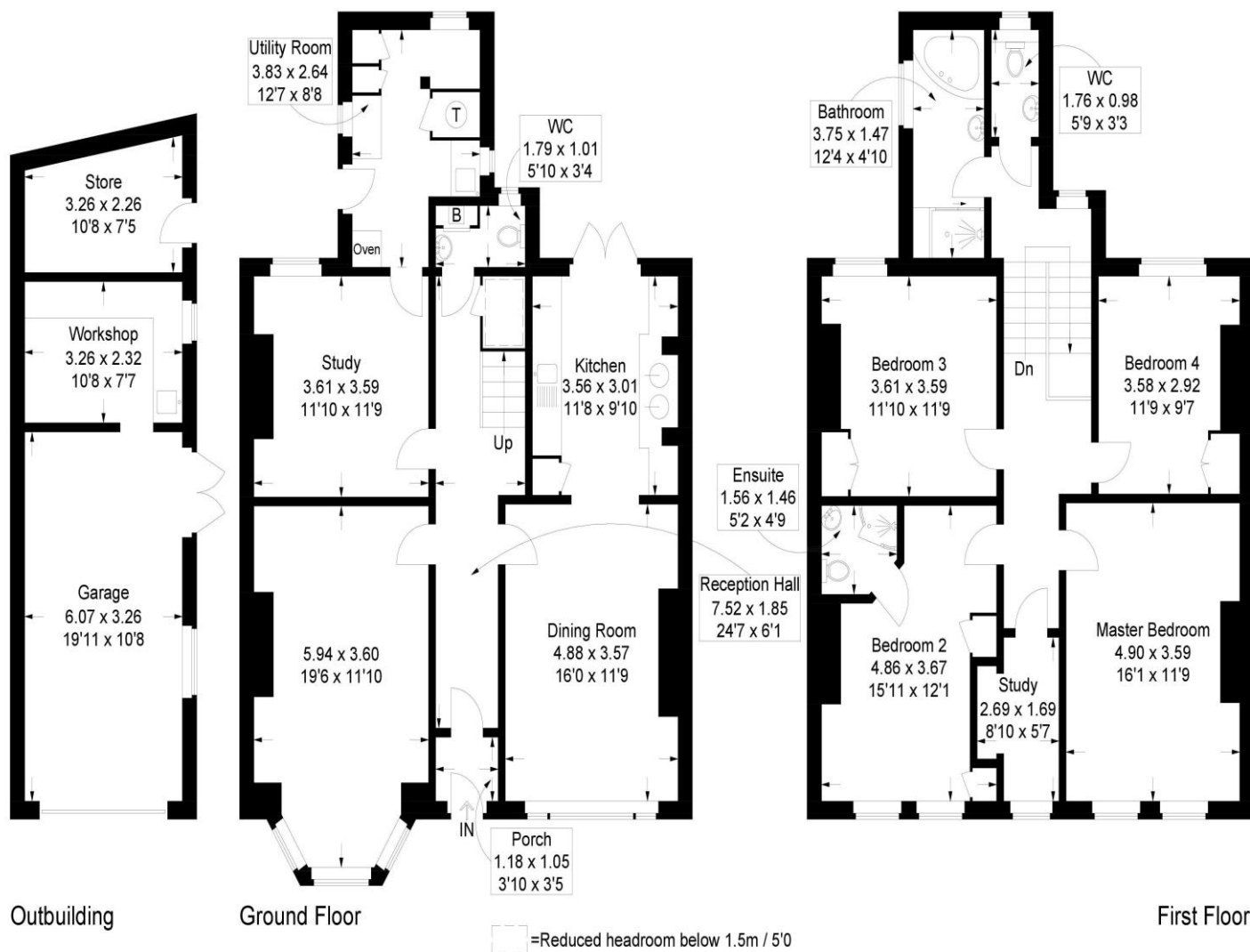

This plan is for layout guidance only. Not drawn to scale unless stated. Windows and door openings are approximate. Whilst every care is taken in the preparation of this plan, please check all dimensions, shapes and compass bearings before making any decisions reliant upon them.

Southsea
Sales & Lettings
7/9 Stanley Street,
Southsea, PO5 2DS
Tel: 023 9281 5221

Old Portsmouth & Gunwharf Quays
Sales & Lettings
The Seagull, 13 Broad Street,
Old Portsmouth, PO1 2JD
Tel: 023 9281 5221

Drayton & Out of Town
Sales & Lettings
139 Havant Road,
Drayton, PO6 2AA
Tel: 023 9221 0101

London
Sales & Lettings
Mayfair Office, Cashel House,
15 Thayer Street, W1U 3JT
Tel: 0870 112 7099

Southsea
Admin Centre
12 Marmion Road,
Southsea, PO5 2BA
Tel: 023 9282 2300

www.fryandkent.com