

RICHMOND TERRACE

SOUTHSEA | HAMPSHIRE | PO5 3NE



£625,000
Freehold

- Fabulous End of Terrace Family Residence
- Envious Location in Central Southsea
- Short Walk to Shopping Precinct & Seafront
- Over 2,000 sq.ft (189 sq.m) over Four Floors
- Four Double Bedrooms plus Two Bathrooms
- Three Reception Rooms
- 18ft Kitchen/Breakfast Room : Utility Room
- Walled Westerly Garden : Parking for Two Cars



In Brief

Fry & Kent has pleasure in marketing for sale this **FABULOUS** Victorian End of terrace Town House situated in an enviable location within the much requested 'Owens CONSERVATION Area' of Southsea just around the corner from the main shopping precinct at Palmerston Road and the seafront.

The property is **PERFECTLY** located close to excellent private schooling and the many cafes, bars and restaurants associated with this **FASHIONABLE** district. At over 2,000 sq.ft (189 sq.m) over four principle floors, the house provides a bright and **SPACIOUS** layout comprising; reception hall, living room and family room with feature Oak flooring on the ground floor while the lower ground floor features a large dining room and an 18ft kitchen/breakfast room plus separate utility on the half landing. On the upper two floors you will find four **DOUBLE** bedrooms plus two bathrooms. There is also access to the roof via a skylight window in the second bedroom.

Externally, there is block paved off-road parking for two cars and a **WESTERLY** facing two-tier rear garden with pedestrian access gate and shed. **NO CHAIN**. A unique opportunity not to be missed!

£625,000

KEY FACTS

TENURE: Freehold

EPC RATING: 'E'

COUNCIL TAX BAND: 'E'



RICHMOND TERRACE

SOUTHSEA | HAMPSHIRE | PO5 3NE



Richmond Terrace, Southsea

Approximate Gross Internal Area = 188.9 sq m / 2033 sq ft
(Excluding Reduced Headroom / Eaves)
Reduced Headroom = 0.6 sq m / 7 sq ft
Total = 189.5 sq m / 2040 sq ft

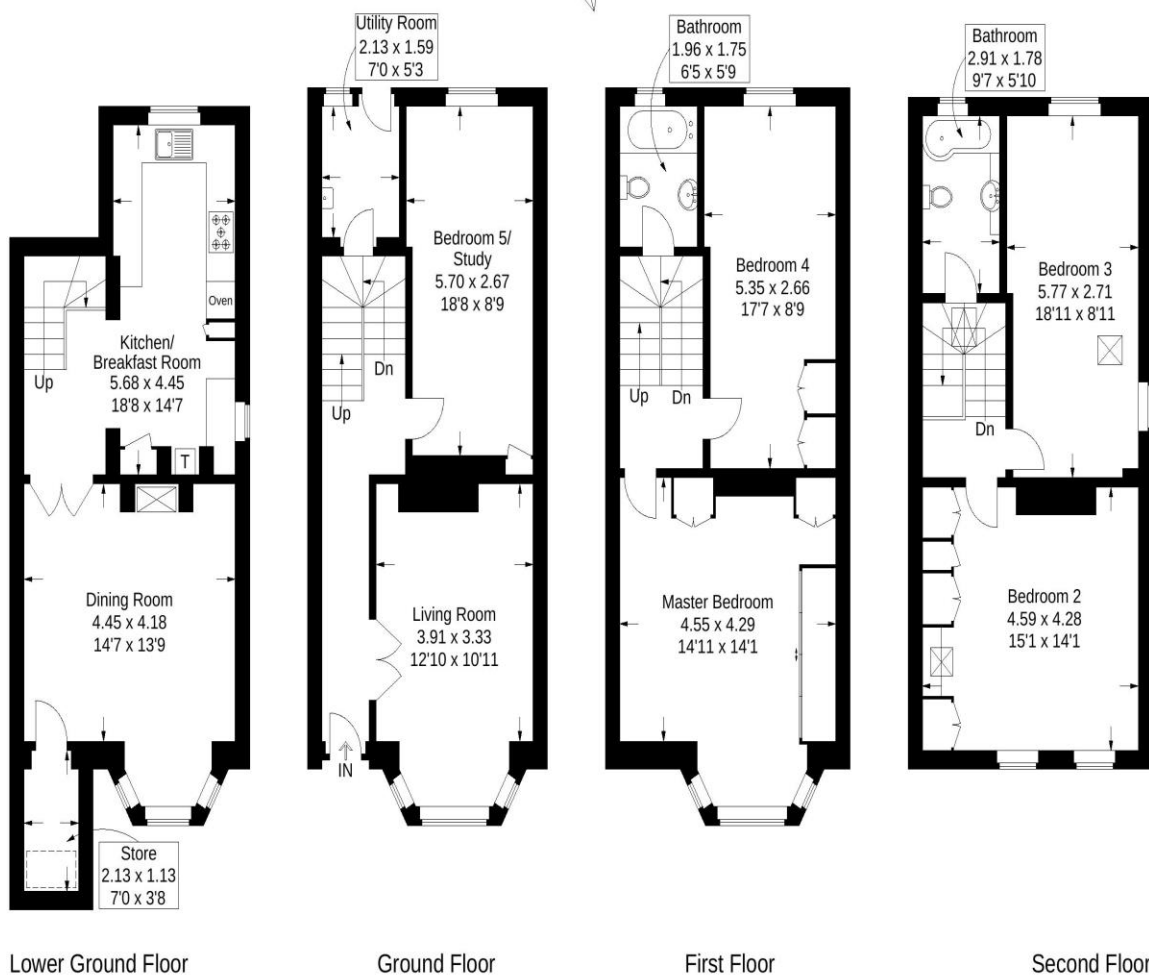

This plan is for layout guidance only. Not drawn to scale unless stated. Windows and door openings are approximate. Whilst every care is taken in the preparation of this plan, please check all dimensions, shapes and compass bearings before making any decisions reliant upon them.

Southsea
Sales & Lettings
7/9 Stanley Street,
Southsea, PO5 2DS
Tel: 023 9281 5221

Old Portsmouth & Gunwharf Quays
Sales & Lettings
The Seagull, 13 Broad Street,
Old Portsmouth, PO1 2JD
Tel: 023 9281 5221

Drayton & Out of Town
Sales & Lettings
139 Havant Road,
Drayton, PO6 2AA
Tel: 023 9221 0101

London
Sales & Lettings
Mayfair Office, Cashel House,
15 Thayer Street, W1U 3JT
Tel: 0870 112 7099

Southsea
Admin Centre
12 Marmion Road,
Southsea, PO5 2BA
Tel: 023 9282 2300

www.fryandkent.com