

JUBILEE ROAD

SOUTHSEA | HAMPSHIRE | PO4 0JE



OFFERS IN EXCESS OF £300,000
Freehold

- Traditional Victorian Family Home
- Highly Requested Road within Central Southsea
- Walking Distance to Southsea Seafront
- Spacious Rear Garden
- Modern Kitchen with Integrated Appliances
- Three Good Sized Bedrooms : Upstairs Bathroom
- Gas Central Heating : Double Glazing Throughout
- Viewing Advised!





In Brief

This delightful Victorian home offers well-designed living space, featuring three bedrooms, one bathroom and a spacious rear garden. The living room is a standout feature, boasting a striking teal accent wall that adds character and warmth. A traditional mantelpiece serves as a focal point. The kitchen is modern and functional, with light wood cabinetry, stainless steel appliances, and a subway tile backsplash. It includes ample counter space and storage, perfect for culinary enthusiasts. The primary bedroom, features a bold blue accent wall and spacious wardrobes. Other bedrooms are thoughtfully designed, complete with charming decor. The bathroom suite is efficiently laid out with a full-sized bathtub, toilet, and sink. Decorative tile accents add visual interest to the white-tiled walls. Outside, a paved patio area offers space for alfresco dining, relaxation and includes a small patch of artificial lawn. Throughout the home, large windows allow natural light to flood the spaces, creating a bright and airy atmosphere. The interior design scheme cleverly combines neutral tones with pops of colour, resulting in a cohesive and inviting living environment.

Offers in Excess of £300,000

KEY FACTS

TENURE: Freehold

EPC RATING: 'D'

COUNCIL TAX BAND: 'B'



JUBILEE ROAD

SOUTHSEA | HAMPSHIRE | PO4 0JE



Jubilee Road, Southsea

Approximate Gross Internal Area = 81.6 sq m / 878 sq ft

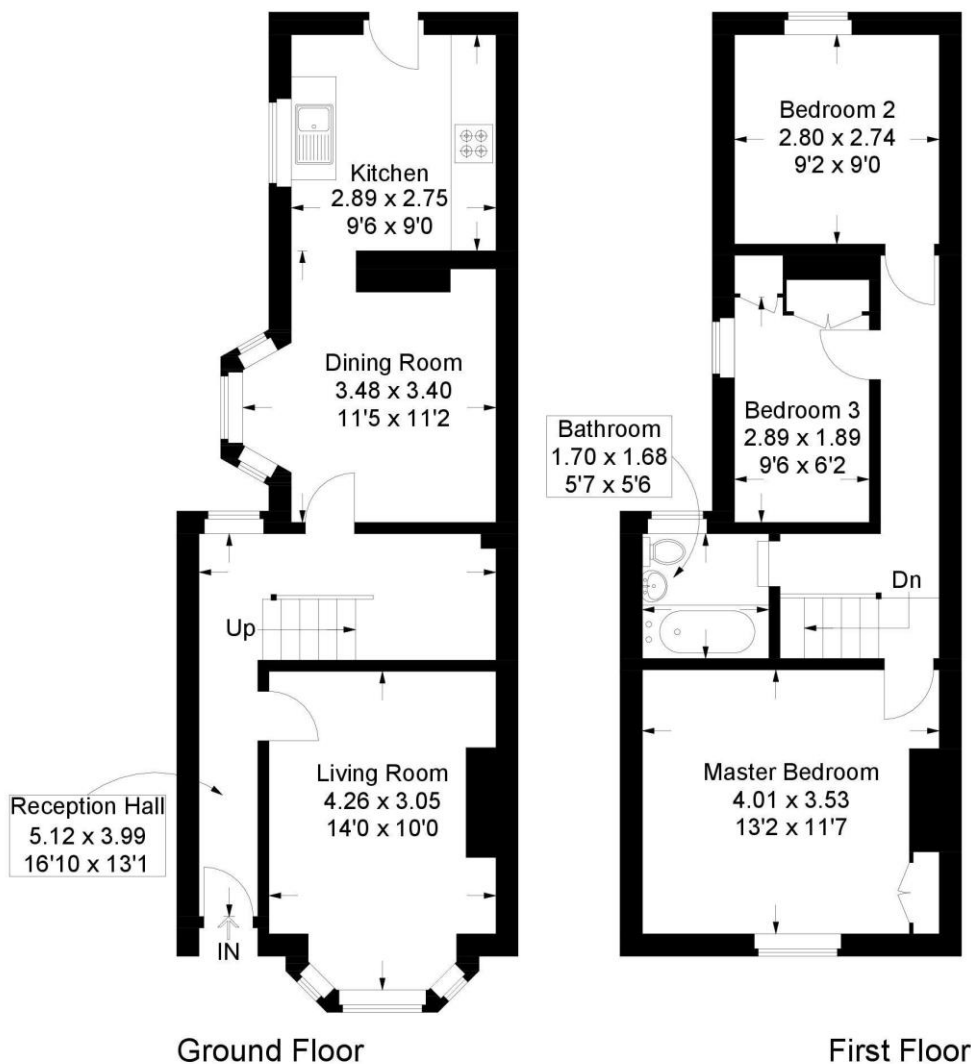

This plan is for layout guidance only. Not drawn to scale unless stated. Windows and door openings are approximate. Whilst every care is taken in the preparation of this plan, please check all dimensions, shapes and compass bearings before making any decisions reliant upon them.

Southsea
Sales & Lettings
7/9 Stanley Street,
Southsea, PO5 2DS
Tel: 023 9281 5221

Old Portsmouth & Gunwharf Quays
Sales & Lettings
The Seagull, 13 Broad Street,
Old Portsmouth, PO1 2JD
Tel: 023 9281 5221

Drayton & Out of Town
Sales & Lettings
139 Havant Road,
Drayton, PO6 2AA
Tel: 023 9221 0101

London
Sales & Lettings
Mayfair Office, Cashel House,
15 Thayer Street, W1U 3JT
Tel: 0870 112 7099

Southsea
Admin Centre
12 Marmion Road,
Southsea, PO5 2BA
Tel: 023 9282 2300

www.fryandkent.com