

# GLOUCESTER VIEW

SOUTHSEA | HAMPSHIRE | PO5 4EB



£499,950  
Freehold

- Grade II Listed End of Terrace Townhouse
- Three Storey Home with Enclosed Garden
- Within the King Street Conservation Area
- Entrance Hall, Living Room & Dining Room
- Feature Open Plan Kitchen Dining Room
- Four Double Bedrooms & Modern Bathroom
- Period Features Throughout inc Fireplaces
- Approx Total Sq Ft = 1334







## In Brief

We are delighted to offer for sale this period Grade II Listed end of terrace townhouse, situated within the King Street Conservation Area of Southsea, being a quiet cul de sac location. This home offers an exciting mix of period features throughout including fireplaces and sash windows, whilst benefitting from a modern and open plan kitchen dining room with unique glass roof to the dining area and a modern bathroom. This home is very conveniently situated close to all local amenities, the seafront and excellent transport links in and out of the City. Internally, the accommodation comprises an entrance hall which leads to the living room and separate dining room, whilst steps lead to the spacious kitchen dining room which opens to the rear garden, plus further steps to the bedrooms, of which there are four double bedrooms in total. The flexible accommodation over three storeys also benefits from a modern four piece bathroom to the first floor mezzanine, complete with a white suite. Externally, there is a enclosed mature rear garden with shrub and tree borders plus a paved patio seating area, providing the perfect space for outside dining and entertaining!

**£499,950**

## KEY FACTS

**TENURE:** Freehold

**EPC RATING:** 'D'

**COUNCIL TAX BAND:** 'E'





# GLOUCESTER VIEW

SOUTHSEA | HAMPSHIRE | PO5 4EB



## Gloucester View, Southsea

Approximate Gross Internal Area  
123.9 sq m / 1334 sq ft

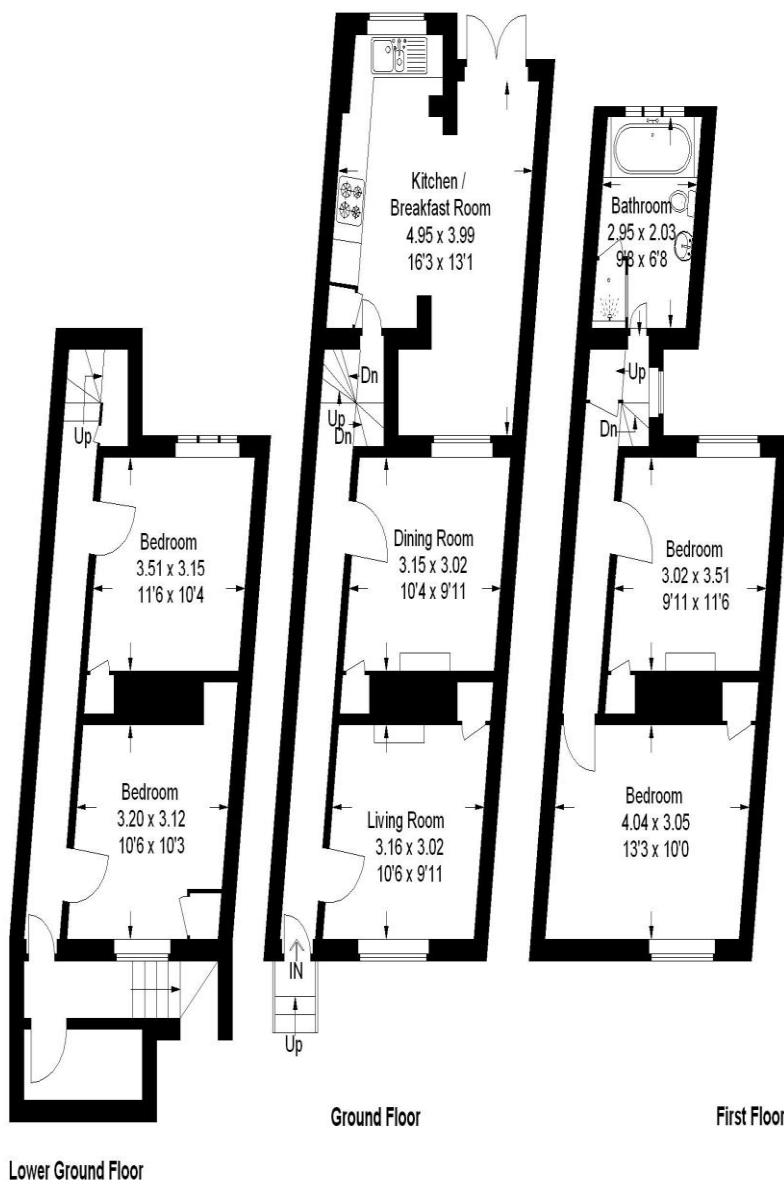

Illustration for identification purposes only, measurements are approximate,  
not to scale. (ID170463)

**Southsea**  
Sales & Lettings  
7/9 Stanley Street,  
Southsea, PO5 2DS  
Tel: 023 9281 5221

**Old Portsmouth & Gunwharf Quays**  
Sales & Lettings  
The Seagull, 13 Broad Street,  
Old Portsmouth, PO1 2JD  
Tel: 023 9281 5221

**Drayton & Out of Town**  
Sales & Lettings  
139 Havant Road,  
Drayton, PO6 2AA  
Tel: 023 9221 0101

**London**  
Sales & Lettings  
Mayfair Office, Cashel House,  
15 Thayer Street, W1U 3JT  
Tel: 0870 112 7099

**Southsea**  
Admin Centre  
12 Marmion Road,  
Southsea, PO5 2BA  
Tel: 023 9282 2300

[www.fryandkent.com](http://www.fryandkent.com)