

5 OYSTER STREET

OLD PORTSMOUTH | HAMPSHIRE | PO1 2HZ



£575,000

Freehold

- Four Bedroom Town House in Fabulous Location
- 27ft Roof Terrace with Cathedral & Sea Views
- Stroll to Waterfront, Spice Island & Gunwharf Quays
- Open Plan Living/Dining Room : Fitted Kitchen
- New Re-Fitted Bathroom with Shower : Cloakroom
- Gas Central Heating & Double Glazing
- Southerly Facing Courtyard Garden
- Large Single Garage : No Forward Chain



In Brief

We have pleasure in marketing for sale this modern Four Bedroom TOWN HOUSE situated in a fabulous residential location within the CONSERVATION city of Old Portsmouth overlooking the Cathedral and just around the corner from the HISTORIC Hotwalls (and beach), Spice Island and a short walk to the MARINA complex of Gunwharf Quays with its many designer outlets, cafes, excellent restaurants and leisure facilities. Featuring a 27ft ROOF TERRACE complete with artificial grass, external lighting and superb views towards The Solent and harbour entrance offers the perfect place for Al Fresco dining and entertaining while the accommodation which spans three floors comprises; 18ft x 11ft open plan living/dining room, fitted kitchen with integrated oven and hob plus cloakroom on the ground floor. The first floor features two DOUBLE bedrooms with stairs leading to the master bedroom, newly fitted family bathroom with separate overbath shower and a fourth bedroom/study with access to the roof terrace. Externally, the enclosed SOUTHERLY facing courtyard garden with door access into the larger than average single GARAGE approached via White Hart Road to the rear. Viewing is strongly recommended to appreciate the location, roof terrace with views and accommodation on offer with no forward chain.

£575,000

KEY FACTS

TENURE: Freehold

EPC RATING: 'D'

COUNCIL TAX BAND: 'E'



5 OYSTER STREET

OLD PORTSMOUTH | HAMPSHIRE | PO1 2HZ



Oyster Street, Old Portsmouth

Approximate Gross Internal Area = 86.9 sq m / 935 sq ft

Outbuilding = 20.4 sq m / 220 sq ft

Total = 107.3 sq m / 1155 sq ft

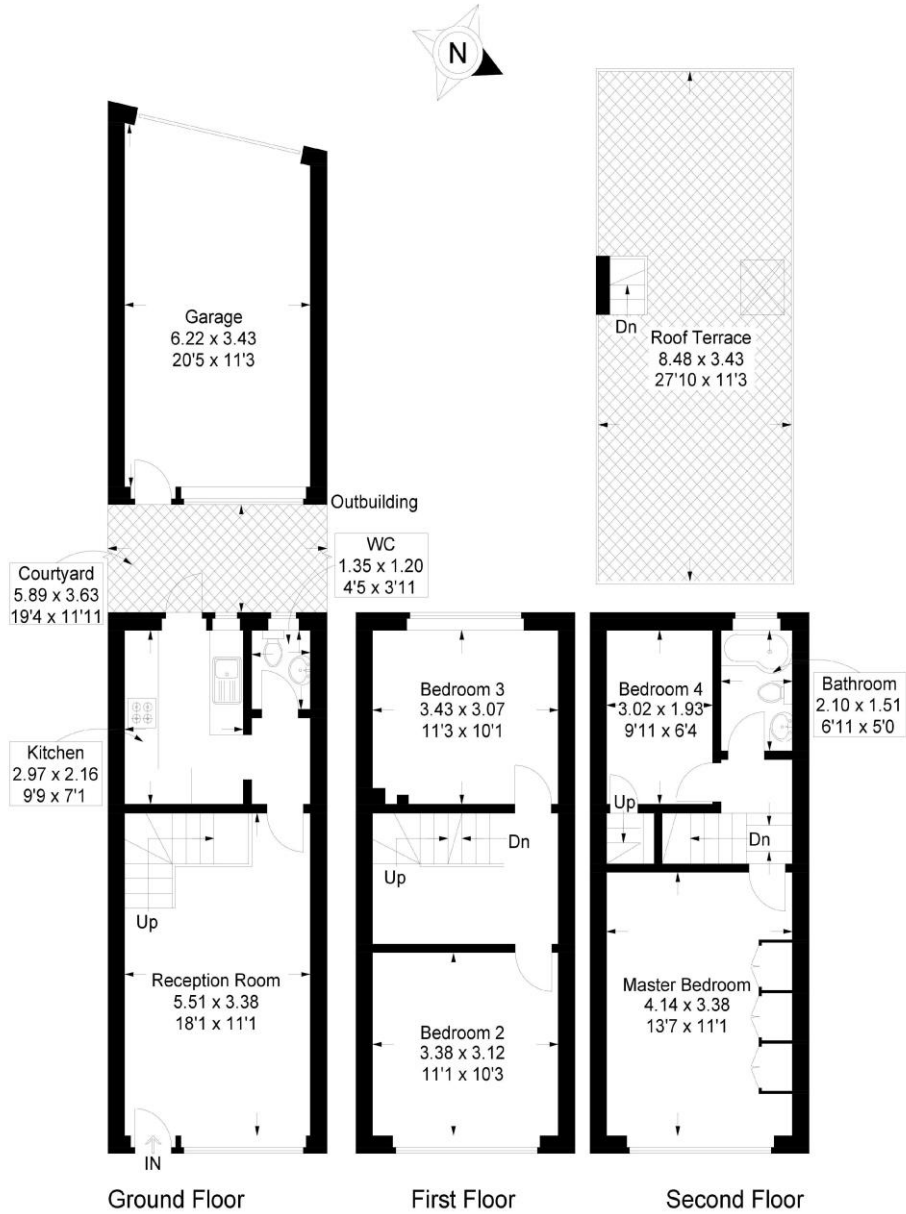

This plan is for layout guidance only. Not drawn to scale unless stated. Windows and door openings are approximate. Whilst every care is taken in the preparation of this plan, please check all dimensions, shapes and compass bearings before making any decisions reliant upon them.

Southsea
Sales & Lettings
7/9 Stanley Street,
Southsea, PO5 2DS
Tel: 023 9281 5221

Old Portsmouth & Gunwharf Quays
Sales & Lettings
The Seagull, 13 Broad Street,
Old Portsmouth, PO1 2JD
Tel: 023 9281 5221

Drayton & Out of Town
Sales & Lettings
139 Havant Road,
Drayton, PO6 2AA
Tel: 023 9221 0101

London
Sales & Lettings
Mayfair Office, Cashel House,
15 Thayer Street, W1U 3JT
Tel: 0870 112 7099

Southsea
Admin Centre
12 Marmion Road,
Southsea, PO5 2BA
Tel: 023 9282 2300

www.fryandkent.com