

Disclaimer: These particulars, whilst believed to be accurate are set out as a general outline only for guidance and do not constitute any part of an offer or contract. Intending purchasers should not rely on them as statements of representation of fact, but must satisfy themselves by inspection or otherwise as to their accuracy. We have not carried out a detailed survey nor tested the services, appliances and specific fittings. Room sizes should not be relied upon for carpets and furnishings. The measurements given are approximate. No person in this firm's employment has the authority to make or give any representation or warranty in respect of the property.

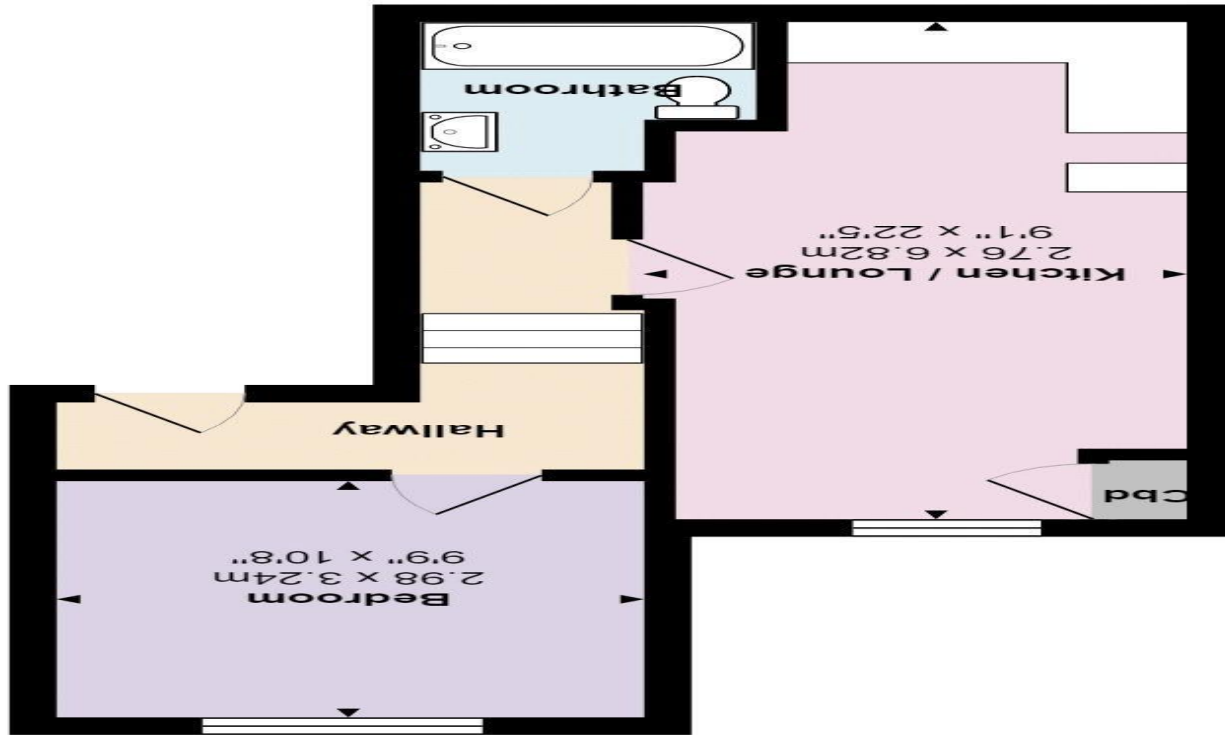

Total Area: 37.6 m² ... 404 ft²
 All measurements are approximate and for display purposes only



Christchurch Road, Bournemouth, Dorset, BH7 6DQ
£795.00 - per month

One Bedroom First floor Flat | UPVC Double Glazing | Well Maintained Block | Convenient Location | Available Now

Discover this charming one-bedroom flat for rent, perfectly positioned on the first floor of a well-maintained block on Pokesdown High Street. Boasting a secure entry phone entrance, a fitted kitchen with an oven, a stylish bathroom, carpets and blinds, UPVC double glazing, and gas central heating. This inviting space is ready to become your new home.

Call for further details.
Available now.

Council Tax Banding: A
EPC Rating: 76 | C

