

Estate Agents



Auctioneers



Christchurch Road, Pokesdown, Bournemouth. BH7 6DF £139,950 Leasehold

Newly Refurbished One Bedroom First Floor Flat
Communal Entrance | Hallway | Open Plan Lounge & Newly Fitted Kitchen
Double Bedroom | Newly Fitted Bathroom | No Chain

Christchurch Road, Pokesdown, Bournemouth. BH7 6DF

£139,950 Leasehold

A newly refurbished one bedroom first floor flat situated in a convenient location in the heart of Pokesdown's bustling high street, close to Pokesdown train station and the AECC Chiropractic University.

The flat features double glazing, gas central heating, a spacious open-plan living room/kitchen area which is newly fitted with modern grey kitchen units including a built-in oven, hob and extractor. There is a spacious double bedroom and modern bathroom which is also newly fitted with a white three piece suite, tiled floor and part tiled walls.

The flat has recently been re-decorated and re-carpeted throughout. No chain - Ideal first time buyer or investment purchase.

Lease: Approx. 83 years remaining
Maintenance: Shared - as and when required
EPC Rating: 67 | D

Ground Rent: £50 per annum
Council Tax Band: B

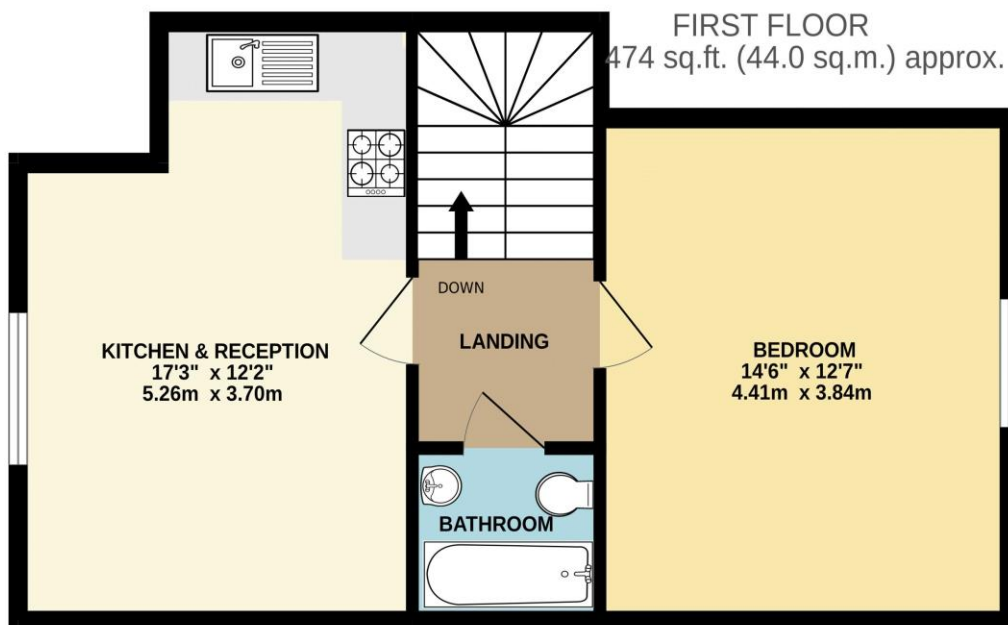

TOTAL FLOOR AREA: 474 sq.ft. (44.0 sq.m.) approx.
Whilst every attempt has been made to ensure the accuracy of the floorplan contained here, measurements of doors, windows, rooms and any other items are approximate and no responsibility is taken for any error, omission or mis-statement. This plan is for illustrative purposes only and should be used as such by any prospective purchaser. The services, systems and appliances shown have not been tested and no guarantee as to their operability or efficiency can be given.
Made with Metropix 62024

These particulars, whilst believed to be accurate are set out as a general outline only for guidance and do not constitute any part of an offer or contract. Intending purchasers should not rely on them as statements of representation of fact, but must satisfy themselves by inspection or otherwise as to their accuracy. We have not carried out a detailed survey nor tested the services, appliances and specific fittings. Room sizes should not be relied upon for carpets and furnishings. The measurements given are approximate. No person in this firm's employment has the authority to make or give any representation or warranty in respect of the property.