



2  1  1 

15 Bayfield Close, Kings Lynn PE30 4YZ

**BELVOIR!**

£165,000





### Key Features

- > MID TERRACED PROPERTY
- > TWO BEDROOMS
- > GAS CENTRAL HEATING
- > UPVC DOUBLE GLAZING
- > GARDEN
- > GARAGE
- > Tenure: Freehold
- > EPC rating C

Belvoir incorporating Munton and Russell offer for sale this modern two bedroom terraced property, situated in this popular residential area of Kings Lynn, walking distance to the Queen Elizabeth Hospital. The property is presented in good order throughout. The accommodation in brief comprises of, entrance hall, re-fitted kitchen, lounge, two bedrooms and re-fitted bathroom. Externally, enclosed rear garden and garage.

### ENTRANCE HALL

Sealed unit double glazed door, radiator.

### KITCHEN

7'1" x 8'6" (2.2m x 2.6m)

UPVC double glazed window to the front elevation, range of re-fitted base and wall units, sink unit with taps over, space for washing machine, built in oven, hob and hood.



## LOUNGE

11'11" x 15'6" (3.6m x 4.7m)

UPVC double glazed window to the rear garden, radiator, stairs to first floor.

## FIRST FLOOR LANDING

Doors to:

### BEDROOM 1

9'10" x 11'1" (3m x 3.4m)

UPVC double glazed window to the rear elevation, fitted wardrobe, radiator.

### BEDROOM 2

5'10" x 12'1" (1.8m x 3.7m)

UPVC double glazed window to the front elevation, radiator.

## BATHROOM

UPVC double glazed window to the front elevation, three-piece suite comprising of WC, wash hand basin, panelled bath, radiator.

## EXTERNALLY

Open plan to front.

Garage with up and over door, off road parking.

REAR: Enclosed by fencing, laid to lawn.

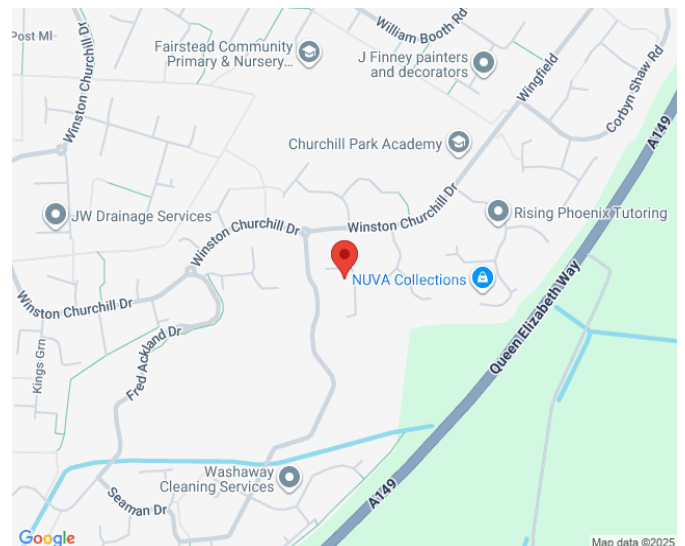
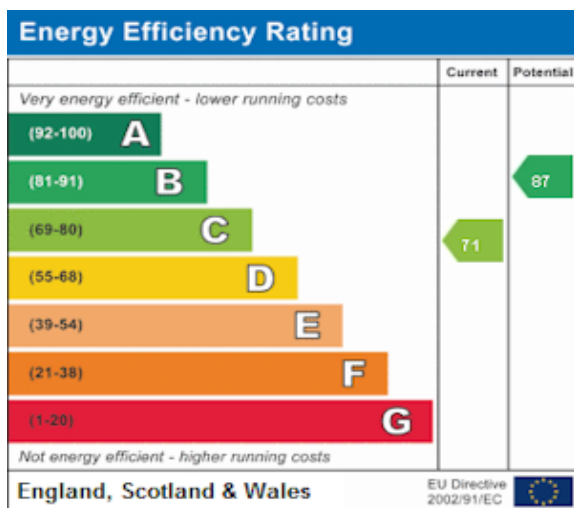
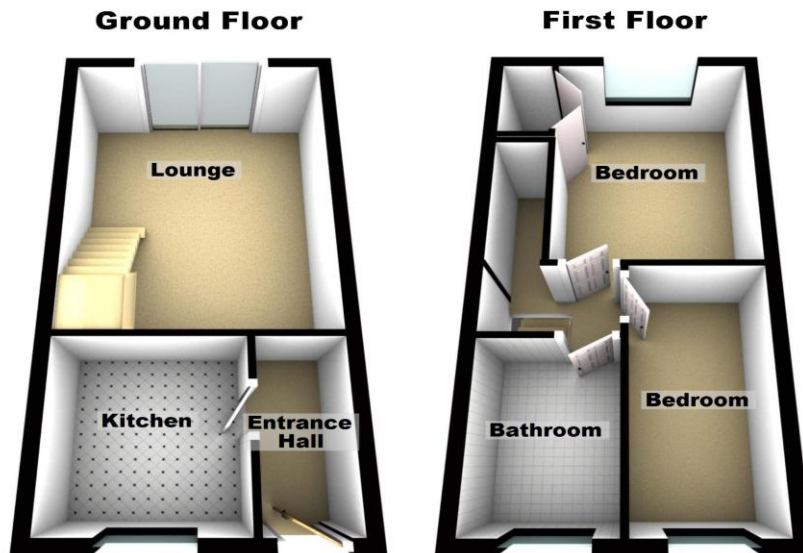

Contact us today to arrange a viewing...

# BELVOIR!

[www.belvoir.co.uk/spalding-estate-agents/](http://www.belvoir.co.uk/spalding-estate-agents/)

01775 722475