



Wooding Grove, Harlow, CM19 4ED

Geoffrey Matthew Estates are pleased to offer this three bedroom, semi-detached, family home in the popular residential area of Wooding Grove. In need of a degree in modernisation throughout, the property is ideally located for access to the Town Centre and Princess Alexandra Hospital, as well as other local schooling and amenities. Scope to extend & add driveway (subject to planning) mean this could make an ideal long term family home.

This one is likely to prove popular, so early viewings are highly recommended!.

Price Guide £375,000

Wooding Grove, Harlow, CM19 4ED



- Three Bedrooms
- Semi-Detached
- Scope To Extend & Add Driveway (Subject To Planning)
- Ideal Location For Town Centre & Princess Alexandra Hospital

Entrance Hall

9'6 x 9'8 (2.90m x 2.95m)

Lounge

19'7 x 9'9 (5.97m x 2.97m)

Kitchen

9'8 x 11'2 (2.95m x 3.40m)

First Floor Landing

Bedroom

10'3 x 11'2 (3.12m x 3.40m)

Bedroom

9' x 13'6 (2.74m x 4.11m)

Bedroom

10'9 x 6'7 (3.28m x 2.01m)

Bathroom

5'6 x 7'7 (1.68m x 2.31m)

Outbuilding

Agents Note

This property was built in the mid 1950's and is of "No Fines" construction.



Directions



Floor Plan

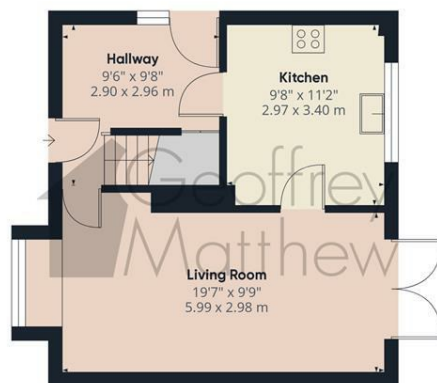

Floor 0

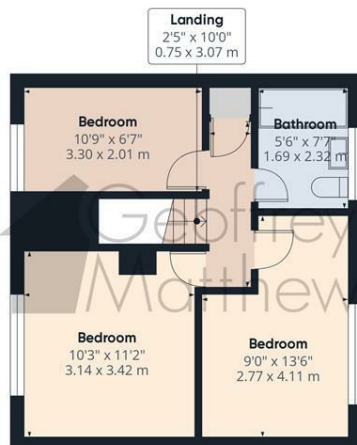

Floor 1



Geoffrey
Matthew

Approximate total area^m
782.09 ft²
72.66 m²

(1) Excluding balconies and terraces

While every attempt has been made to ensure accuracy, all measurements are approximate, not to scale. This floor plan is for illustrative purposes only.

Calculations were based on RICS IPMS 3C standard. Please note that calculations were adjusted by a third party and therefore may not comply with RICS IPMS 3C.

GIRAFFE360

Council Tax Details

Harlow Band C

These particulars, whilst believed to be accurate are set out as a general outline only for guidance and do not constitute any part of an offer or contract. Intending purchasers should not rely on them as statements of representation of fact, but must satisfy themselves by inspection or otherwise as to their accuracy. No person in this firm's employment has the authority to make or give any representation or warranty in respect of the property.

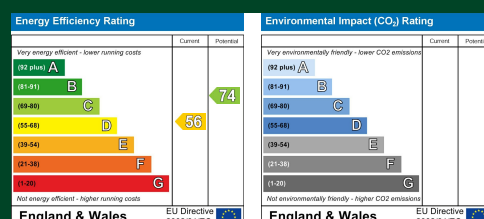

Old Harlow: 01279 444988 Email: harlow@geoffreymatthew.co.uk
Great Ashby: 01438 740111 Email: greatashby@geoffreymatthew.co.uk