



Arkwrights, Harlow, CM20 3NA

Located in The Stow area a popular well established part of town with good local shopping facilities and schooling. The property itself enjoys three good sized bedrooms, front to back living room, fitted kitchen and dining area. Family bathroom to the first floor. A good sized rear garden backing onto woodland giving an unoverlooked rear aspect. To the front the property has a hardstanding with the potential (subject to planning permission) to drop the kerb and make a driveway.

Price £355,000

Arkwrights, Harlow, CM20 3NA



- Three Bedroom Family Home
- Located in the popular Stow Area
- Unoverlooked Rear Aspect Backing onto Woodland
- Potential to Drop the Front Kerb (Subject To Planning)
- Large Front to Back Lounge
- Kitchen with Separate Dining Area
- Gas Radiator Central Heating
- Local Shopping Centre Within Walking Distance
- First Floor Bathroom

Accommodation Comprises:

Hallway

2'7 x 6'7 (0.79m x 2.01m)

Lounge

20'9 x 10'10 (6.32m x 3.30m)

Dining Room

7'5 x 6'4 (2.26m x 1.93m)

Kitchen

9'8 x 9'5 (2.95m x 2.87m)

First Floor Landing

2'9 x 9'9 (0.84m x 2.97m)

Bedroom

10'6 x 10'11 (3.20m x 3.33m)

Bedroom

12'2 x 6'5 (3.71m x 1.96m)

Bedroom

10'2 x 11'2 (3.10m x 3.40m)

Bathroom

5'2 x 9'5 (1.57m x 2.87m)

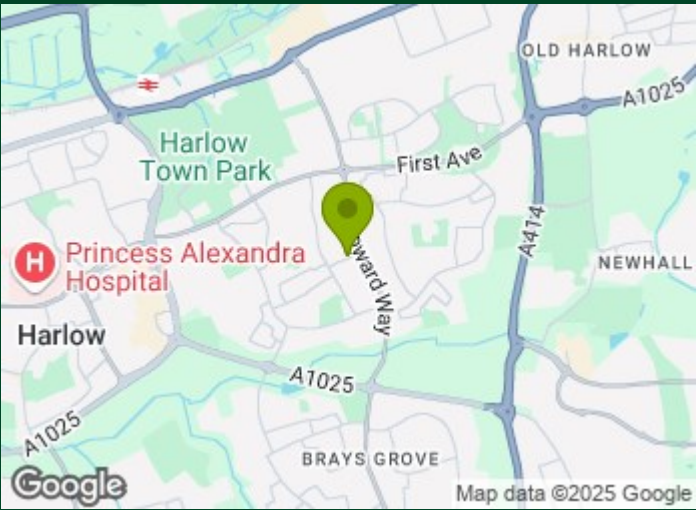

Directions

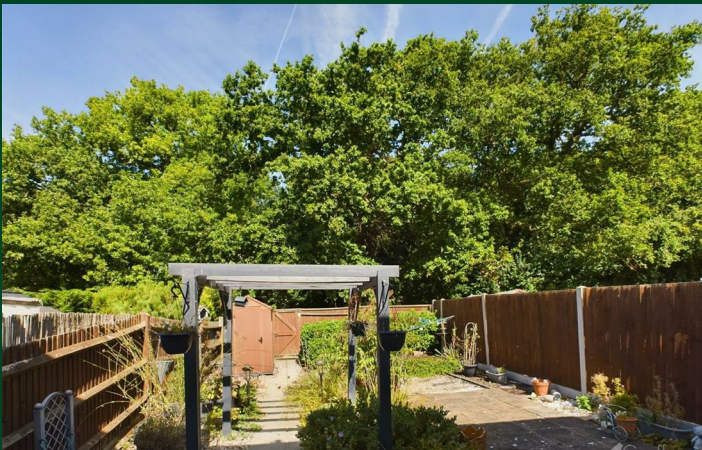

Floor Plan

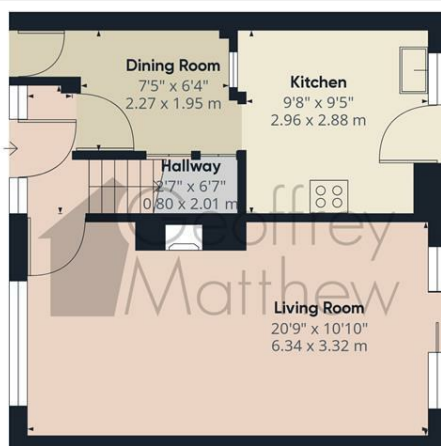

Floor 0

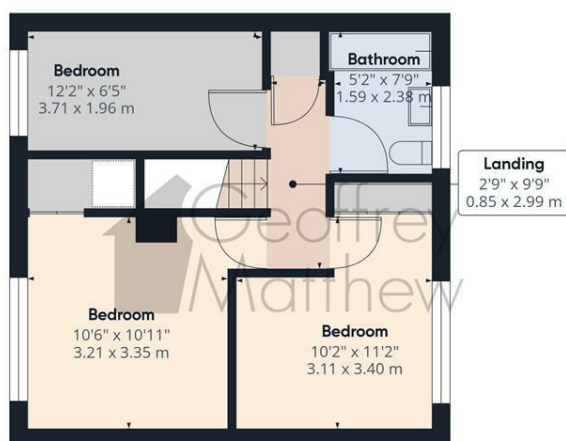

Floor 1



Approximate total area^(a)
803.85 ft²
74.68 m²

(1) Excluding balconies and terraces

While every attempt has been made to ensure accuracy, all measurements are approximate, not to scale. This floor plan is for illustrative purposes only.

Calculations are based on RICS IPMS 3C standard

GIRAFFE360

Council Tax Details

Harlow Council Band C

These particulars, whilst believed to be accurate are set out as a general outline only for guidance and do not constitute any part of an offer or contract. Intending purchasers should not rely on them as statements of representation of fact, but must satisfy themselves by inspection or otherwise as to their accuracy. No person in this firm's employment has the authority to make or give any representation or warranty in respect of the property.

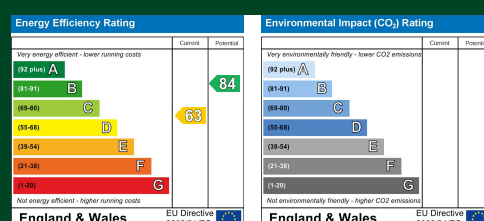

Old Harlow: 01279 444988 Email: harlow@geoffreymatthew.co.uk
Great Ashby: 01438 740111 Email: greatashby@geoffreymatthew.co.uk