

## Old Oak Way, Gilden Park, Old Harlow, CM17 0GD

Geoffrey Matthew Estates are pleased to offer in this popular new development of Old Oak Way, Gilden Park, Old Harlow an immaculately presented one double bedroom first floor apartment in this stylish looking building on the front of the development. It is within easy reach of Harlow Mill station, adjacent to Churchgate Street, local schools, shops and a good selection of pubs and restaurants.

Inside this stunningly presented apartment offers a large entrance hallway with storage cupboard, stylish wood laminate flooring, doors leading to accommodation. Open plan kitchen/diner/living room, glazed windows, and doors to the full width balcony. Fitted bathroom suite, double bedroom with wall to wall fitted wardrobes. The property also has allocated parking.

**Price £235,000**

# Old Oak Way, Gilden Park, Old Harlow, CM17 0GD



- Popular New Development of Gilden Park
- Perfect for First Time Buyers/Investment Opportunity
- 994 year Lease
- Immaculately Presented One Double First Floor Bedroom Apartment
- Adjacent to Churchgate Street and Close to Old Harlow
- Full Width Balcony & Allocated Parking
- Harlow Mill Station Nearby & M11 Junction 7a
- Built Approximately 5 Years Ago
- Call Now for Immediate Viewing

## Accommodation Comprises:

### Hallway

3'6 x 10'7 (1.07m x 3.23m)

### Kitchen/Living Area/Living Room

12'7 x 21'6 (3.84m x 6.55m)

### Balcony

4'2 x 16'7 (1.27m x 5.05m)

### Bedroom

10'8 x 9'9 (3.25m x 2.97m)

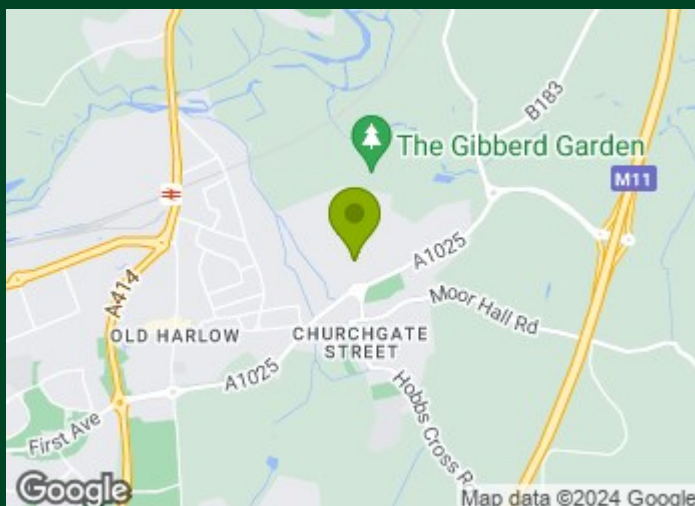

## Directions



# Floor Plan

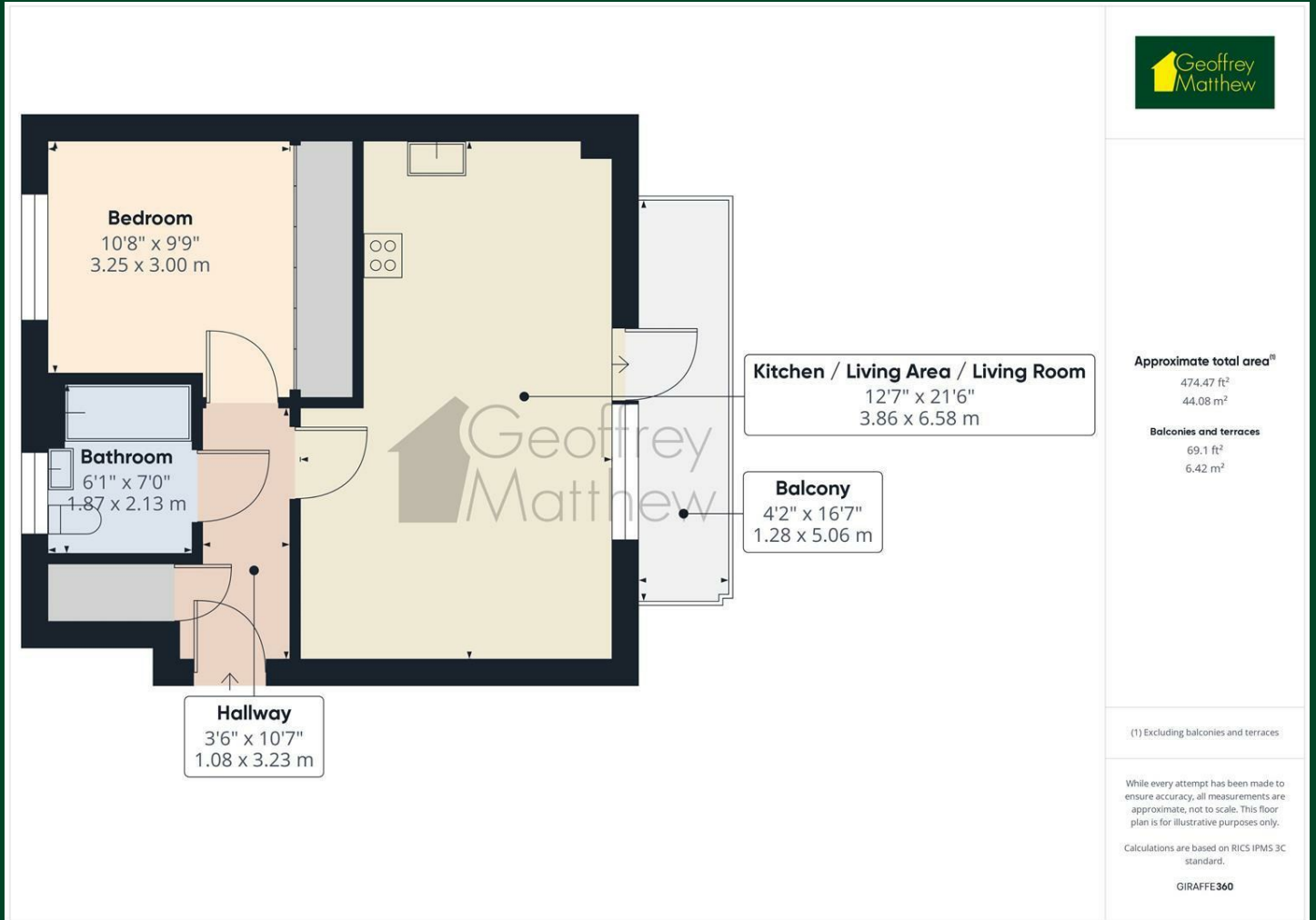

## Council Tax Details

Harlow Council Band B

These particulars, whilst believed to be accurate are set out as a general outline only for guidance and do not constitute any part of an offer or contract. Intending purchasers should not rely on them as statements of representation of fact, but must satisfy themselves by inspection or otherwise as to their accuracy. No person in this firm's employment has the authority to make or give any representation or warranty in respect of the property.

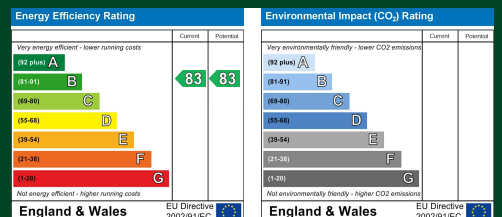

Old Harlow: 01279 444988 Email: harlow@geoffreymatthew.co.uk  
Great Ashby: 01438 740111 Email: greatashby@geoffreymatthew.co.uk